

STAINLESS STEEL CASEWORK & SPECIMEN SHELVING

Casework Specifications	2
Standing Height	3-5
Counter-top/Sink Layouts	6
Wall Cabinets, 14" Deep	7-8
Wall Cabinets, 16" Deep	9-10
Tall Storage Cabinets	11-12
Specialty Cabinets	12
Stainless Steel Shelving & folding Table	13
Tables, Aprons, Drawers Sections and Supports.....	14
Laboratory Workstations.....	15-16
Custom Mobile Work Table & Cabinets.....	17

Ventilated Storage Base Cabinets	18
Ventilated Storage Cabinets	19-20
Ventilated Tissue Storage Cabinets	21
High Density Mobile Shelving	22-23

SPECIMEN SHELVING

Adjustable Wire Shelving	24
Wall Mounted Wire Shelving	25
Adjustable Solid Shelving.....	26
Security Shelving	27
Side Wall Protectors and Corner Guards	28



CABINETS

Each cabinet is fabricated of 18 gauge prime quality Type 304 stainless steel with a No. 4 satin finish. The joints on the face are a flush butt joint and heliarc welded. Welds are then ground and polished to match all exposed surfaces equal to a No.4 finish. Corners are reinforced with angles or welded as required. Service access panels are removable with tools and are provided in the back of base cupboard cabinets. Each cabinet is fabricated with a 3.5 in./8 cm. high by 3 in./7 cm. deep toe space. As an optional feature, end bottom corners are fitted with a 14 gauge gusset and adjustment bolt. Both sides of all cabinets are finished.



DOORS

Hinged doors are 1 in./2.5 cm. thick with a double pan construction. Door hinges are secured by welds.

Sliding doors shall be constructed similar to the hinged door without hinge reinforcements. Each sliding door is fitted with two grooved nylon sheaves to ride on an stainless steel track which is set in the bottom of the case. The top of each door has two nylon guides, to prevent metal to metal contact. Rubber bumpers and stops are supplied with all doors.

Glazed doors shall be similar to the metal doors with vertical and horizontal stiles (2 in./5 cm. in width). The doors shall be glazed with 6mm (7/32") thick clear glass set in with rubber cushion strips or plastic guides. Glass is replaceable by removing the glass retainer frame from inside the door. Frameless glass doors are constructed of tempered glass.

DRAWERS

Drawer bodies are formed of 18 gauge stainless steel with a fully covered bottom and a reinforcing hem on the top edges. Drawers have integral stops to prevent accidental withdrawal but may be removed without the use of tools. Drawers are equipped with full extension, ball bearing suspensions, with a capacity load of 100 lbs./45 kg. per drawer. This full extension allows the entire contents to be accessed and provides for a smooth and silent operation.

HARDWARE

All exposed hardware is brushed stainless steel. Hinges are .093 in./2 cm. thick stainless steel Laboratory/Hospital type. Hinges are warranted to provide a minimum of 500,000 door openings without appreciable wear. Hinges are welded to doors and frames. Doors over 42 in./106 cm. high have three or more hinges as required. All doors are provided with ball catch assembly for closing. Pulls are available in two styles, a satin chrome plated extended handle or a bar pull with a satin finish. Both are mounted to the inside head with mounting screws on 4 in./10 cm. centers. When doors are supplied with a lock, the lock will be a removable core for enhanced security and quick rekeying. In cases of double doors, the left door will be fitted with an astragal.

CABINET SHELVES

Shelves have front ends flanged down 1 in./2 cm. with an additional .5 in./1.2 cm. flange for strength. the flanges at the sides and back are turned up at an angle to establish firm contact with the side walls. All shelves are supported on stainless steel shelf clips, adjustable on .5 in./1.2 cm.

COUNTERTOP CONSTRUCTION

Stainless steel counters are formed and have a thickness of 1.25 in./3 cm. Counters are adjacent to walls and come with back splashes that are a standard 4 in./10 cm. high. Back splashes can be higher upon request. Integral end are optional. The underside of counters are reinforced with stainless steel channels and has a sound deadening material applied. Stainless steel counters are uniformly polished after all fabrication. The resulting finish is uniform and equivalent to a No.4 satin mill finish. Stainless steel sink tops have a raised, no-drip front marine edge.

STAINLESS STEEL SINKS

Stainless steel sink bowls are formed and welded from sheet steel to provide a seamless construction. Internal corners are rounded to a 0.5 in./1.2 cm. radius and the bottom is punched and formed to receive a strainer and is pitched slightly to insure complete draining. Sinks are welded into counter tops and ground smooth, providing a water-tight joint.

MINIMUM GAUGE REQUIREMENTS

Cabinet top	18 gauge
Cabinet sides, back, bottom	18 gauge
Cabinet finish back panels	18 gauge
Door and drawer outer pans	18 gauge
Door and drawer inner pans	18 gauge
Drawer body	18 gauge
Counter top, back-splash,	
sink bowl.....	14 gauge
Shelves, sloped tops	14 gauge
Table frames, legs.....	18 gauge

All measurements in inches/*centimeters*
Last two digits of order number indicate cabinet width

CASEWORK & SPECIMEN SHELVING

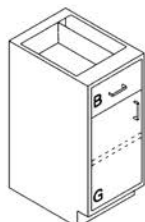

SC119-18, 24

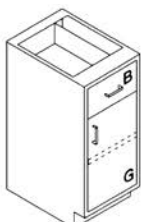

SC118-18, 24



SC133-18, 24

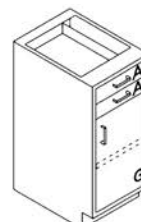

SC132-18, 24

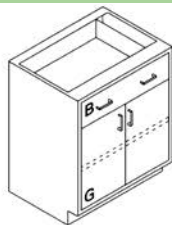

SC105-30, 36, 42, 48

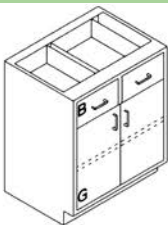

SC106-30, 36, 42, 48

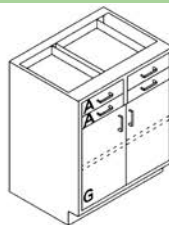

SC108-30, 36, 42, 48

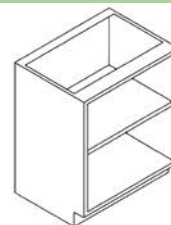

SC101-18, 24, 30, 36, 42, 48

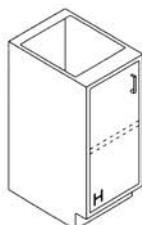

SC196-18, 24

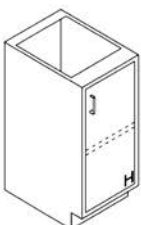

SC195-18, 24



SC103-30, 36, 42, 48

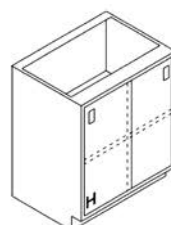

SC100-30, 36, 42, 48

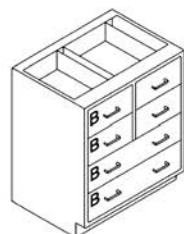

SC138-30, 36, 42, 48



SC139-30, 36, 42, 48

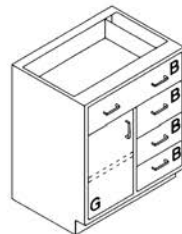

SC148-30, 36, 42, 48

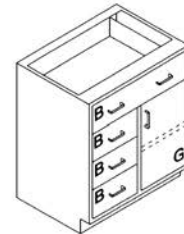

SC117-30, 36, 42, 48

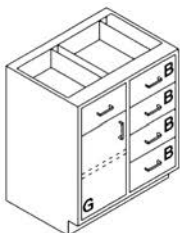

SC136-30, 36, 42, 48

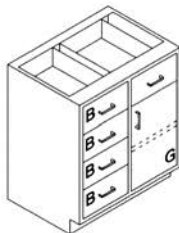

SC113-30, 36, 42, 48

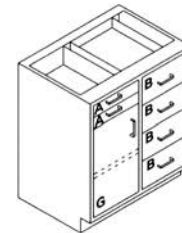

SC140-30, 36, 42, 48

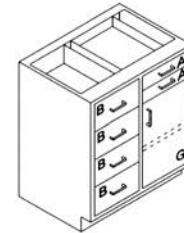

SC114-30, 36, 42, 48

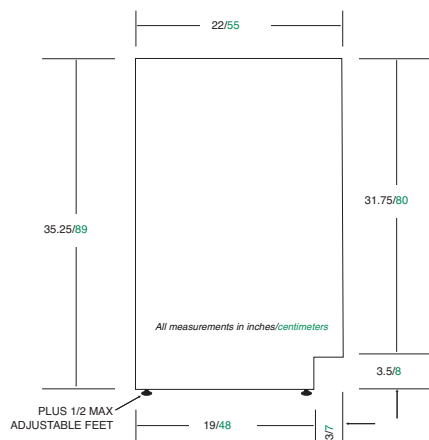

Drawer and Door Heights

Drawer Letter	Approx. Height	Door Letter	Approx. Height
A	3.5 in./8 cm.	G	22 in./55 cm.
B	7 in./17 cm.	H	29 in./73 cm.
C	10.5 in./26 cm.		
D	14.5 in./36 cm.		

All measurements are in inches/*centimeters*
Refer to diagrams for handle positioning

BASE CABINETS STANDING HEIGHT
35-1/4" HIGH X 22" DEEP

CASEWORK & SPECIMEN SHELVING

All measurements in inches/centimeters
Last two digits of order number indicate cabinet width

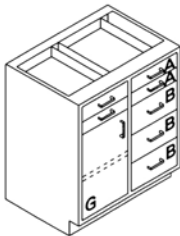

SC147-30, 36, 42, 48

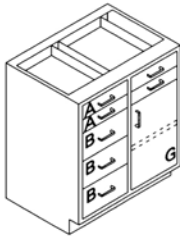

SC115-30, 36, 42, 48

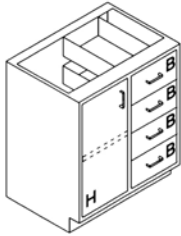

SC116-30, 36, 42, 48

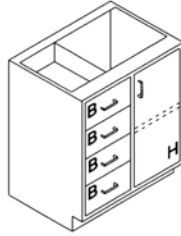

SC110-30, 36, 42, 48

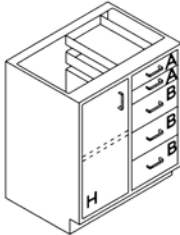

SC120-30, 36, 42, 48

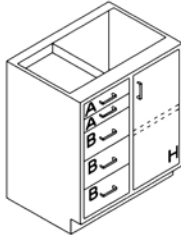

SC111-30, 36, 42, 48

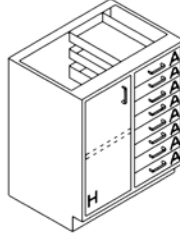

SC135-30, 36, 42, 48

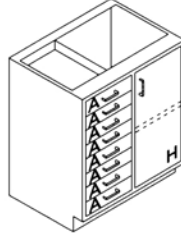

SC112-30, 36, 42, 48

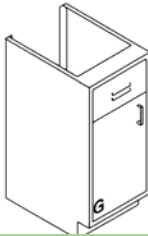

SC194-18, 24



SC193-18, 24

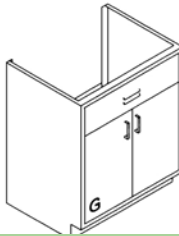

SC181-18, 24, 30, 36



SC182-42, 48

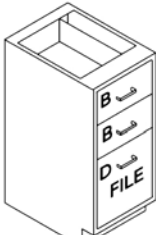

SC125-18

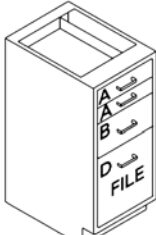

SC126-18

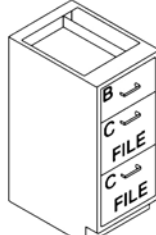

SC199-18

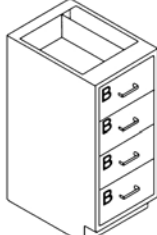

SC122-18, 24

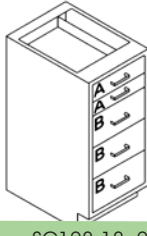

SC128-18, 24



SC131-18, 24

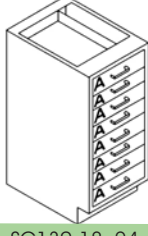

SC130-18, 24

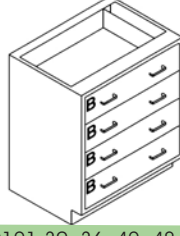

SC121-30, 36, 42, 48



SC128-30, 36, 42, 48

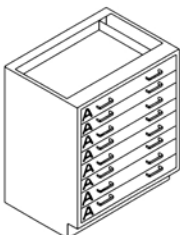

SC131-30, 36, 42, 48



SC124-30, 36, 42, 48

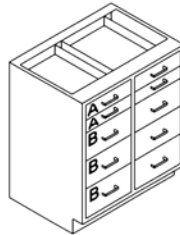

SC129-30, 36, 42, 48

BASE CABINETS STANDING HEIGHT 35-1/4" HIGH X 22" DEEP

Corner Angle Base Cabinets

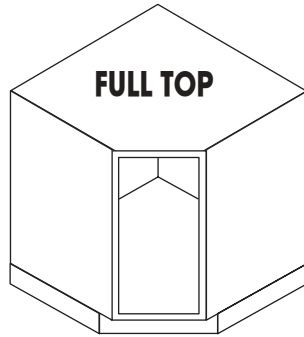
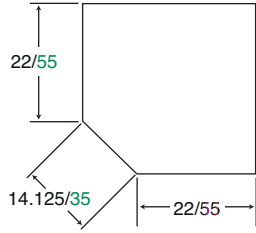

(Open Face)
SC197-32

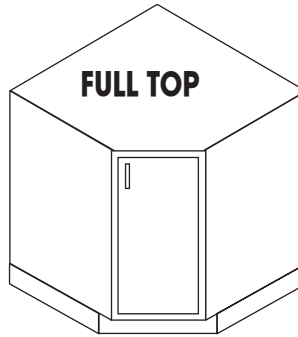
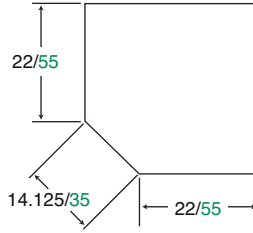

(R.H.) Door Swing Only
SC190-32

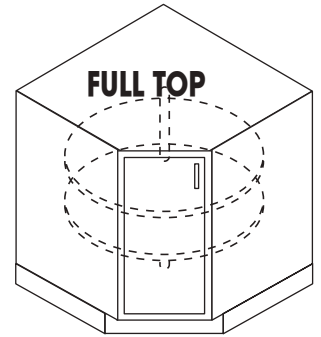
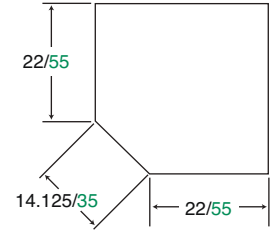

(L.H. Door Swing Only)
SC191-32

Dead Corner Base Cabinets

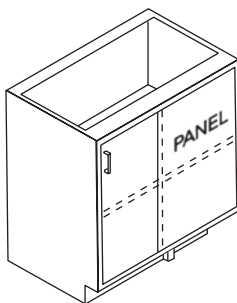
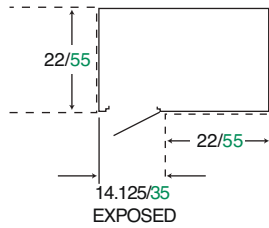

(R.H.) Door Swing
SC192-36

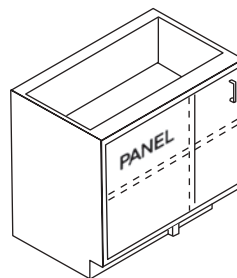
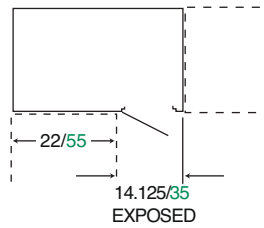

(L.H.) Door Swing
SC198-36

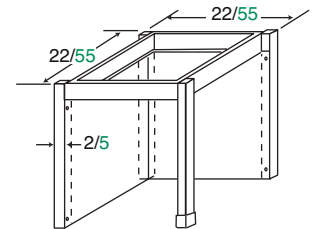

All measurements in inches/centimeters



**BASE CABINETS STANDING HEIGHT
35-1/4" HIGH X 22" DEEP**

GENERAL INFORMATION

HOW TO ORDER

EXAMPLE

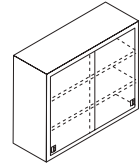
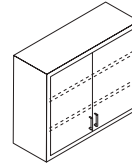
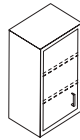
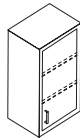
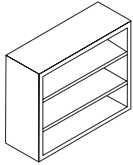

• Open Front Unit	• Swing Door Unit • Hinged Solid Doors	• Swing Door Unit • Hinged Solid Doors	• Swing Door Unit • Hinged Solid Doors	• Sliding Door Unit • Flush Pulls • Solid Door Panels
Wall Hung Cabinets - 18 in./45 cm. High without Shelf				
SC268-18, 24, 30, 36, 42, 48	SC260-18, 24	SC261-18, 24	SC262-30, 36, 42, 48	SC266-30, 36, 42, 48
Wall Hung Cabinets - 24.5 in./62 cm. High with (1) Shelf				
SC228-18, 24, 30, 36, 42, 48	SC221-18, 24	SC222-18, 24	SC220-30, 36, 42, 48	SC226-30, 36, 42, 48
Wall Hung Cabinets - 30 in./76 cm. High with (2) Shelves				
SC201-18, 24, 30, 36, 42, 48	SC217-18, 24	SC218-18, 24	SC203-30, 36, 42, 48	SC205-30, 36, 42, 48
Wall Hung Cabinets - 36 in./91 cm. High with (2) Shelves				
SC238-18, 24, 30, 36, 42, 48	SC230-18, 24	SC231-18, 24	SC232-30, 36, 42, 48	SC236-30, 36, 42, 48
Wall Hung Cabinets - 42 in./106 cm. High with (2) Shelves				
SC248-18, 24, 30, 36, 42, 48	SC240-18, 24	SC241-18, 24	SC242-30, 36, 42, 48	SC246-30, 36, 42, 48
Wall Hung Cabinets - 48 in./115 cm. High with (3) Shelves				
SC258-18, 24, 30, 36, 42, 48	SC250-18, 24	SC251-18, 24	SC252-30, 36, 42, 48	SC256-30, 36, 42, 48

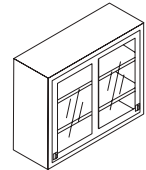
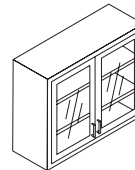
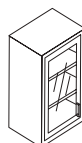
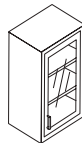
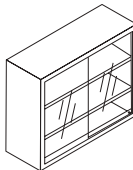

• Sliding Door Unit • Frameless Glass Doors • 25 in./1 cm. • Clear Glass	• Swing Door Unit • Hinged Glass Doors • 25 in./1 cm. • Clear Glass	• Swing Door Unit • Hinged Glass Doors • 25 in./1 cm. • Clear Glass	• Swing Door Unit • Hinged Glass Doors • 25 in./1 cm. • Clear Glass	• Sliding Door Unit • Flush Pulls • 25 in./1 cm. • Clear Glass
Wall Hung Cabinets - 18 in./45 cm. High without Shelf				
SC267-30, 36, 42, 48	SC263-18, 24	SC264-18, 24	SC265-30, 36, 42, 48	SC269-30, 36, 42, 48
Wall Hung Cabinets - 24.5 in./62 cm. High with (1) Shelf				
SC227-30, 36, 42, 48	SC223-18, 24	SC224-18, 24	SC225-30, 36, 42, 48	SC229-30, 36, 42, 48
Wall Hung Cabinets - 30 in./76 cm. High with (2) Shelves				
SC219-30, 36, 42, 48	SC210-18, 24	SC211-18, 24	SC206-30, 36, 42, 48	SC208-30, 36, 42, 48
Wall Hung Cabinets - 36 in./91 cm. High with (2) Shelves				
SC237-30, 36, 42, 48	SC233-18, 24	SC234-18, 24	SC235-30, 36, 42, 48	SC239-30, 36, 42, 48
Wall Hung Cabinets - 42 in./106 cm. High with (2) Shelves				
SC247-30, 36, 42, 48	SC243-18, 24	SC244-18, 24	SC245-30, 36, 42, 48	SC249-30, 36, 42, 48
Wall Hung Cabinets - 48 in./115 cm. High with (3) Shelves				
SC257-30, 36, 42, 48	SC253-18, 24	SC254-18, 24	SC255-30, 36, 42, 48	SC259-30, 36, 42, 48

WALL CABINETS 14" DEEP

CASEWORK & SPECIMEN SHELVING

All measurements in inches/centimeters
Last two digits of order number indicate cabinet width

Dead Corner Wall Cabinets - 14 in./35 cm. Deep
All units are 32 in./81 cm. wide.

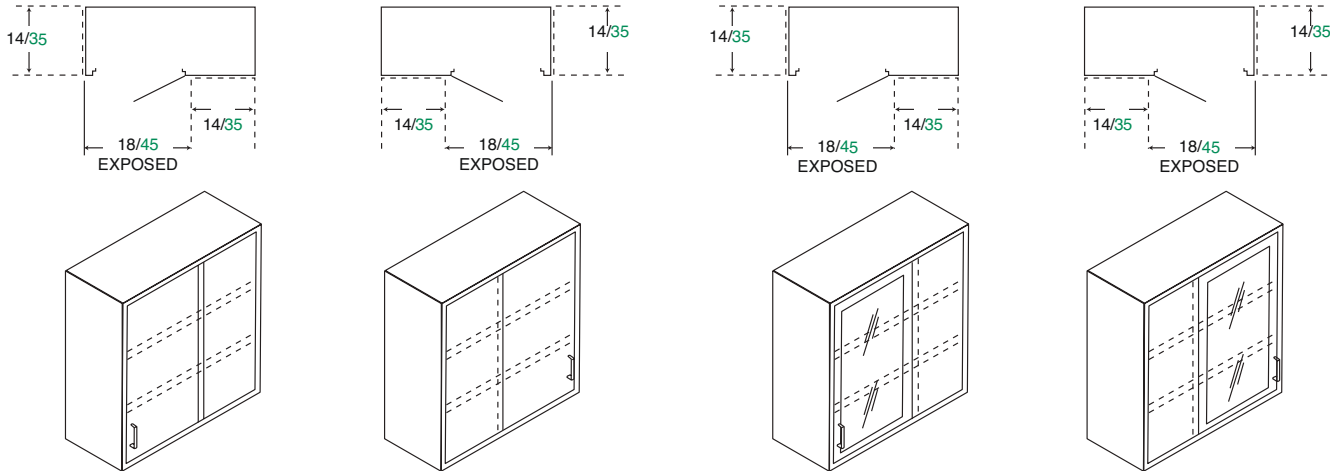

Dead Corner Solid Door • R.H. Door Swing	Dead Corner Solid Door • L.H. Door Swing	Dead Corner Glass Door • .25 in./1 cm. Clear Glass • R.H. Door Swing	Dead Corner Glass Door • .25 in./1 cm. Clear Glass • L.H. Door Swing
SC282-32 24.5 in./62 cm. H	SC286-32 24.5 in./62 cm. H	SC290-32 24.5 in./62 cm. H	SC294-32 24.5 in./62 cm. H
SC283-32 30 in./76 cm. H	SC287-32 30 in./76 cm. H	SC291-32 30 in./76 cm. H	SC295-32 30 in./76 cm. H
SC284-32 36 in./91 cm. H	SC288-32 36 in./91 cm. H	SC292-32 36 in./91 cm. H	SC296-32 36 in./91 cm. H
SC285-32 48 in./121 cm. H	SC289-32 48 in./121 cm. H	SC293-32 48 in./121 cm. H	SC297-32 48 in./121 cm. H

Corner Wall Cabinets - 14 in./35 cm. Deep
All units are 25 in./63 cm. wide.

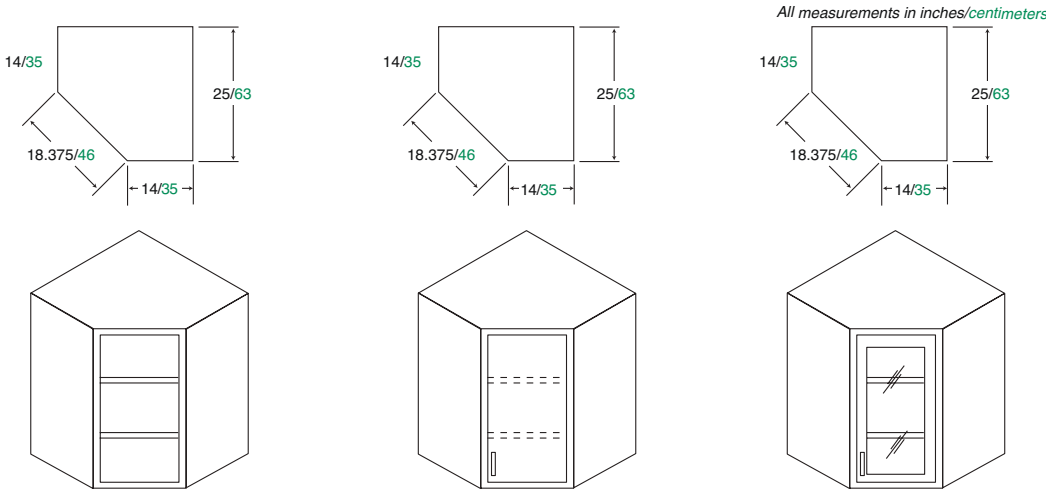

Corner Angle Open Front	Corner Angle Solid Door • R.H. Door Swing	• .25 in./1 cm. Clear Glass • R.H. Door Swing
SC270-25 24.5 in./62 cm. H	SC274-25 24.5 in./62 cm. H	SC278-25 24.5 in./62 cm. H
SC271-25 30 in./76 cm. H	SC275-25 30 in./76 cm. H	SC279-25 30 in./76 cm. H
SC272-25 36 in./91 cm. H	SC276-25 36 in./91 cm. H	SC280-25 36 in./91 cm. H
SC273-25 48 in./121 cm. H	SC277-25 48 in./121 cm. H	SC281-25 48 in./121 cm. H

WALL CABINETS
14" DEEP

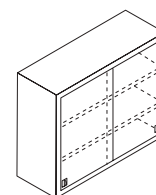
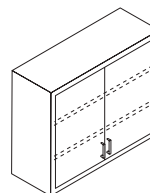
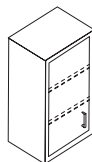
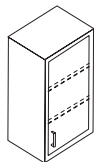
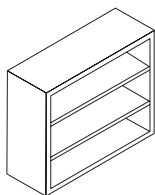

• Open Front Unit	• Swing Door Unit • Hinged Solid Doors	• Swing Door Unit • Hinged Solid Doors	• Swing Door Unit • Hinged Solid Doors	• Sliding Door Unit • Flush Pulls • Solid Door Panels
Wall Hung Cabinets - 18 in./45 cm. High without Shelf				
SC268-16-18, 24, 30, 36, 42, 48	SC260-16-18, 24	SC261-16-18, 24	SC262-16-30, 36, 42, 48	SC266-16-30, 36, 42, 48
Wall Hung Cabinets - 24.5 in./64 cm. High with (1) Shelf				
SC228-16-18, 24, 30, 36, 42, 48	SC221-16-18, 24	SC222-16-18, 24	SC220-16-30, 36, 42, 48	SC226-16-30, 36, 42, 48
Wall Hung Cabinets - 30 in./76 cm. High with (2) Shelves				
SC201-16-18, 24, 30, 36, 42, 48	SC217-16-18, 24	SC218-16-18, 24	SC203-16-30, 36, 42, 48	SC205-16-30, 36, 42, 48
Wall Hung Cabinets - 36 in./91 cm. High with (2) Shelves				
SC238-16-18, 24, 30, 36, 42, 48	SC230-16-18, 24	SC231-16-18, 24	SC232-16-30, 36, 42, 48	SC236-16-30, 36, 42, 48
Wall Hung Cabinets - 42 in./106 cm. High with (2) Shelves				
SC248-16-18, 24, 30, 36, 42, 48	SC240-16-18, 24	SC241-16-18, 24	SC242-16-30, 36, 42, 48	SC246-16-30, 36, 42, 48
Wall Hung Cabinets - 48 in./115 cm. High with (3) Shelves				
SC258-16-18, 24, 30, 36, 42, 48	SC250-16-18, 24	SC251-16-18, 24	SC252-16-30, 36, 42, 48	SC256-16-30, 36, 42, 48

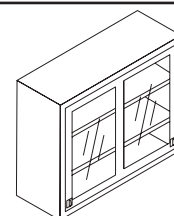
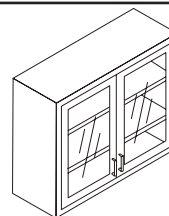
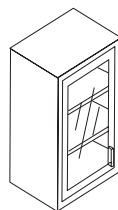
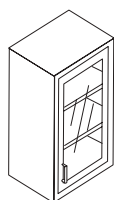
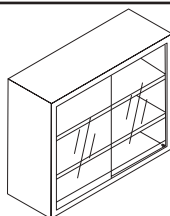

• Sliding Door Unit • Frameless Glass Doors • 25 in./1 cm. • Clear Glass	• Swing Door Unit • Hinged Glass Doors • 25 in./1 cm. • Clear Glass	• Swing Door Unit • Hinged Glass Doors • 25 in./1 cm. • Clear Glass	• Swing Door Unit • Hinged Glass Doors • 25 in./1 cm. • Clear Glass	• Sliding Door Unit • Flush Pulls • 25 in./1 cm. • Clear Glass
Wall Hung Cabinets - 18 in./45 cm. High without Shelf				
SC267-16-30, 36, 42, 48	SC263-16-18, 24	SC264-16-18, 24	SC265-16-30, 36, 42, 48	SC269-16-30, 36, 42, 48
Wall Hung Cabinets - 24.5 in./64 cm. High with (1) Shelf				
SC227-16-30, 36, 42, 48	SC223-16-18, 24	SC224-16-18, 24	SC225-16-30, 36, 42, 48	SC229-16-30, 36, 42, 48
Wall Hung Cabinets - 30 in./76 cm. High with (2) Shelves				
SC219-16-30, 36, 42, 48	SC210-16-18, 24	SC211-16-18, 24	SC206-16-30, 36, 42, 48	SC208-16-30, 36, 42, 48
Wall Hung Cabinets - 36 in./91 cm. High with (2) Shelves				
SC237-16-30, 36, 42, 48	SC233-16-18, 24	SC234-16-18, 24	SC235-16-30, 36, 42, 48	SC239-16-30, 36, 42, 48
Wall Hung Cabinets - 42 in./106 cm. High with (2) Shelves				
SC247-16-30, 36, 42, 48	SC243-16-18, 24	SC244-16-18, 24	SC245-16-30, 36, 42, 48	SC249-16-30, 36, 42, 48
Wall Hung Cabinets - 48 in./115 cm. High with (3) Shelves				
SC257-16-30, 36, 42, 48	SC253-16-18, 24	SC254-16-18, 24	SC255-16-30, 36, 42, 48	SC259-16-30, 36, 42, 48

CASEWORK & SPECIMEN SHELVING

All measurements in inches/*centimeters*
Last two digits of order number indicate cabinet width

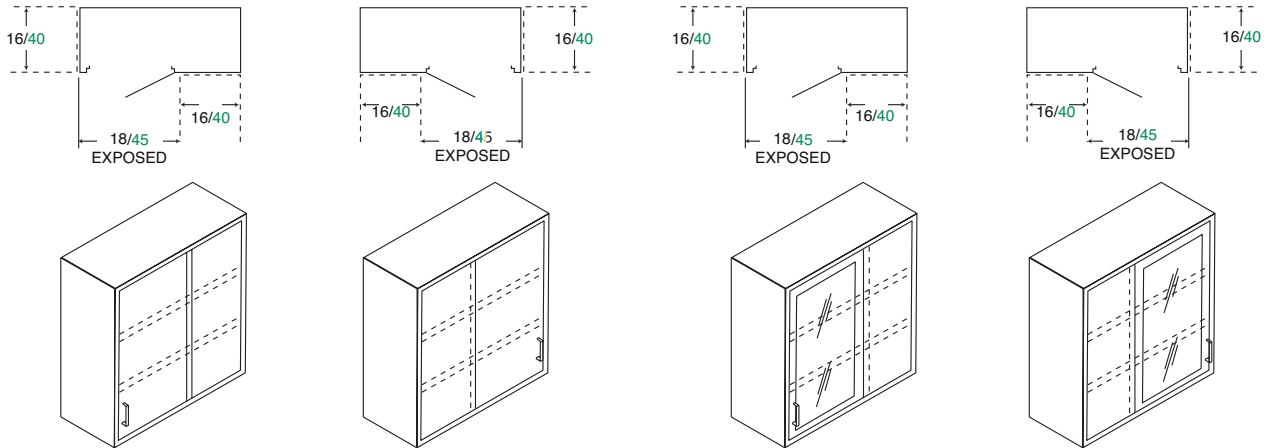

Dead Corner Solid Door • R.H. Door Swing	Dead Corner Solid Door • L.H. Door Swing	Dead Corner Glass Door • .25 in./1 cm. Clear Glass • R.H. Door Swing	Dead Corner Glass Door • .25 in./1 cm. Clear Glass • L.H. Door Swing
SC149-32 24.5 in./62 cm. H	SC153-32 24.5 in./62 cm. H	SC157-32 24.5 in./62 cm. H	SC161-32 24.5 in./62 cm. H
SC150-32 30 in./76 cm. H	SC154-32 30 in./76 cm. H	SC158-32 30 in./76 cm. H	SC162-32 30 in./76 cm. H
SC151-32 36 in./91 cm. H	SC155-32 36 in./91 cm. H	SC159-32 36 in./91 cm. H	SC163-32 36 in./91 cm. H
SC152-32 48 in./121 cm. H	SC156-32 48 in./121 cm. H	SC160-32 48 in./121 cm. H	SC164-32 48 in./121 cm. H

Corner Wall Cabinets - 16 in./38 cm. Deep All units are 25 in./63 cm. wide.

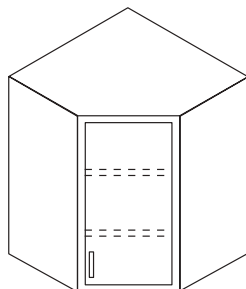
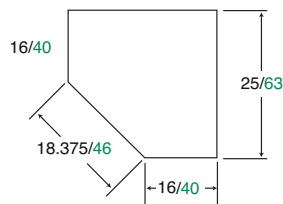
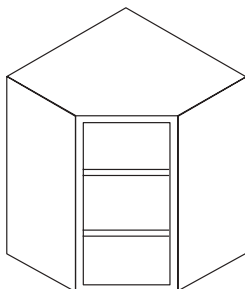
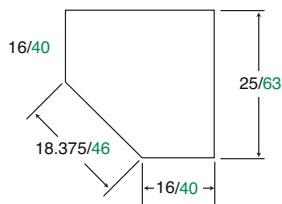

All measurements in inches/*centimeters*

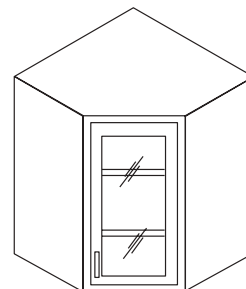
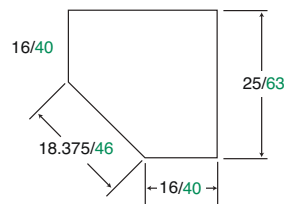

Corner Angle Open Front	Corner Angle Solid Door • R.H. Door Swing	• .25 in./1 cm. Clear Glass • R.H. Door Swing
SC165-25 24.5 in./62 cm. H	SC169-25 24.5 in./62 cm. H	SC173-25 24.5 in./62 cm. H
SC166-25 30 in./76 cm. H	SC170-25 30 in./76 cm. H	SC174-25 30 in./76 cm. H
SC167-25 36 in./91 cm. H	SC171-25 36 in./91 cm. H	SC175-25 36 in./91 cm. H
SC168-25 48 in./121 cm. H	SC172-25 48 in./121 cm. H	SC176-25 48 in./121 cm. H

WALL CABINETS 16" DEEP 10

411 North Aerojet
Avenue Azusa, CA 91702
www.mortechmfg.com

(626) 334-1471

SOLID DOOR TALL STORAGE CABINETS



- Swing Door Storage Unit
- Five Adjustable Shelves
- Hinged Solid Door Panel

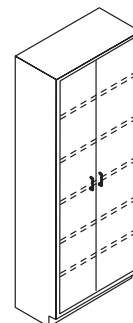
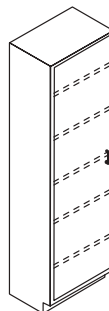
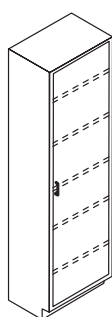

- Flush Pulls

TALL STORAGE CABINETS - 16 in./40 cm. DEEP

SC319-18, 24,	SC320-18, 24	SC353-30, 36, 42, 48	SC355-30, 36, 42, 48
---------------	--------------	----------------------	----------------------

TALL STORAGE CABINETS - 18 in./45 cm. DEEP

SC330-18, 24,	SC331-18, 24	SC332-30, 36, 42, 48	SC336-30, 36, 42, 48
---------------	--------------	----------------------	----------------------

TALL STORAGE CABINETS - 22 in./55 cm. DEEP

SC313-18, 24,	SC314-18, 24	SC303-30, 36, 42, 48	SC305-30, 36, 42, 48
---------------	--------------	----------------------	----------------------

TALL STORAGE CABINETS - 24 in./60 cm. DEEP

SC340-18, 24,	SC341-18, 24	SC342-30, 36, 42, 48	SC346-30, 36, 42, 48
---------------	--------------	----------------------	----------------------

GLASS DOOR TALL STORAGE CABINETS



- Swing Door Storage Unit
- Glazed Glass Door
- Five Adjustable Shelves
- .25 in./1 cm. Clear Glass

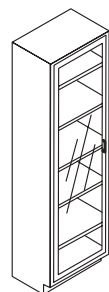
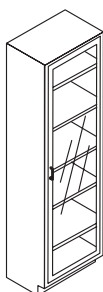

- Flush Pulls

TALL STORAGE CABINETS - 16 in./40 cm. DEEP

SC321-18, 24,	SC322-18, 24	SC357-30, 36, 42, 48	SC358-30, 36, 42, 48
---------------	--------------	----------------------	----------------------

TALL STORAGE CABINETS - 18 in./45 cm. DEEP

SC333-18, 24,	SC334-18, 24	SC335-30, 36, 42, 48	SC337-30, 36, 42, 48
---------------	--------------	----------------------	----------------------

TALL STORAGE CABINETS - 22 in./55 cm. DEEP

SC315-18, 24,	SC316-18, 24	SC307-30, 36, 42, 48	SC308-30, 36, 42, 48
---------------	--------------	----------------------	----------------------

TALL STORAGE CABINETS - 24 in./60 cm. DEEP

SC343-18, 24,	SC344-18, 24	SC345-30, 36, 42, 48	SC347-30, 36, 42, 48
---------------	--------------	----------------------	----------------------

CASEWORK & SPECIMEN SHELVING

All measurements in inches/centimeters
Last two digits of order number indicate cabinet width

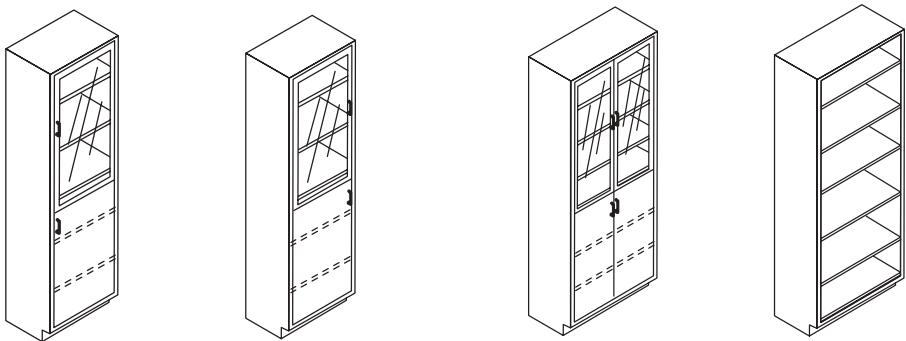

- Instrument Storage Unit
- Hinged Glazed Glass Top Door
- .25 in./1 cm. Clear Glass
- Hinged Solid Lower Door Panel
- Stainless Steel Pull Out Shelf
- Five Adjustable Shelves

TALL STORAGE CABINETS - 16 in./40 cm. DEEP			
SC323-18, 24,	SC324-18, 24, 42, 48	SC359-30, 36, 42, 48	SC351-30, 36
TALL STORAGE CABINETS - 18 in./45 cm. DEEP			
SC361-18, 24,	SC362-18, 24, 42, 48	SC363-30, 36, 42, 48	SC338-30, 36
TALL STORAGE CABINETS - 22 in./55 cm. DEEP			
SC317-18, 24,	SC318-18, 24, 42, 48	SC309-30, 36, 42, 48	SC301-30, 36
TALL STORAGE CABINETS - 24 in./60 cm. DEEP			
SC364-18, 24,	SC365-18, 24, 42, 48	SC366-30, 36, 42, 48	SC348-30, 36

72 in./182 cm. or 84 in./213 cm. Height Available

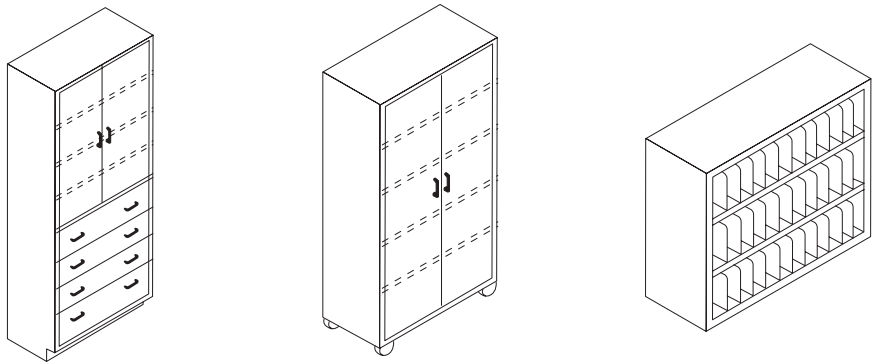

COMBINATION STORAGE UNIT	MOBILE STORAGE UNIT	MAIL CUBICLE
<ul style="list-style-type: none">• Solid Hinged Doors• Three Adjustable Shelves• Four Full Width Drawers, 7 in./17 cm. High	<ul style="list-style-type: none">• Maximum 72 in./182 cm. Height• Minimum 22 in./55 cm. Deep	<ul style="list-style-type: none">• 48 Compartments• Label Holders• 12 in./30 cm. Deep
SC704-36, 48,	SC707-36, 42, 48	SC708-48
		PASS THRU MAIL CUBICLE
		SC709-48



TALL STORAGE & SPECIALTY CABINETS

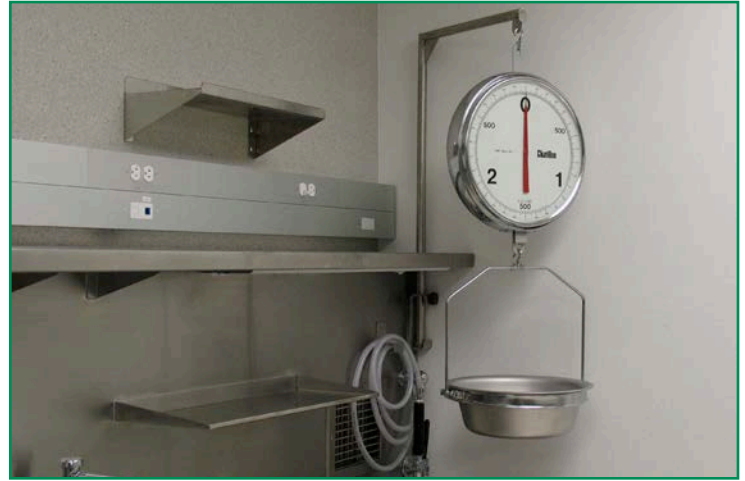

FOLD DOWN SHELF

- 16 in./41 cm. deep
- 24 in./61 cm. deep
- Mounted on Wall
- Positive Side Locks in Up Position

SC518-24, 36, 48, 60

STAINLESS STEEL SHELF

- 12 in./30 cm. deep
- 18 in./46 cm. deep
- Mounted on Wall
- Brackets are formed with Shelf

SC591-24, 36, 48, 60, 72

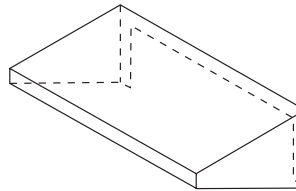
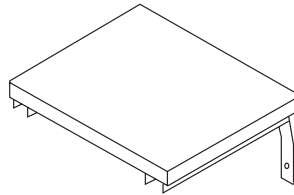

COLLAPSIBLE FOR EXTRA SPACE

HEIGHT ADJUSTABLE



STAINLESS STEEL FOLDING TABLE

- 30 in./76 cm. deep
- Collapsible legs for easy storage
- Height adjustable
- Optional power strip
- Unit can be provided with or without casters

Lengths up to 60, 72, 84

STAINLESS STEEL SHELVEING & FOLDING TABLE

CASEWORK & SPECIMEN SHELVING

All measurements in inches/**centimeters**
Last two digits of order number indicate cabinet width

All legs have adjustment bolts and plastic shoes. Apron is 7 in./17 cm. or 5 in./12 cm. high. (3 in./7 cm. casters optional)

Note: Dimensions shown are actual top sizes - table assembly is 1 in./2 cm. less all around.

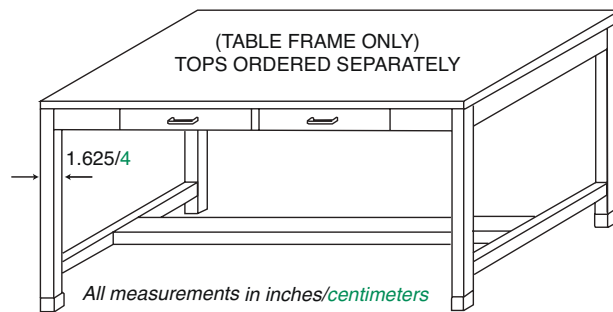

Tops are stainless steel.



STANDING HEIGHT TABLES 37 in./93 cm. HIGH

24 in./60 cm. Deep Tops	30 in./76 cm. Deep Tops	36 in./91 cm. Deep Top	46 in./116 cm. Deep Top
SC451-26, 42, 48, 54, 60, 66, 72	SC453-26, 42, 48, 54, 60, 66, 72	SC454-26, 42, 48, 54, 60, 66, 72	SC456-26, 42, 48, 54, 60, 66, 72

SITTING HEIGHT TABLES 29.75 in./75 cm. HIGH

24 in./60 cm. Deep Tops	30 in./76 cm. Deep Tops	36 in./91 cm. Deep Top	46 in./116 cm. Deep Top
SC450-26, 42, 48, 54, 60, 66, 72	SC452-26, 42, 48, 54, 60, 66, 72	SC457-26, 42, 48, 54, 60, 66, 72	SC458-26, 42, 48, 54, 60, 66, 72

FOR MOBILE TABLES

(4) Casters per kit - 2 with brake mechanism

SC962W

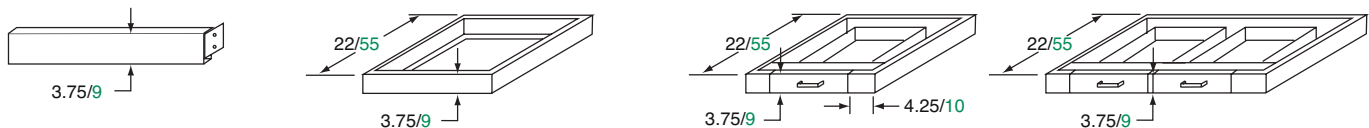

Apron Front	Full Box Apron	Single Drawer	Double Drawer
• Attach to Wall or Adjacent Casework		Apron Section	Apron Section
SC415-18, 24, 30, 36, 42, 48, 54, 60, 66,	SC401-18, 24, 30, 36, 42, 48, 54, 60, 66,	SC403-18, 24, 48	SC405-18, 24, 36, 48, 54, 60,

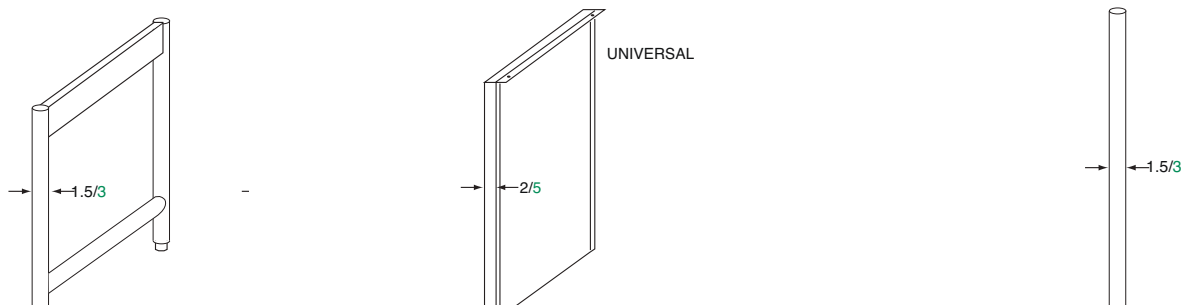

Leg Assembly†	End Pedestal	1.5" Round Leg
35.25 in./89 cm. High	35.25 in./ 89 cm. High	• Round leg with leveling foot adjustment
SC411-22, 28, 34, 44	SC413-22, 23, 24, 29, 31, 36,	SC412-34.25 in./86 cm. H
28 in./71 cm. High	28in./ 71 cm. High	SC422-28 in./ 71 cm. H
SC421-22, 28, 34, 44	SC423-22, 23, 24, 29, 31, 36	

TABLES, APRONS, DRAWER SECTIONS & SUPPORT SECTION

Fabricated Epoxy Sheets

- Factory cut in accordance with approved shop drawings
- Fabricated with a 1/8 in./3mm to 3/16 in./4.76mm radius or standard 1/16 in./1.59mm to 1/8 in./3mm bevel or chamfer
- Sanded edges, along with optional sink cutouts (lipped or undercounter mount), waterfall edge, marine edge, drip groove, backsplash, faucet and gas tap holes, notches, electrical box cutouts, column cutouts, etc., all offered at an additional modification charge

STANDING HEIGHT TABLES 37 in./93 cm. HIGH

24 in./60 cm. Deep Tops

ESC451-36, 42, 48, 54, 60, 66, 72,

30 in./76 cm. Deep Tops

ESC453-36, 42, 48, 54, 60, 66, 72

SITTING HEIGHT TABLES 29.75 in./75 cm. HIGH

24 in./60 cm. Deep Tops

ESC450-36, 42, 48, 54, 60, 66, 72

30 in./76 cm. Deep Tops

ESC452-36, 42, 48, 54, 60, 66, 72

FOR MOBILE TABLES

(4) Casters per kit - 2 with
brake mechanism
SC962

TABLE ASSEMBLIES

All legs have adjustment bolts and
plastic shoes.

Apron is 7 in./17 cm. or 5 in./12 cm. high.
(3 in./7 cm. casters optional)

Note: Dimensions shown are actual top
sizes - table assembly is 1 in./2 cm. less
all around.

Last two digits of order number indicate
TABLE width

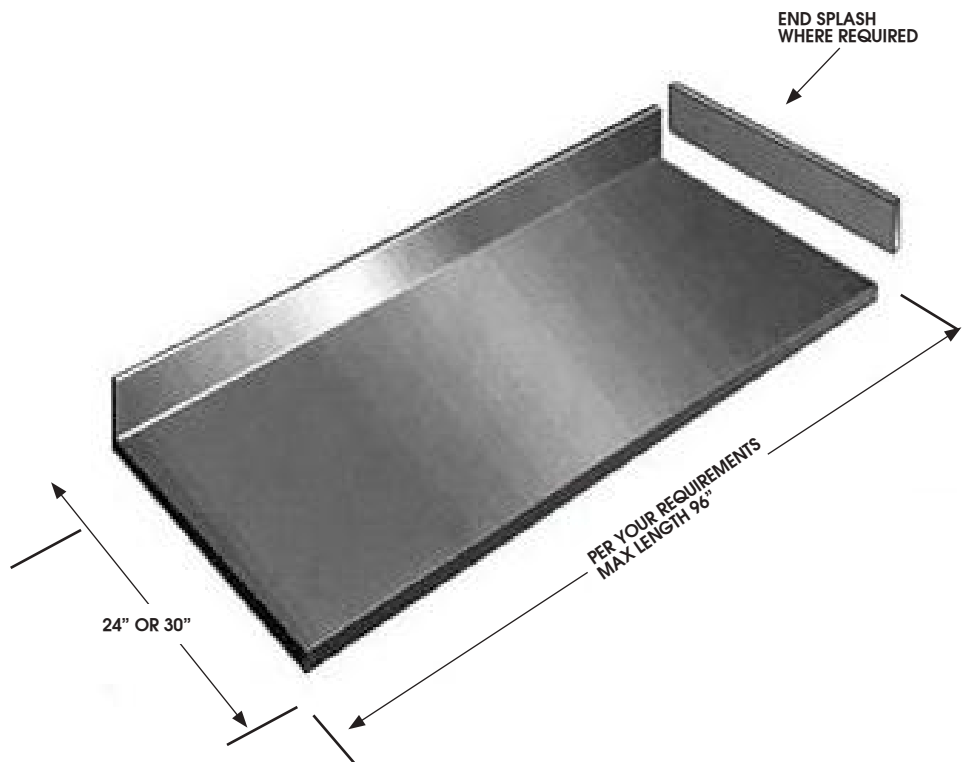
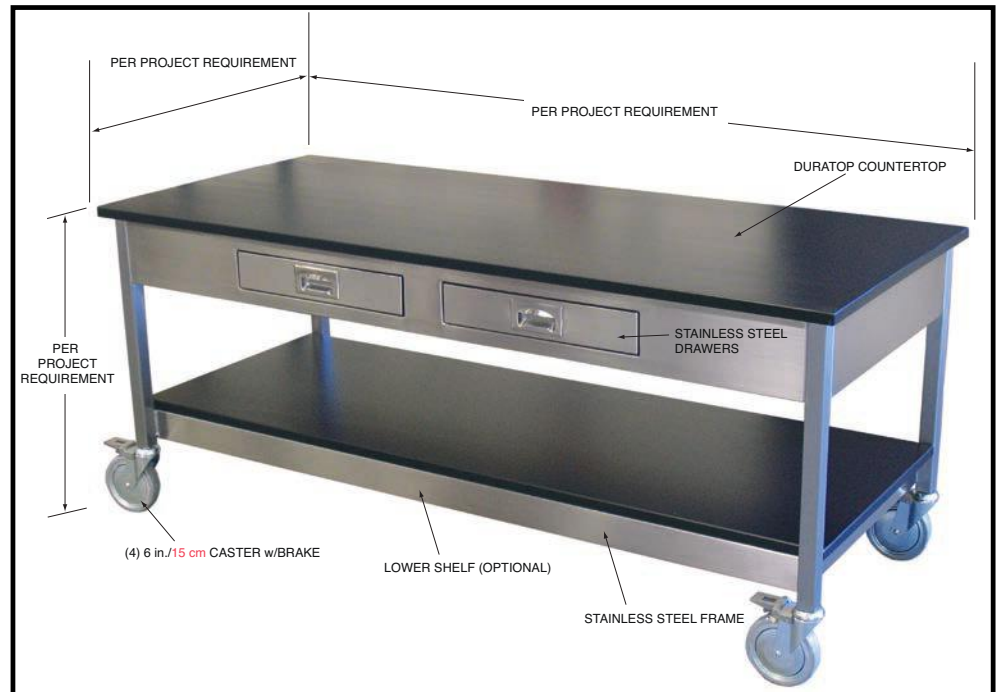

LABORATORY WORKTABLES & DRAWER SECTIONS

Aprons, Drawers and Epoxy Top may be placed on lower shelf

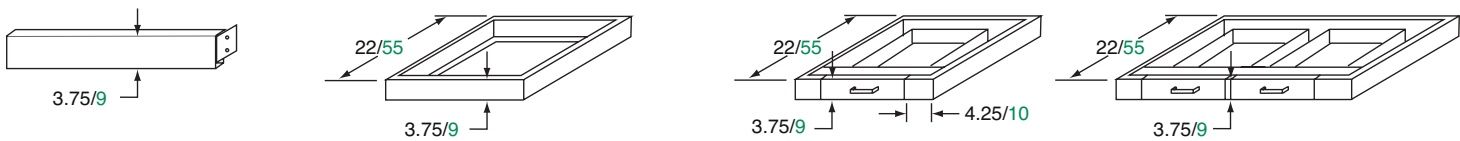

Apron Front Attach to Wall or Adjacent Casework	Full Box Apron	Single Drawer Apron Section	Double Drawer Apron Section
SC415-18 SC415-48 SC415-24 SC415-54 SC415-30 SC415-60 SC415-36 SC415-66 SC415-42	SC401-18 SC401-48 SC401-24 SC401-54 SC401-30 SC401-60 SC401-36 SC401-66 SC401-42	SC403-18 SC403-48 SC403-24	SC405-18 SC405-48 SC405-24 SC405-36 SC405-54 SC405-60



APRONS DRAWERS & SUPPORT SECTIONS
FOR LABORATORY WORKSTATION



CHOOSE YOUR CABINET TYPE

Mortech offers fully customizable options. Choose from:

- Full sized drawers
- Adjustable shelves
- Stainless steel or epoxy table top
- Select mobile or fixed for versatility and convenience
- Length range options up to 6 ft.
- Choose your configuration

See pages 12-3 & 12-4 for selection of configuration options



CUSTOM MOBILE WORK TABLE & CABINETS

VENTILATED STORAGE BASE CABINETS

Vented Storage Base Cabinets

- (5) Lockable Drawers w/ 250lbs max. cap.
- (4) Vented - Morgue Storage Cabinets
SC128-42v 3442
- 75 to 150 CFM depending on size
of the cabinet

Depth available- 16/40, 18/45, 22/55, 24/60
Standard height 72/182, 84/213

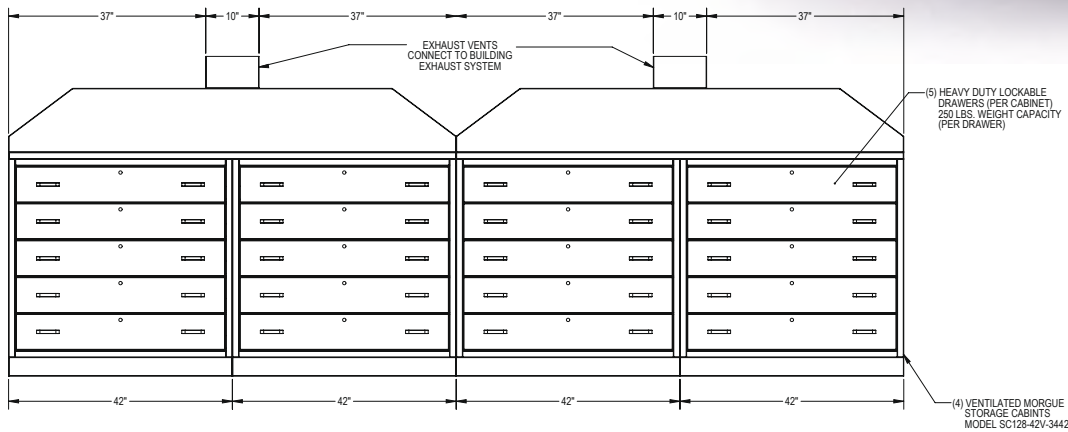
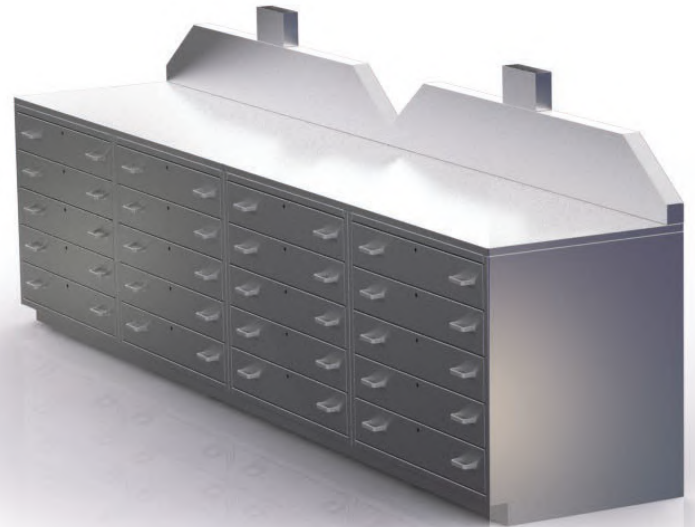

These Ventilated Storage Cabinets are fabricated to be ducted to the exhaust system of your facility. (10) Drawers per unit provides more than enough space to store you item. Each Drawer is equipped with a lock and key.

VENTILATED STORAGE BASE CABINETS



Tall Vented Storage Unit Solid Door

- Five Adjustable Shelves
 - Vented - Attach to Building Exhaust System
 - 75 to 150 CFM depending on size of the cabinet
 - Hinged solid doors
- SC612-36
SC612-48

Depth available-16/40, 18/45, 22/55, 24/60
Standard height 72/182, 84/213

Tall Vented Storage Unit Glass Door

- Five Adjustable Shelves
 - Vented - Attach to Building Exhaust System
 - 75 to 150 CFM depending on size of the cabinet
 - Glass Hinged Doors
- SC613-36
SC613-48

Depth available-16/40, 18/45, 22/55, 24/60
Standard height 72/182, 84/213

All measurements in inches/*centimeters*
Last two digits of order number indicate cabinet width

VENTILATED STORAGE CABINETS

CASEWORK & SPECIMEN SHELVING

VENTILATED TISSUE STORAGE CABINETS



Ventilated Tissue Storage Cabinets

- All Stainless Steel Construction
- Vented - Attach to Building Exhaust System
- 75 to 150 CFM depending on size of the cabinet
- (4) Adjustable leveling feet
- Glass hinged solid doors

Standard Depth- 30/76.2
Standard height- 72/183, 84/213

Mobile Specimen Shelving

- (5) Adjustable Shelves
- (4) Casters with brakes
- Open grid mesh

WORKS GREAT WITH:

FORMALDEHYDE NEUTRALIZER PADS

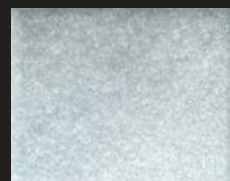

All measurements in inches/centimeters

CASEWORK & SPECIMEN SHELVING

Mortech's ventilated tissue storage is intended fit anywhere in your facility. It is ducted to the buildings exhaust system and the vents out any fumes your storage items may have. For improved organization and storage accessibility racks roll in and out with ease.

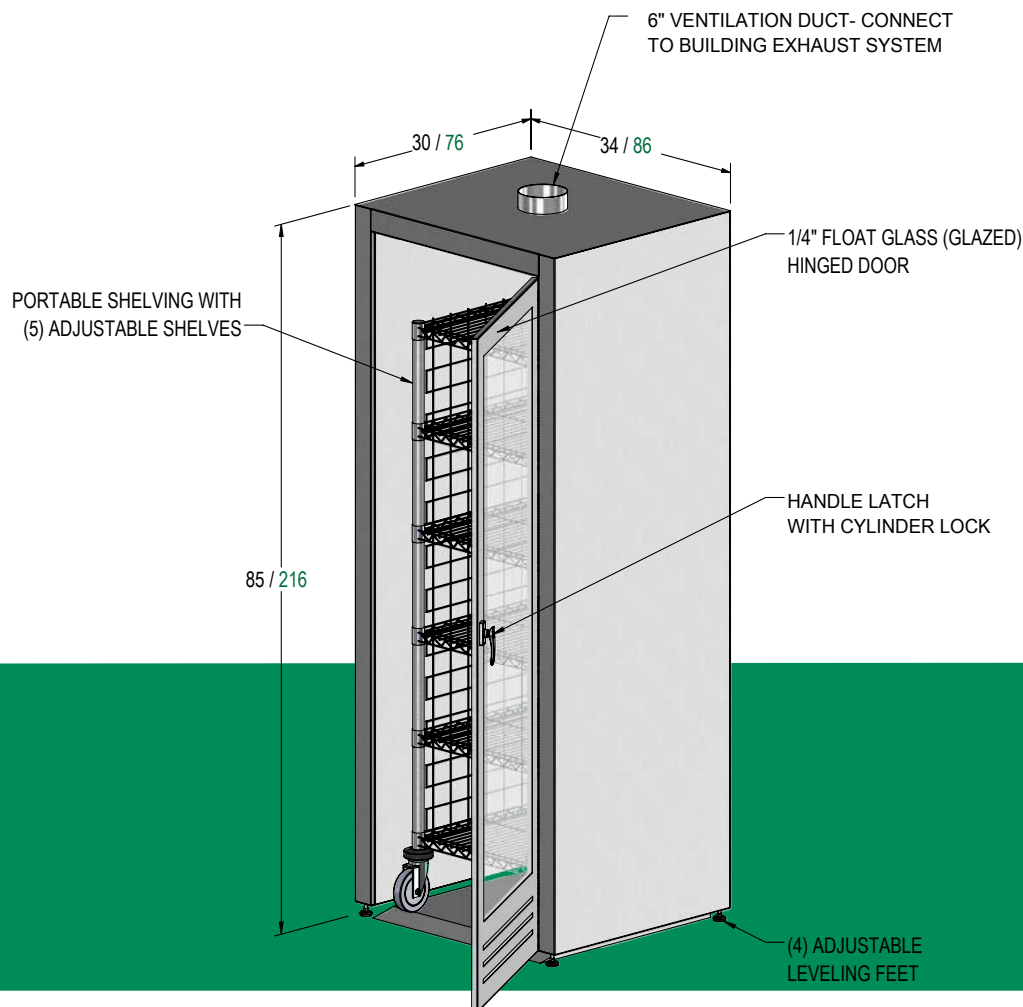

INTEGRATED SHELVING

- Plexi glass door
- Integrated stainless steel shelving
- Height adjustable shelves
- Locking door latch
- Adjustable leveling feet
- Top duct access



CASEWORK & SPECIMEN SHELVING



HIGH DENSITY MOBILE SHELVING SYSTEM

Double your storage space instantly with the economical mobile shelving system. Provides instant access to inventory and allows maximum air and light circulation. The high density shelving system is designed to eliminate unnecessary aisles, free up floor space and increase the number of shelving units that can be used in a designated area.



HIGH DENSITY MOBILE SHELVING SYSTEM

CASEWORK & SPECIMEN SHELVING



High density mobile shelving is done by combining stationary and mobile units, to create or eliminate aisles as needed. The stainless steel overhead track assures smooth shifting of units, eliminating dirt and debris build-up that usually occurs with floor mounted systems and compensates for uneven floors.

Both stationary and mobile units are available with a variety of shelf sizes and finishes. Mobile units have 5" polyurethane wheel casters. Simple installation makes this system practical and easy to use.

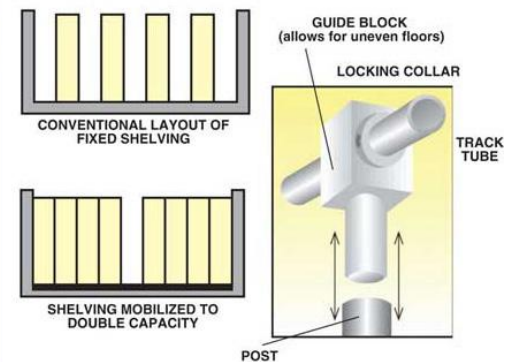
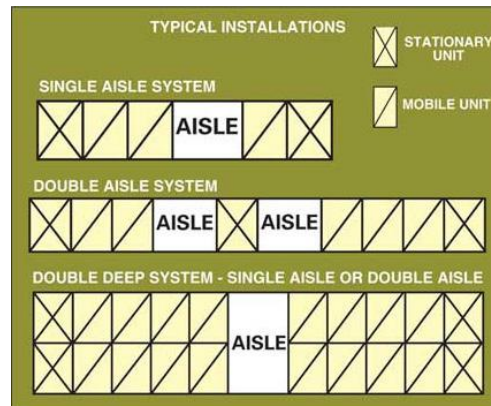

CASEWORK & SPECIMEN SHELVING

Unique design offers high volume, easy access storage in a variety of finishes to suit your needs. Open wire truss reinforced shelves feature front to back welded surface ribs for added strength. Increases light penetration, free air circulation and specimen container visibility. Minimizes moisture and dust accumulation. Easily adjustable and expandable to change with your needs. Shelves adjust on 1 in./2 cm increments.

Wire Finishes

Stainless Steel

Provides stability and durability, handles moisture and temperature extremes. Resists rust and corrosion.

Poly Brite

Powder epoxy over zinc-chromate electroplating that ensures a durable finish against temperature and moisture. Ten year warranty against rust and corrosion.

Epoxy Resin w/ Life Time Warranty

Adjustable wire shelving has a lifetime warranty against rust. Adjustable shelving is protected by an anti-microbial agent that protects the epoxy coating from bacteria, mold and mildew that causes stains, odors and degradation. Use throughout any facility, handles all environmental conditions.

Posts are 1 in./2 cm diameter steel, grooved and numbered for easy adjustability. (Includes floor leveler and cap). To specify finish add the following to Order No.: SS-for Stainless Steel, PB-for Poly Brite ER Epoxy Resin

Available in single order Stainless Steel. All other stainless steel orders have a minimum order of 60 each with a 12 week delivery time.

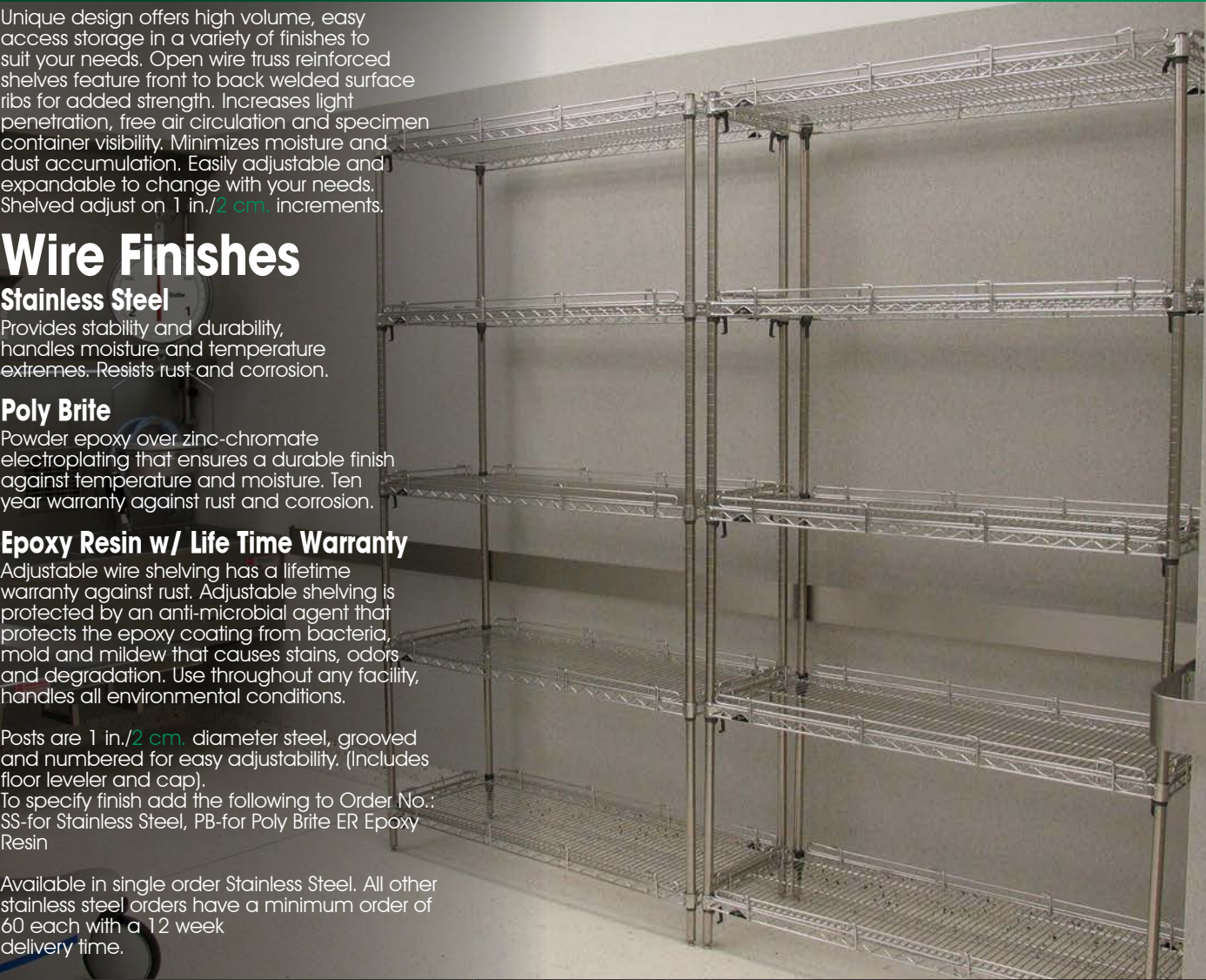

Size (W x L)	Order No.	Size (W x L)	Order No.	Size (W x L)	Order No.
14/35 x 24/60	S1424	21/53 x 24/60	S2124	30/76 x 36/91	S3036
14/35 x 30/76	S1430	21/53 x 30/76	S2130	30/76 x 48/121	S3048
14/35 x 36/91	S1436	21/53 x 36/91	S2136	30/76 x 60/152	S3060
14/35 x 42/106	S1442	21/53 x 42/106	S214t2	30/76 x 72/182	S3072
14/35 x 48/121	S1448	21/53 x 48/121	S2148		
14/35 x 54/137	S1454	21/53 x 54/137	S2154	36/91 x 36/91	S3636
14/35 x 60/152	S1460	21/53 x 60/152	S2160	36/91 x 48/121	S3648
14/35 x 72/182	S1472	21/53 x 72/182	S2172	36/91 x 60/152	S3660
				36/91 x 72/182	S3672
18/45 x 24/60	S1824	24/60 x 24/60	S2424	Posts (H)	
18/45 x 30/76	S1830	24/60 x 30/76	S2430	34/86	P34
18/45 x 36/91	S1836	24/60 x 36/91	•S2436	54/137	P54
18/45 x 42/106	S1842	24/60 x 42/106	S2442	63/160	•P63
18 /45 x 48/121	S1848	24/60 x 48/121	•S2448	66/167	P66
18/45 x 54/137	S1854	24/60 x 54/137	S2454	74/187	•P74
18/45 x 60/152	S1860	24/60 x 60/152	•S2460	86/218	•P86
18/45 x 72/182	S1872	24/60 x 72/182	•S2472	96/243	P96

All measurements in inches/centimeters +-

WALL MOUNTED WIRE SHELVING

Double Shelf Brackets



Single Shelf Brackets



BRACKETS OR POSTS ONLY

Finishes include chrome and epoxy

Adjustable shelf brackets allow you to adjust shelves in 1 in./2 cm. increments. Shelves mount to post individually or in as many tiers as needed. Choice of Single Shelf Bracket or Double Shelf Bracket. Use Double Shelf Bracket for assembling shelves in a continuous run. Double Shelf Bracket attaches to one post. Order one additional post kit every (2) shelves. Uses standard shelves, order shelves separately (See adjustable wire shelving).

Post Kits consist of:
(2) posts/(4) wall brackets

Wall Shelving Brackets

Size (D)	Order No.
14.....	AB14C
18.....	AB18C
21.....	AB21C
24.....	AB24C

Perfect for creating wall storage where floor space is not available. One pair of wall brackets is required per shelf. For adjoining shelves, bracket plates semi overlap one another. Order shelves separately (See adjustable wire shelving) to length desired. Four collar plugs included.

Post Kit

Size (H)	Order No.
14.....	PW14
34.....	PW34
54.....	PW54
63.....	PW63

Single Shelf Brackets

Size (D)	Order No.
14.....	PS14C
18.....	PS18C
24.....	PS24C

Double Shelf Brackets

Size (D)	Order No.
14.....	DPS14C
18.....	DPS18C
24.....	DPS24C



Solid shelving units accept a variety of accessories to adapt to your needs. Dual layer construction provide maximum rigidity and strength. Open styling allows shelves to be reached from all side for the ultimate in space efficiency. Fast, easy assembly, no tools required. Shelves with plastic shelf clips easily lock into place on posts and are adjustable in 1 in./2 cm. increments. Leveling feet compensate for uneven floor surface.

Finishes

Stainless Steel

Provides stability and durability, handles moisture and temperature extremes. Resists rust and corrosion.

Galvanized

Finished in attractive and moisture resistance galvanized steel.

ADJUSTABLE SOLID SHELVING UNITS

Shelves Size (W x L)	Galvanized Order No.	Stainless Steel Order No.	Posts Size	Chrome Order No.	Stainless Order No.
18/45 x 36/91	S1836SZ	S1836SS	34	CP34	
18/45 x 48/121	S1848SZ		54	CP54	
18/45 x 60/152	S1860SZ		63	CP63	P63S
18/45 x 72/182	S1872SZ		66	CP66	
24/60 x 36/91	S2436SZ	S2436SS	74	CP74	P74S
24/60 x 48/121	S2448SZ	S2448SS	86	CP86	P86S
24/60 x 60/152	S2460SZ		96	CP96	
24/60 x 72/182	S2472SZ				
30/76 x 60/152	S3060SZ				
30/76 x 72/182	S3072SZ				

All measurements in inches/centimeters



STATIONARY UNIT



MOBILE UNIT

STATIONARY UNITS & MOBILE UNITS

Security Shelving units allow safe keeping for evidence, valuable tools, instruments, syringes and other valuable commodities. Open 2 in./5 cm. square grid mesh ensures high visibility, while lockable double door keeps contents protected. Doors open a full 270° degrees. Security units feature adjustable leveler or bases with casters.

Stationary units are 66 in./167 cm. high, mobile units are 69 in./175 cm. high. Order additional shelves separately. Available in Chrome or Poly Brite. Additional shelving is extra. Security Units do not include any intermediate shelves. All shelves sold separately.

Stationary Units are 66 in./167 cm. High
Mobile Units are 69 in./175 cm. High



FOLD UP UNIT EVIDENCE SECURITY CABINET



MSTF2000 Fold Up Evidence Security Cabinet

Protect inventory from theft and damage with this completely enclosed truck. Open construction reduces dust accumulation and increases visibility. Folds to 6 in./15 cm. for compact storage. Heavy gauge 1 in./2 cm. x 2 in./5 cm. wire mesh. 1 in./2 cm. square tubing covered with 20 ga. sheet metal. Solid center shelf divides truck into two 34 in./86 cm. H compartments and increases strength of unit. (2) rigid and (2) swivel 6 in./15 cm. x 2 in./5 cm. molded on rubber wheel casters increase mobility. 44.5 in./113 cm. x 27 in./68 cm. x 76 in./193 cm. H. 2000 lb/907 kg capacity. Unit is padlockable. Gray epoxy finish.

STATIONARY UNITS		
Poly Brite-Size (W x L)	Order No.	Extra Shelves-Order No.
24/60 x 36/91	SU2436Z	S2436AZ
24/60 x 48/91	SU2448Z	S2448AZ
24/60 x 60/152	SU2460Z	S2460AZ
Chrome Size-(W x L)	Order No.	Extra Shelves-Order No.
24/60 x 36/91	SU2436C	S2436C
24/60 x 48/91	S2448C	S2448C
24/60 x 60/152	S2460C	S2460C
MOBILE UNITS		
Poly Brite-Size (W x L)	Order No.	Extra Shelves-Order No.
24/60 x 36/91	STS2436Z	S2436AZ
24/60 x 48/91	STS2448Z	S2448AZ
24/60 x 60/152	STS2460Z	S2460AZ
Chrome Size-(W x L)	Order No.	Extra Shelves-Order No.
24/60 x 36/91	STS2436C	S2436AC
24/60 x 48/91	STS2448C	S2448AC
24/60 x 60/152	STS2460C	S2460AC

SECURITY SHELVING UNITS



SIDE WALL PROTECTORS AND CORNER GUARDS

Stainless Steel Sidewall Guards with mounting brackets provides maximum impact protection with a clean, modern design. Stainless steel reduces bacterial growth, and allows for the use of harsh cleaners. Constructed of 304 stainless steel with a #4 Satin finish, these guards provide the perfect finishing touch to your facility.



411 North Aerojet
Avenue Azusa, CA 91702
www.mortechmfg.com

NOTES