



MODEL 1036-13
STAINLESS STEEL FLUSH
EMBALMING STATION

CAUTION

Inspect unit and all components
for any loosening that may have
occurred during shipping

CAUTION

**DO NOT USE CLEANERS
CONTAINING CHLORINE WHEN
CLEANING STAINLESS STEEL**

ATTENTION

Review entire manual before
starting assembly

ATTENTION

All images and Drawing in this manual
may not represent your model.
Refer to your particular project for
exact specifications

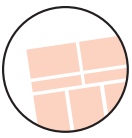

Safety Information

It is important that the information provided in this manual is observed. These instructions should be read carefully and observed fully before installation and initial operation.

WARNING

It is crucial that any work performed on Mortech Manufacturing Inc. manufactured items are carried out exclusively by skilled professionals who have the respective training. Improper use, maintenance, parts and service, or modification to the equipment may cause injury and/or damage. Use and maintain the equipment only for the purpose described in this manual. Use only Mortech Manufacturing Inc. prescribed approved parts and service. Use the equipment only as designed by Mortech Manufacturing Inc.

BLOODBORNE DISEASE NOTICE

To reduce the risk of exposure to bloodborne diseases such as HIV-1 and hepatitis when using the equipment, follow the disinfecting and cleaning instructions in this manual.

RECOMMENDED OPERATING SKILLS AND TRAINING

- SKILLS

Operators using the equipment need:

- ☐ A working knowledge of necessary procedures.
- ☐ The ability to carry out necessary service procedures.
- ☐ A complete understanding of the procedures described in this manual.

- TRAINING

- ☐ Read the this manual as prescribed
- ☐ Be trained on the use of the equipment.
- ☐ Practice with the equipment before using it in regular service.
- ☐ Be tested on their understanding of the equipment operation.
- ☐ Record their training.

BEFORE USING THE EQUIPMENT

Personnel working with this equipment needs to read this manual. Assemble of the unit following set instructions, and perform any pre-service checks to confirm the units operates properly.

INSPECTING THE UNIT BEFORE USE

Please take time to inspect all shipment prior to signing delivery ticket. If concealed damage is discovered, save the carton and immediately contact carrier agent to initiate claim of damage.

BE SURE TO CHECK!

- Are all components present?
 - Do the moving parts operate smoothly?
 - Is unit draining properly?
 - Are all nuts, bolts, and pins secured in place?
- If unit has an issue contact Mortech Manufacturing Inc.

INSTRUCTION FOR HANDLING

Adhere to state and/or local certification and regulations for operation of forklift and/or pallet jack. Cargo is extremely heavy, be sure to have the necessary manpower as well as equipment to successfully unload shipment from transport. We recommend a forklift and/or pallet jack with the capacity to lift up to 2000 lbs. to remove cargo from transport.

The forklift can be used to unload receiving products safely by placing the load on the floor, maneuvering the forklift into position, tilting the mast forward to vertical position so the load will be level, lowering the load, and smoothly backing away without dragging. Once cargo is unloaded, positioning equipment for installation will once again require a forklift. Read all manual and note on installation of the unit before attempting installing.

The pallet jack can be used (with a loading dock and maneuverability on and off the transport vehicle) to unload receiving products safely. Maneuvering the pallet jack into position (in the appropriate position within the pallet), lifting the pallet then driving the pallet jack off the transport and safely into the place of installation.

Range of Environmental Condition

Mortech Manufacturing, Inc. equipment shall be placed in a controlled environment (housing or housed unit) hindering the weathering effects on the installed units. The equipment will have minimal corrosive and eroding factors that can break down the stability and operation of Mortech Manufacturing Inc. equipment. The impact on the equipment by the operator utilizing water or corrosives in the medical procedures can be controlled and responsibility for the cleaning and maintenance placed upon that person. The effects of anthropogenic (man-made) gasses on the environment, such as carbon dioxide (CO₂) that will be omitted from the unit should be minimal.

Due to continuous innovation and product development this installation guide is subject to change without notice.

Please save these instructions for later use.

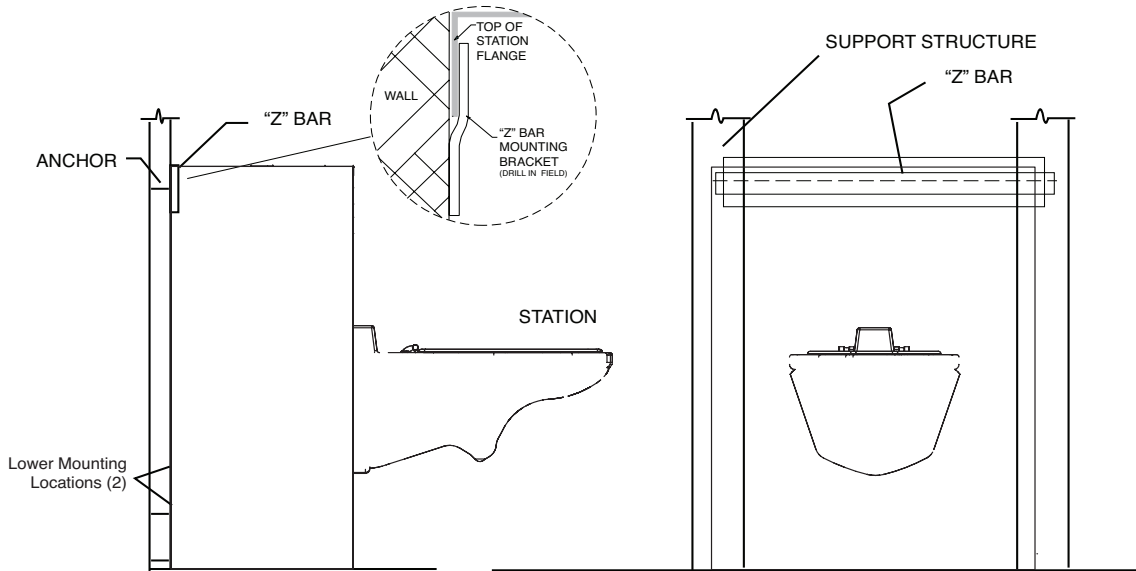

MOUNTING INSTRUCTIONS

Step 1. Verify all utility rough-ins have been supplied in the proper location and per the project specifications. Drawings from Mortech for utilities is provided with the submittal packet information. Utilities can include: water lines, electrical, etc.

Step 2. (Refer to Figure-A) Verify what type of support structure has been provided for mounting. Use mounting anchors appropriate for support structure.

Step 3. Verify mounting height for "z" bar mounting bracket. The "z" bar mounting bracket is supplied with each station from Mortech. Drawings are provided with the submittal packet showing the mounting height. Mount "z" bracket level with appropriate anchor for the backing support provided. The "z" bar is shorter than the overall length of the unit so you must center the "z" bar relative to the center of the station when mounted. Lengths of stations vary per project so you must reference your submittal information for the station length provided.

Step 4. Some stations are large and heavy so it is best to use a mechanical lift to maneuver the station into position. Make sure the unit is resting level on the fork arms. Sometimes a fork extension will be necessary. Raise the unit position and insert the flange of the station into the "z" bar mounting bracket. Lower into position. The unit will fully rest on the "z" bar. Then raise slightly to take the pressure off.

Step 5. While the lift is still holding the station in position, install the lower anchor at each gusset location. You should install at least (2) anchors per gusset. Gussets are located at each end of the station and (1) or (2) in the center of the unit. Use anchors per above recommendations for type of support structure.

Step 6. The station is now properly anchored to the wall and the lift may be released.

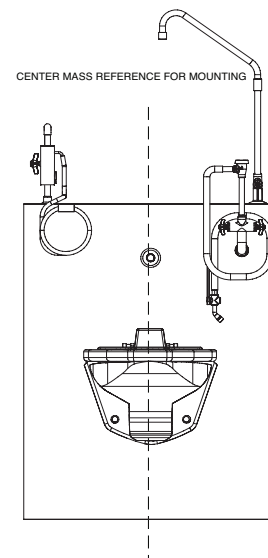
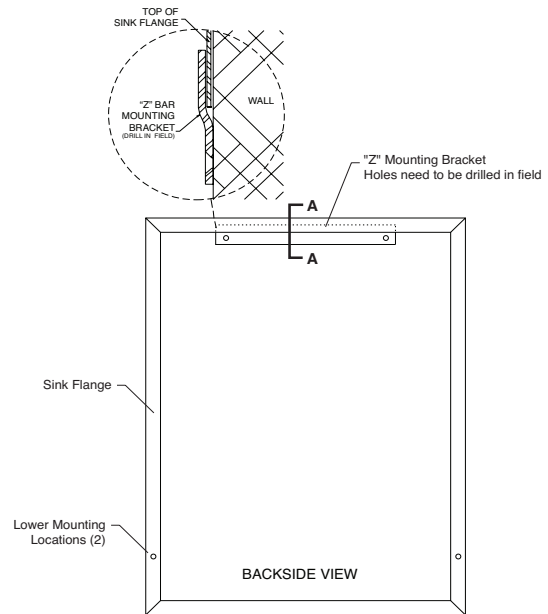

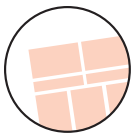

Installation

1036-13 Stainless Steel Flush Embalming Station

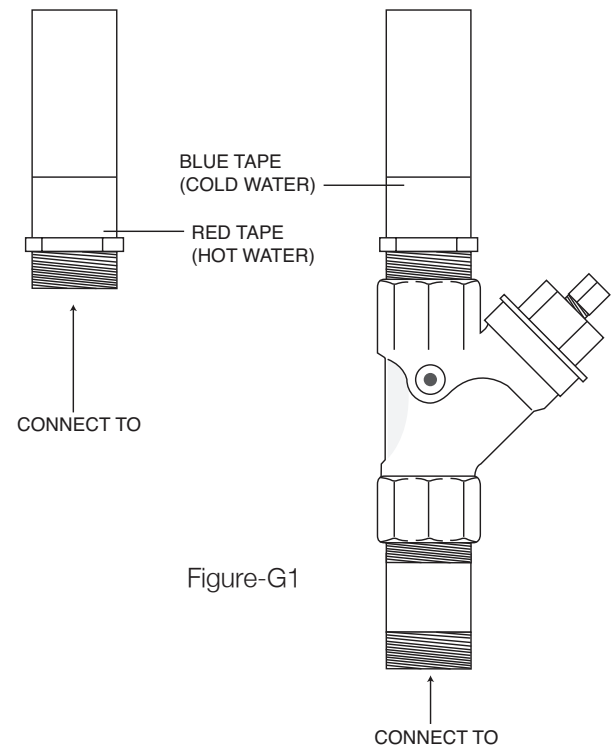
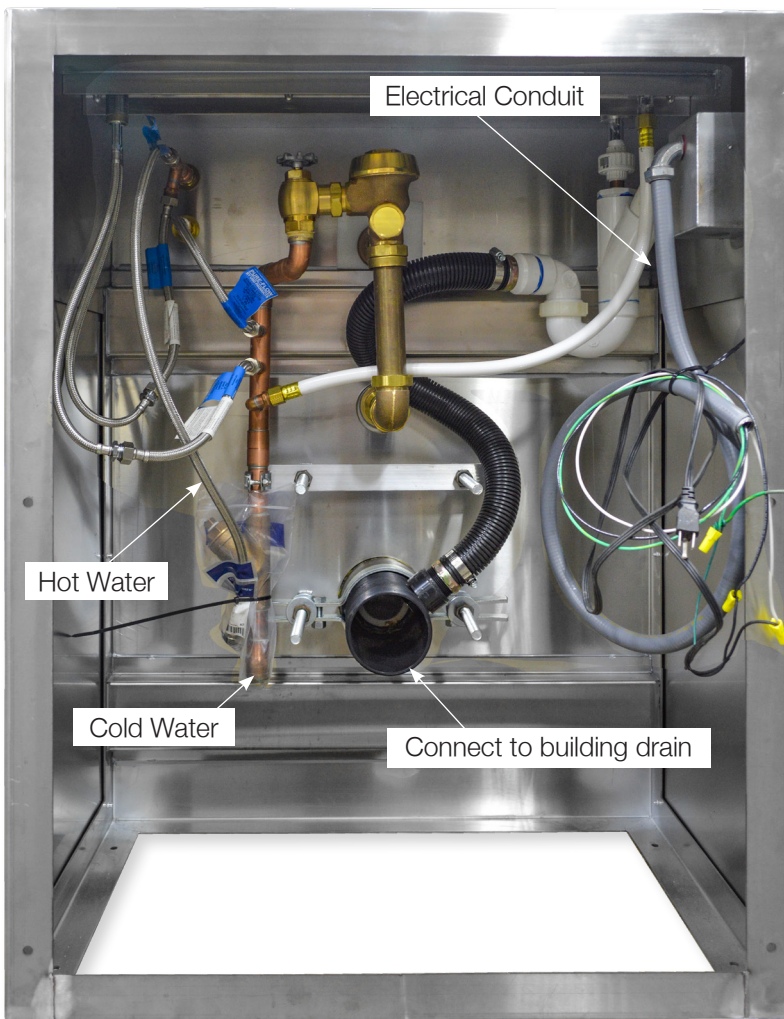

PLUMBING CONNECTION INSTRUCTIONS

STEP 1: (Refer to Figure-G) Flush out all water lines prior to connection. Debris may be in the lines from construction process. Install shut off valves on each water line. Lines are clearly marked RED for hot and BLUE for cold. (Refer to Figure-G1) The station is provided with a single point connection for hot and cold water. A typical flex line can be used for connection.

Step 2: Connect drain line to sink basin or disposal unit, depending on the option provided. (Refer to Figure-H)

See Disposal manufacturers manual.

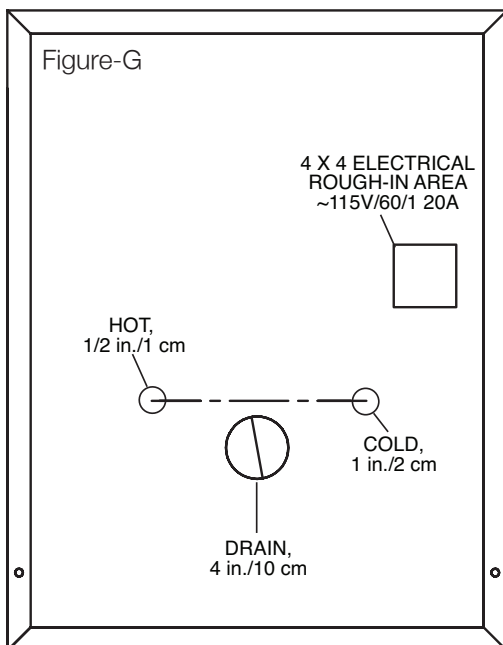

NOTES:

1. FLUSH LINES CLEAR BEFORE CONNECTING TO STATION.
2. PROVIDE 60-65 LBS. WATER PRESSURE AND 4 GALLONS PER MINUTE OF FLOW FOR PROPER OPERATION OF HYDRO ASPIRATOR.
3. PLUMBER TO PROVIDE SHUT OFF VALVE FOR WATER CONNECTIONS.
4. ELECTRICIAN TO PROVIDE LIQUID TIGHT JUNCTION BOX AND CONDUIT CONNECTIONS PER LOCAL CODES.

ELECTRICAL

1036-13 Flush Embalming Station
 ~120VAC/60hz/1ph
 (15A Circuit-GFCI)
 Main Power Disconnect To Be
 Recommended or Supplied:

ELECTRICAL CONNECTION INSTRUCTIONS

- 1: (Refer to Figure-I for electrical wiring within the conduit) Connect electrical lines from station to building. Units are provided with watertight conduit lines for connection.
2. A waterproof load center (if requested, optional) with 1 circuit breaker disconnect with a 15A fuse (15A Circuit-GFCI) will be attached to the unit itself. Then connected to the point of connection provided on installation site.

15A Circuit-GFCI consist of
 GFCI - 20A

Figure-I

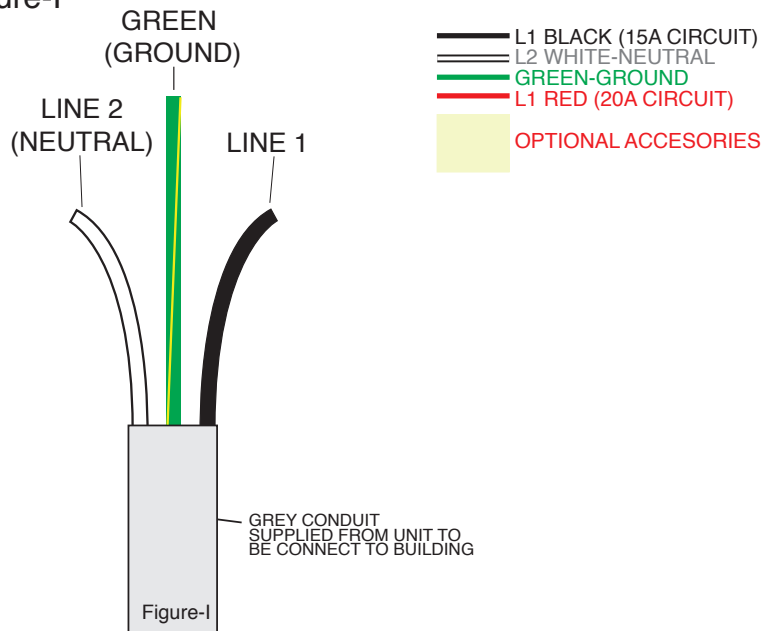

15A CIRCUIT-GFCI

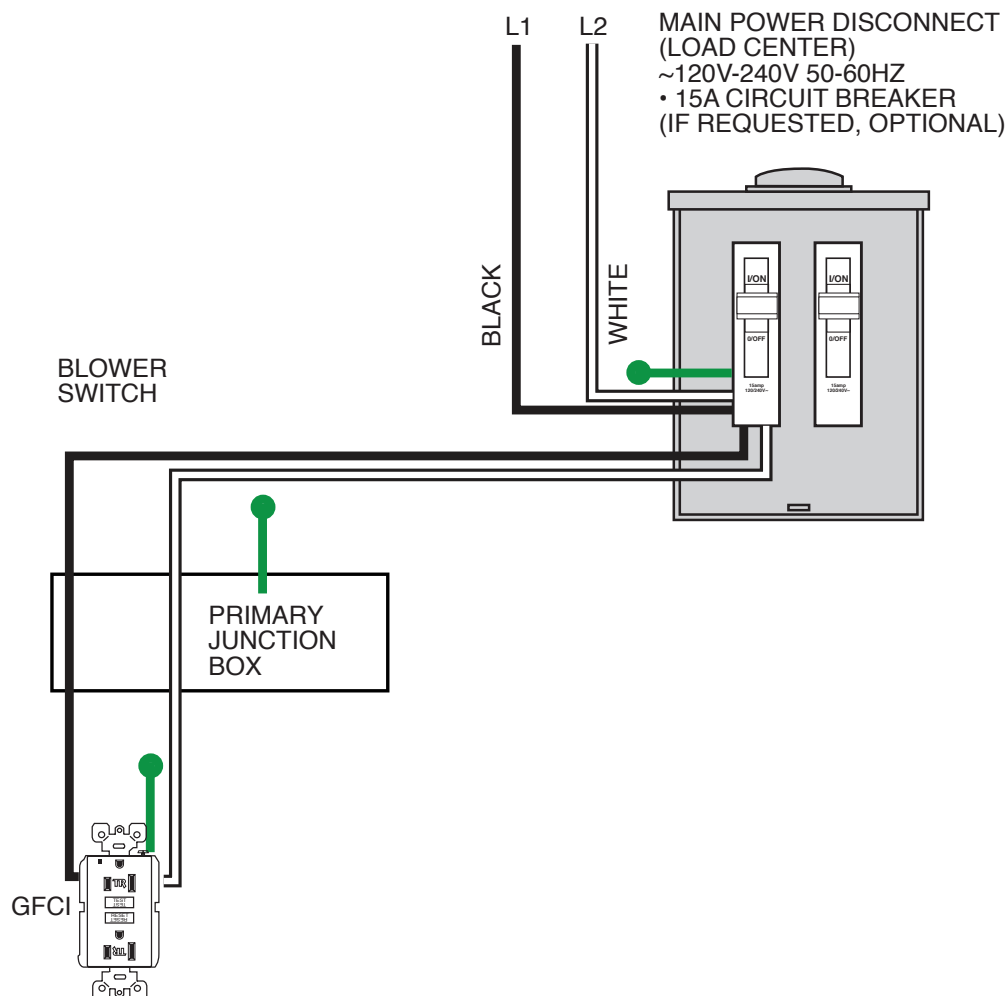

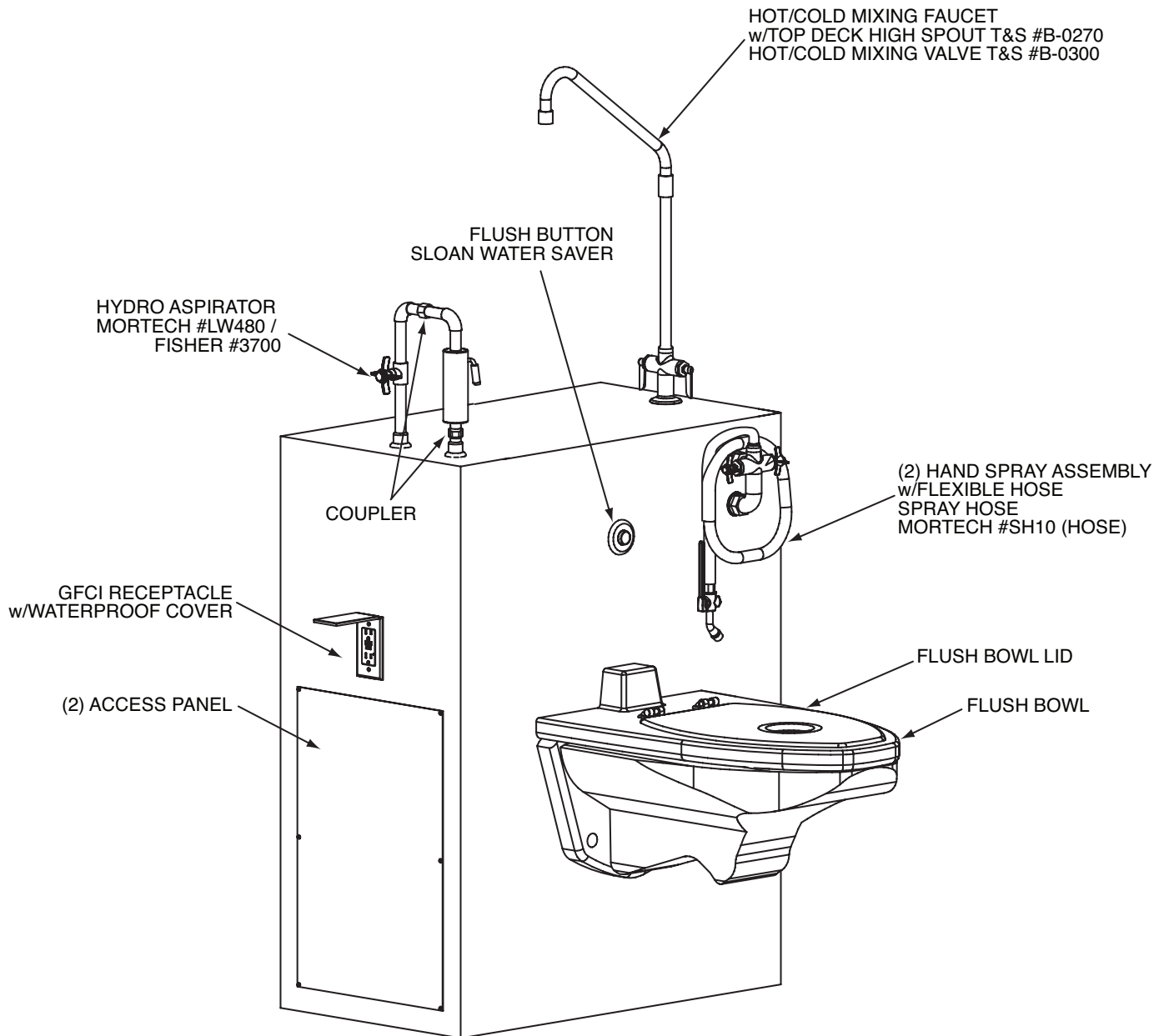
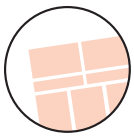

STANDARD DESIGN FEATURES

- All stainless steel construction on rear base housing
- Large white vitreous china flush sink
- Hot and cold water mixing faucet mounted on top deck with high spout for use with you embalming machine
- Deluxe aspirator with reverse flow for additional waste removal: "reverse flow" feature instantly relieves suction clogging by providing a reverse pressure of water.
- Hot and cold spray hose assembly with spray nozzle and 10 feet/3 meters of flexible hose
- Splash cover with port for placement of embalming table drain hose
- Push button control to flush sink basin
- Back flow protection for all fixtures to protect your building water supply
- GFCI duplex receptacle w/waterproof cover
- Access panel
- Internally plumbed and wired requiring only single point connection of water and power

1036-13 Stainless Steel Flush Embalming Station

Standard Design Components

Toto

Wall Mounted Elongated Toilet

Features:

- Elongated bowl gives a modern and comfortable look and feel extending out an extra 1-1/2" compared to a round configuration
- Made from vitreous china delivering strength and aesthetic appeal
- Wall mounted installation
- Powerful, quiet siphon jet flushing action
- ADA compliant – complies with the standards set forth by the Americans with Disabilities Act for toilets
- Uses 20% less water than the current standard while maintaining superior performance



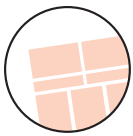

SLOAN VALVES

Specifications

- High chloramine resistant synthetic rubber diaphragm with linear filtered bypass and vortex cleansing action
- Metal non hold open push button
- 1" I.P.S. wheel handle stop
- Adjustable tailpiece
- Vacuum breaker
- Elbow flush connection and spud coupling for 1 1/2" concealed back spud
- Exposed parts chrome plated
- Sweat solder adapter
- High copper, low zinc brass castings for dezincification resistance
- Non hold open push button and no external volume adjustment to ensure water conservation
- Low consumption flush accuracy
- Handle packing, stop seat and vacuum breaker molded from rubber compound for chloramine resistance
- 100% of the energy used in manufacturing is offset with renewable energy sources (wind energy)

CARE AND CLEANING OF CHROME AND SPECIAL FINISHES

DO NOT use abrasive or chemical cleaners to clean Flushometers as they may dull the luster and attack the chrome or special decorative finishes. Use ONLY soap and water, then wipe dry with clean cloth or towel. While cleaning the bathroom tile, the exposed Flushometer handle, button or piping should be protected from any splattering of cleaner. Acids and cleaning fluids can discolor or remove chrome plating.

TROUBLESHOOTING GUIDE

I. Flushometer does not function.

- Control Stop or Main Valve is Closed. Open Control Stop or Main Valve.
- Handle or Push Button Assembly is worn. Install Sloan Handle Repair Kit(C-70-A) or replace handle or push button.
- Relief Valve is worn. Replace Inside Parts Kit.

II. Insufficient volume of water to adequately siphon fixture.

- Control Stop not open enough. Adjust Control Stop for desired delivery of water.
- Urinal Flushometer Parts inside a Closet Flushometer. Replace Inside Urinal Parts with proper Closet Flushometer Parts.

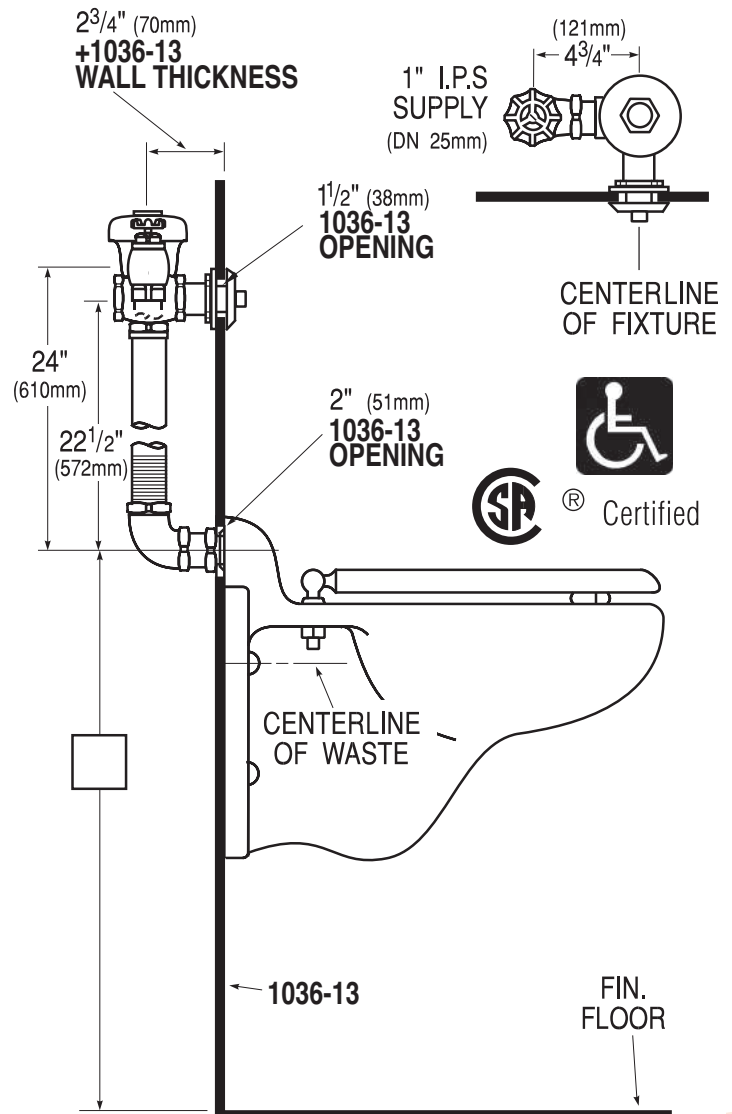

C. Low Consumption Flushometer installed on a non-Low Consumption fixture. Replace A-41-A Inside Parts Kit with A-38-A Water Saver Kit.

D. Water Saver Kit installed in old, non-Water Saver bowl. Position Refill Head A-170 so that SIDE 1 is in the UP Position.

E. Inadequate volume or pressure at supply.

- If no gauges are available to properly measure supply pressure or volume of water at the Flushometer, then remove the Relief Valve from the Inside Parts Kit, reassemble the Flushometer and open the Control Stop. If the fixture siphons, more water volume is required. If a 3.5gpf Inside Parts Kit is installed in the Flushometer, then first flip the Refill Head (under the Diaphragm) to obtain a 4.5gpf volume. If this volume is still inadequate, remove the Flow Ring from the Guide to obtain a 6.5gpf Kit. If additional flow is still required, try a Low Pressure Guide Kit A-175-A (#0301104).

1036-13 Stainless Steel Flush Embalming Station

Standard Design Components

IMPORTANT- Laws and Regulations requiring Low Consumption Fixtures (1.6gpf Water Closets and 1.0gpf Urinals) prohibit the use of higher flushing volumes.

- If fixture does not siphon or if a Low Consumption fixture is installed, or if the above steps do not prove satisfactory, steps must be taken to increase the pressure and/or supply.

III. Flushometer closes off immediately.

- A. Ruptured or damaged Diaphragm. Install Inside Parts Kit to correct problem and update Flushometer.
- B. Enlarged By-pass orifice from corrosion or damage. Install Inside Parts Kit to correct problem and update Flushometer.

IV. Length of flush is too short (Short Flushing).

- A. Diaphragm Assembly and Guide Assembly are not hand-tight. Screw the two assemblies hand-tight.
- B. Enlarged By-pass orifice from corrosion or damage. Install NEW Inside Parts Kit to correct problem and update Flushometer.
- C. A-19-AU (Black) Urinal Relief Valve in Closet Flushometer. Replace Relief Valve with A-19-AC (White) Closet Relief Valve.
- D. A-41-A Low Consumption Kit installed in non-Low Consumption fixture. Replace with proper Inside Parts Kit.
- E. Handle Assembly is worn. Install Handle Repair Kit C-70-A or replace the Handle.

V. Length of flush is too long (Long Flushing) or fails to close off.

- A. Relief Valve is not seating properly or By-pass orifice is clogged because of foreign material, or By-pass orifice is closed by an invisible gelatinous film from "over-treated" water.

Disassemble the working parts and wash thoroughly.

NOTE: SIZE OF THE ORIFICE IN THE BY-PASS IS OF UTMOST IMPORTANCE FOR THE PROPER METERING OF WATER INTO THE UPPER CHAMBER OF THE FLUSHOMETER. DO NOT ENLARGE OR DAMAGE THIS ORIFICE. REPLACE INSIDE KIT IF CLEANING DOES NOT CORRECT PROBLEM.

- B. Line pressure has dropped and is not sufficient to force Relief Valve to seat. Shut off all control stops until pressure has been restored, then open them again.
- C. A-19-AC (White) Closet Relief Valve has been used in a 1 or 1-1/2gpf Urinal. Replace with A-19-AU (Black) Relief Valve.
- D. Inside Cover is cracked or damaged. Replace the Inside Cover (A-71).

Water Saver, 3.5 gpf (13.2 Lpf) Low Consumption, 1.6 gpf (6.0 Lpf)

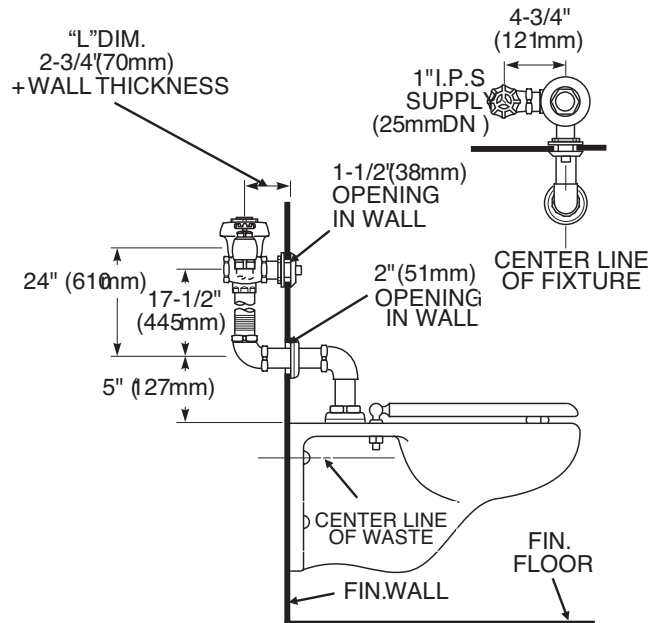

VI. Chattering noise in Flushometer.

- A. The A-156-A Segment Diaphragm has been installed upside-down. Replace the Segment Diaphragm to the proper position as instructed by markings on the Diaphragm.
- B. The Inside Cover has become distorted from wear, freezing or abuse. Replace Inside Cover.

VII. Leaking at Handle or Push Button Assembly.

- A. The B-39 Seal is worn or deteriorated. Install new B-39 Seal. **NOTE:** The B-39 Seal will easily slide on to the B-40 Bushing if it is wet.
- B. Handle gasket has been omitted. Install A-31 Handle Gasket or Sloan Handle Repair Kit (C-70-A).
- C. Valve Handle Bushing is worn. Install Sloan Handle Repair Kit (C-70-A).

Refer to the Royal Flushometer Maintenance Guide for additional Troubleshooting and Repair Part information. If further assistance is required, please contact the Sloan Valve Company Installation Engineering Department at 847-671-4300.

Manufactured in the U.S.A. by Sloan Valve Company under one or more of the following patents:

U.S. Pats. 5,295,655; 5,542,718; 5,558,120; 5,564,460.
Other Pats. Pending. BAK-CHEK®, PARA-FLO®, PERMEX®, TURBO-FLO®

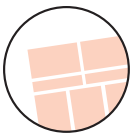

Standard Design Components

1036-13 Stainless Steel Flush Embalming Station

MIXING FAUCET with SPRAY HOSE ASSEMBLY

Wall mount vertical mixing faucet with polished chrome plated brass body, swivel outlet (less nozzle), compression cartridges with spring checks, 4-arm handles and 1/2" NPT female inlets. Certified to ASME A112.18.1/CSAB125.1, NSF 61-Section 9 and NSF 372. Meets ADA ANSI/ICC A117.1 requirements.

- Includes EZ-K kit to convert rigid risers to EasyInstall
- Quarter-turn Eterna compression cartridges with spring checks to prevent the cross flow of water
- Adjustable centers from 2 3/4" to 3 1/4"
- **Material:** Polished chrome plated brass body and chrome plated metal handles
- **Nozzle Flow:** 17.8 GPM (67.38 L/min)
- **Pressure Min:** 20 psi (1.38 bar)
- **Pressure Max:** 125 psi (8.62 bar)
- **Temperature Min:** 40 F (4.44°C)
- **Temperature Max:** 140 F (60°C)

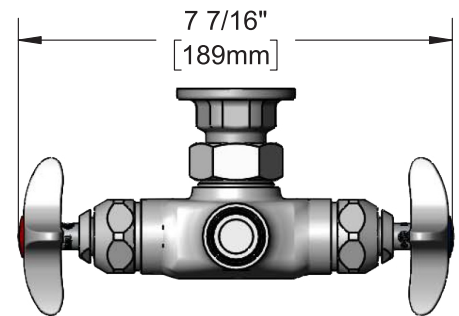

EZ-K
EasyInstall Kit
Converts Rigid Risers &
Nozzles for Use with
Swivel Outlet (Included)

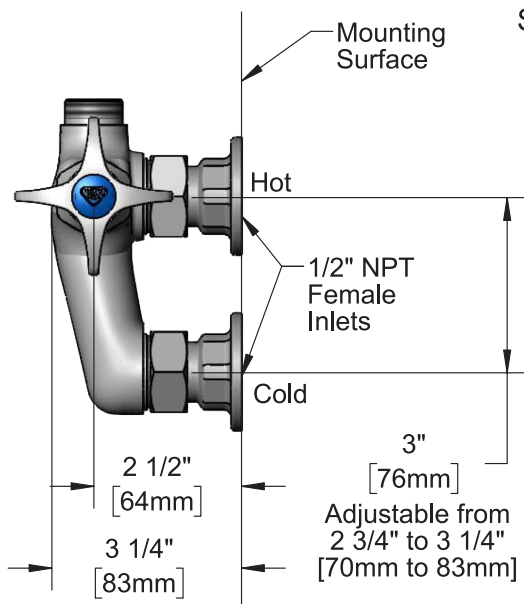

Swivel Outlet Accepts
Standard T&S Swing Nozzle.
Converts to Rigid w/
014200-45
Lock Washer (Included)

Quarter-Turn
Eterna Cartridges w/
Spring Checks &
Lever Handles w/
Color Coded Indexes

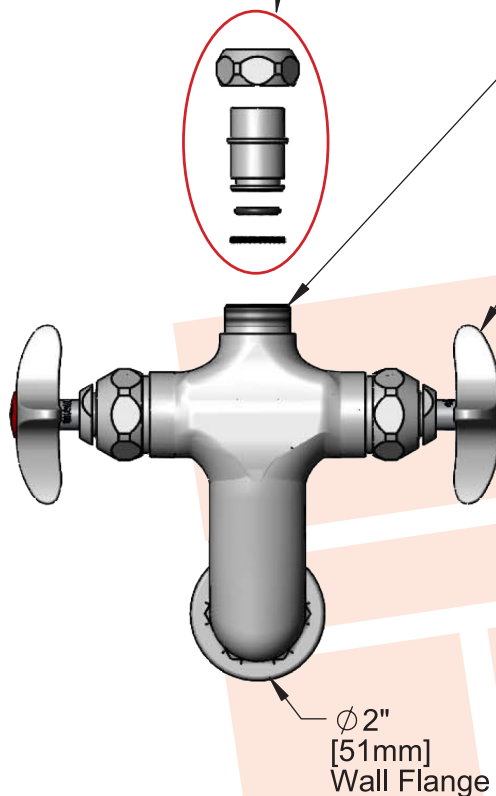

ADA Compliant

1036-13 Stainless Steel Flush Embalming Station

Standard Design Components

SPRAY HOSE ASSEMBLY

SPRAY HEAD: Model #10820

SPRAY HANDLE: Model #2913

SPRAY HOSE: Model #SH10

Features

- 1/4" ID X 10 ft. MPT swivel and rigid
- Outstanding coil memory
- Oil and fuel resistant
Wash hands after handling.
- Single wall
- Stem - right hand
- Swiveling seat disk
- Hot & cold index buttons
- Stainless steel seats
- Stainless steel seat screws
- Stainless steel handle screws

Recommended Settings

- 110°F at 80 psi

System limits

- Temp: 40°F min. to 140°F max.
Pressure 200 psi max. static
Shipping weight
- 11.5 lbs

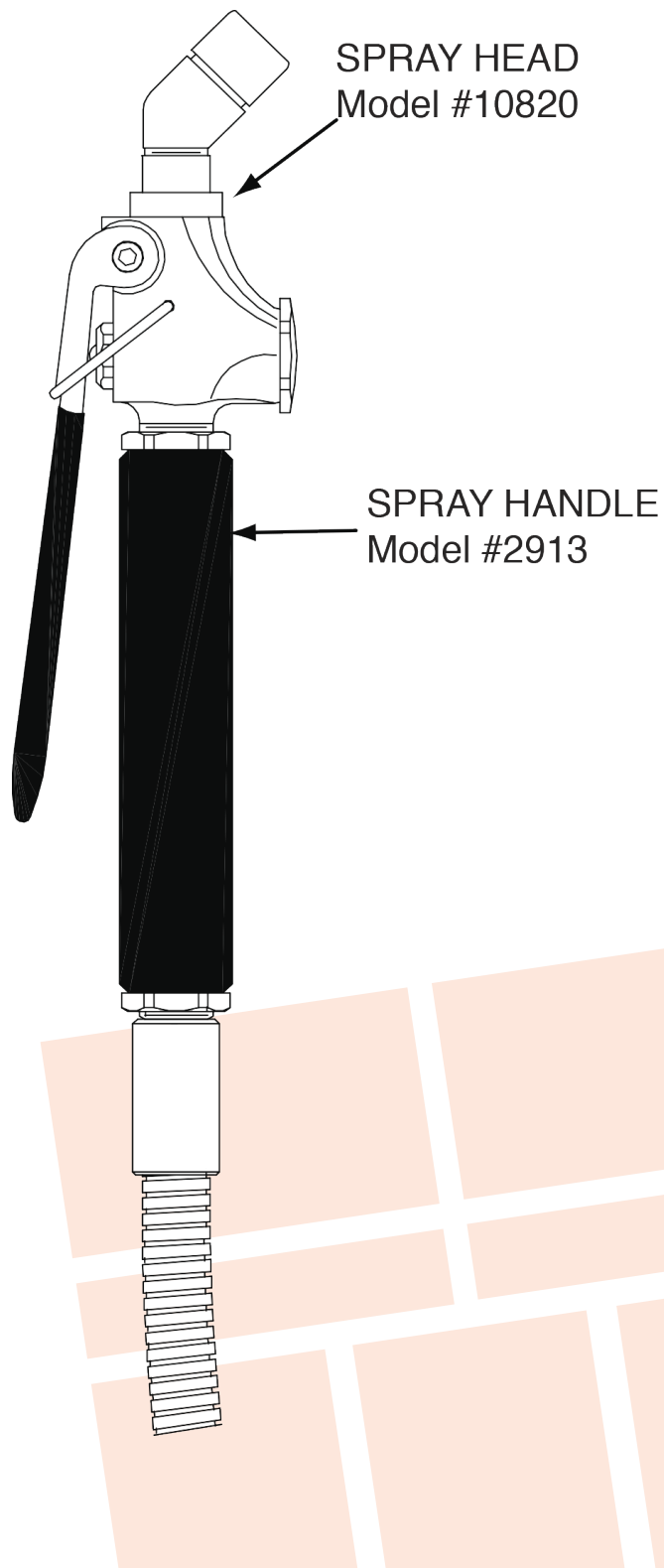

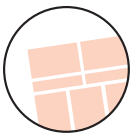

BACKFLOW PREVENTERS

ATTENTION INSTALLER

Before installing, flush out pipe lines to remove scale and other foreign matter. The valves can be installed horizontally or vertically. Install the valve in the line with the arrow on valve body pointing in the direction of flow.

Application

The Model N9 series are recommended for continuous pressure type installations. Potable water must be protected from backflow of hazard substances used in equipment container, sinks and set tubs. In the event of negative supply pressure such contaminated fluids will not backflow to the supply source by backsiphonage. For clarification of hazard substances consult Local Plumbing Authority or Health Department.

Maintenance

Annual inspection is required, since cleaning and checking of all water system safety and control valves assures maximum life and proper product function.

Temperature and Pressure

Maximum Pressure 150psi (10.3 bar).

Maximum Temperature 140°F (60°C).

Annual inspection of all water system safety and control valves is required and necessary. Regular inspection, testing and cleaning assures maximum life and proper product function. Teflon® is a registered trademark of the E.I. Dupont de Nemours & Company.

Limited Warranty

Watts Regulator Co. (the "Company") warrants each product to be free from defects in material and workmanship under normal usage for a period of one year from the date of original shipment. In the event of such defects within the warranty period, the Company will, at its option, replace or recondition the product without charge.

THE WARRANTY SET FORTH HEREIN IS GIVEN EXPRESSLY AND IS THE ONLY WARRANTY GIVEN BY THE COMPANY WITH RESPECT TO THE PRODUCT. THE COMPANY MAKES NO OTHER WARRANTIES, EXPRESS OR IMPLIED. THE COMPANY HEREBY SPECIFICALLY DISCLAIMS ALL OTHER WARRANTIES, EXPRESS OR IMPLIED, INCLUDING BUT NOT LIMITED TO THE IMPLIED WARRANTIES OF MERCHANTABILITY AND FITNESS FOR A PARTICULAR PURPOSE.

**BACKFLOW
PREVENTER**

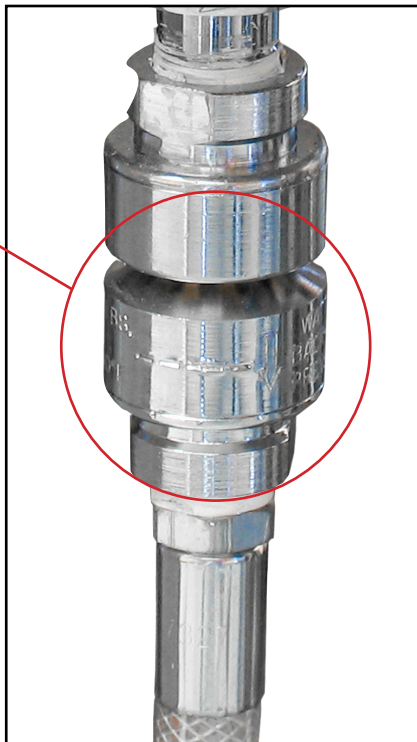

**BACKFLOW
PREVENTER**

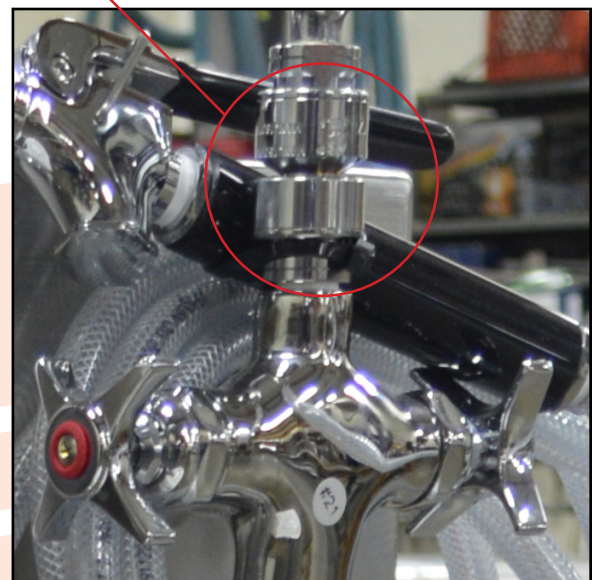

1036-13 Stainless Steel
Flush Embalming Station

Standard Design Components

DOUBLE PANTRY MIXING FAUCET
with 18 INCH SWING NOZZLE

T&S MODEL #B-0270

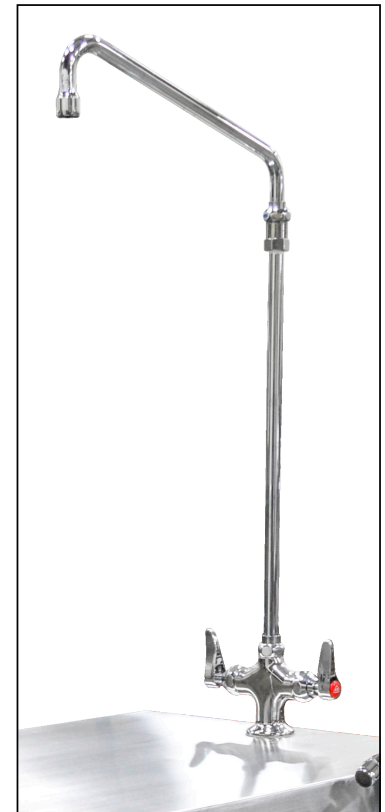
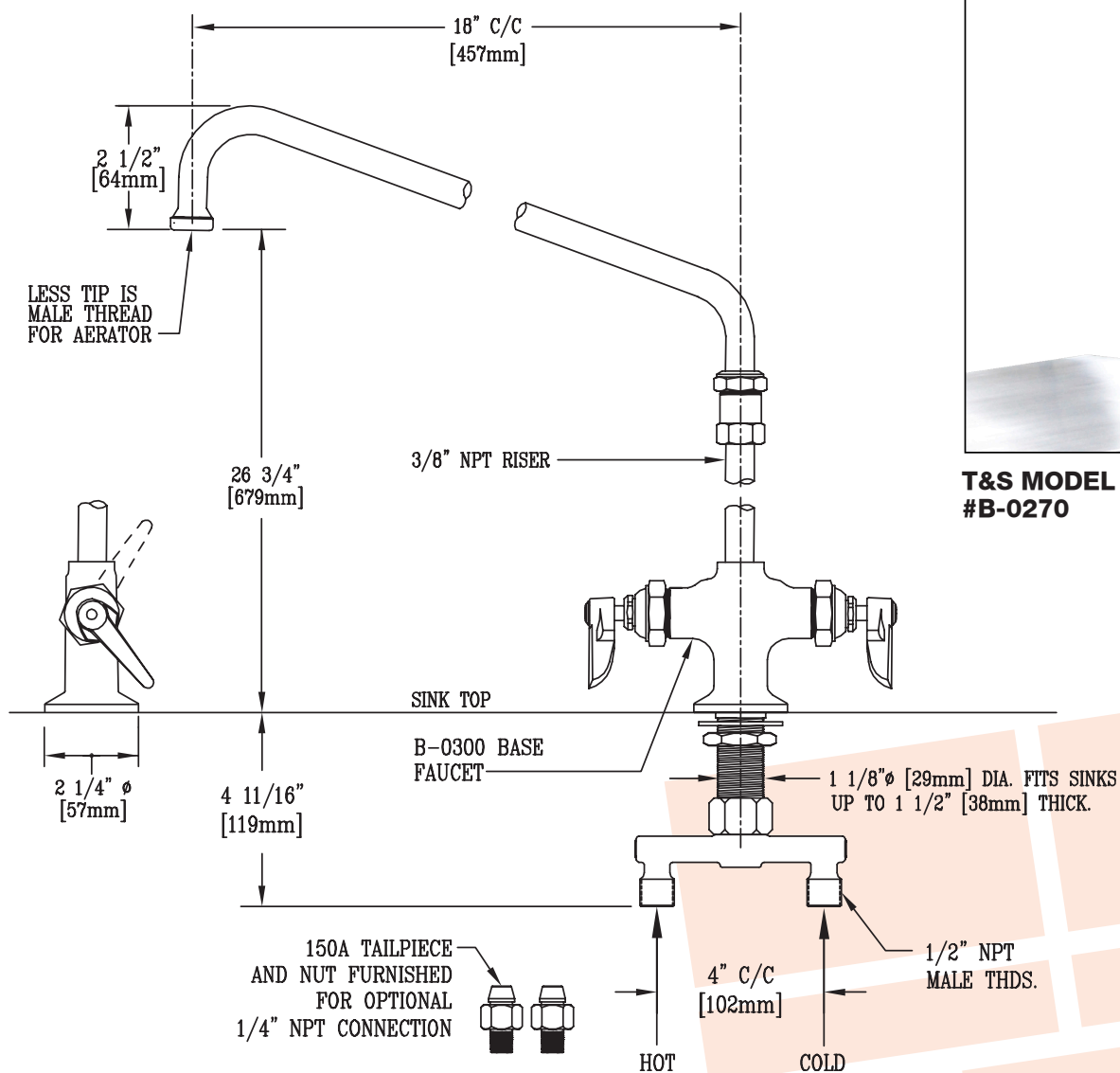

T&S MODEL
#B-0270



ADA COMPLIANT

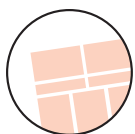

HYDRO-ASPIRATOR

A - VACUUM 3/4-11.5 FAUCET THREAD

B - 1.500-28 THREAD

C - 1/8-27 NPS PIPE THREAD

D - 3/4-32 THREAD

OVERALL ASSEMBLY LENGTH = 5.750 INCHES

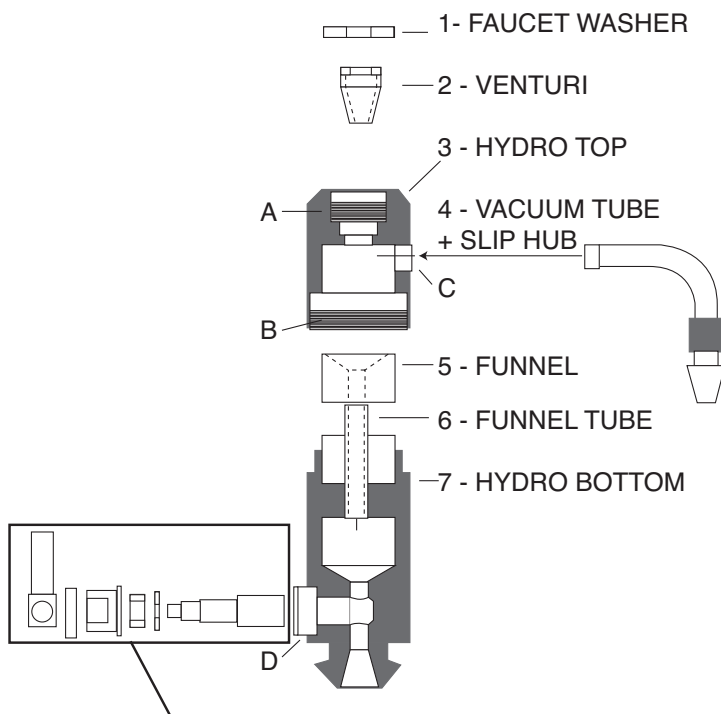

8 - HANDLE + 8-32 SET SCREW

9 - LOCKING RING

10 - GLAND NUT

11 - GRAPHITE PACKING

12 - O-RING

13 - VALVE

Mandatory operation requirements:

- Minimum 1/2" supply line
- Minimum 60 lbs of water pressure
- Minimum 4 gallons per minute of water flow through unit

Vacuum up to 26 inches can be maintained at these pressures. Trocar or aspiration line is attached to the aspiration tube. Diverter handle at lower end must be parallel to length of body of aspirator. To back flush the trocar/aspiration line, turn the diverter handle perpendicular to the length of the aspirator. Tubing can be added to the outlet bottom of the aspirator to direct the flow of water into the sink drain.

Reorder No. LW480



1036-13 Stainless Steel Flush Embalming Station

Standard Design Components

VACUUM BREAKER

Size: 3/4" (20mm) thread

Vacuum Breaker is a line of unique vacuum breakers specially made to permit the attachment of portable hoses to hose thread faucets. Designed to prevent the flow of contaminated water back into the potable water supply, these devices require no plumbing changes, and screw directly onto a sill cock.

Features

- Stainless steel working parts for longevity
- Durable rubber diaphragm and disc for consistent positive seating

Use only with approved hose bibbs or hose fittings having four or more full American National Hose (NH) threads.

Capacity

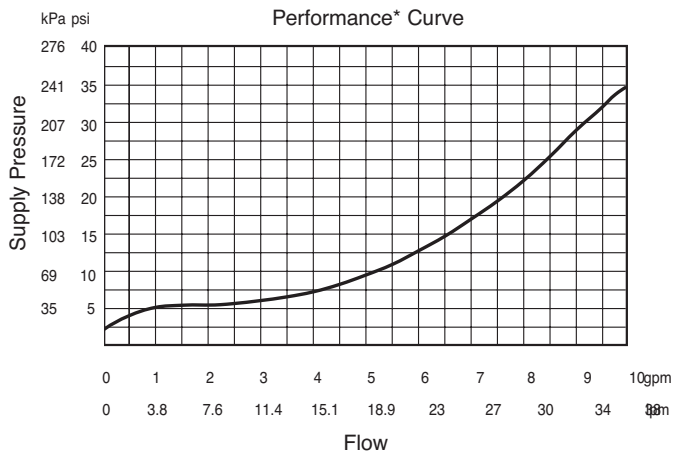

Dimensions – Weights

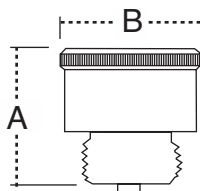

MODE	SIZE (DN)		DIMENSION				WEIGHT	
	In.	mm	A		B		oz.	gm.
8B	3/4HT	20	1/2	38	1 3/8	35	4.0	113.4

Installation

Thread Vacuum Breaker onto Aspirator, tighten. Vacuum Breaker is secured by tightening the set screw.

To Drain

Vacuum Breaker can be drained to prevent freezing by removing and pulling down gently on the stem.

IMPORTANT

Do not use with continuous pressure or use where discharge of water could cause damage.



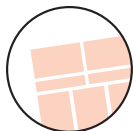

LIQUID-TUFF™ (Type LFNC-B)

Technical Specifications

UL Liquidtight Flexible Non-Metallic Conduit

Scope

This specification covers AFC Cable Systems, Inc. UL LIQUID-TUFF™ Integral Liquidtight Flexible Non-Metallic Conduit, Type LFNC-B designed for use in wet, dry or oily locations as a flame resistant, non-metallic raceway for power, control and communications cables in compliance with Article 356 of the National Electrical Code. The product is UL Listed for 80°C (176°F) in a dry location, 60°C (140°F) in a wet location and 70°C (158°F) in an oily location. It is also UL Listed through 2-inch trade sizes for direct burial, outdoor use and sunlight resistance. In addition the product is CSA certified for use at 75°C (167°F) in dry and oily locations and for minus 18°C (0°F) low temperature applications. This Liquidtight Flexible Non-Metallic Conduit is manufactured and tested in accordance with Underwriters Laboratories Inc. Standard UL 1660 and CSA International Standard CSA C22.2 Number 227.2. The product carries the UL Listing Mark and the CSA Certification Mark.

Construction

Liquidtight Flexible Non-Metallic Conduit, Type LFNC-B is a raceway of circular cross section with a smooth polyvinyl chloride (PVC) inner surface and an integral reinforcing member within the conduit wall. The wall thicknesses and dimensions of the integral conduit shall comply with Table 6.4 of UL 1660 and Table 1B of CSA C22.2 No. 227.2 which are summarized in Table 1.

Grounding

A separate Grounding conductor is required by both the National Electrical Code and the Canadian Electrical Code for all trade sizes.

Markings

The outer surface of the conduit shall be clearly marked with a legible print legend in accordance with UL 1660 and CSA C22.2 No. 227.2.



Performance Tests

The completed UL LIQUID-TUFF™ Liquidtight Flexible Non-Metallic Conduit, Type LFNC-B shall meet all of the performance requirements contained in UL 1660 and CSA C22.2 No. 227.2 and outlined in Appendix A.

- Package lengths in excess of 100' contain splices; these splices must be cut out before use.

Reference Standards

UL 1660	Standard for Liquidtight Flexible Non-Metallic Conduit
CSA C22.2 No. 227.2	Standard for Flexible Liquidtight Non-Metallic Conduit
UL File References	UL E123464; CSA 69271
NEC® Articles:	356, 390.15, 501.10(B)(2), 502.10(A)(2), 503.10(A)(2), 511.7(A)(1), 620.21, 645.5(D)(2), 680.21, 680.23, 680.25, 680.27, 680.42, 695.6(E) and 695.14(E)

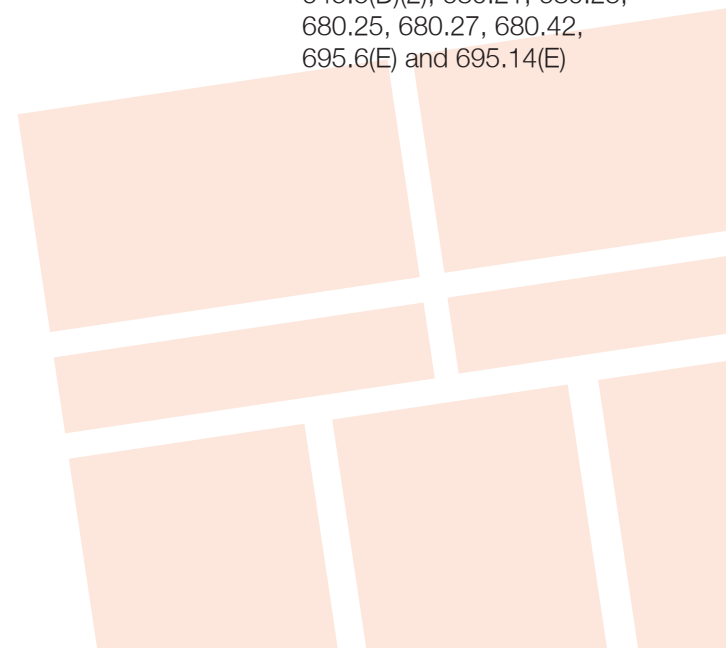

1036-13 Stainless Steel Flush Embalming Station

Standard Design Components

GFCI

Features and Benefits:

Lockout Action

- Automatically tests every time the RESET button is pushed.
- The trip latching mechanism in SmartLockPROGFCIs is a one-piece "T" design for efficient operation
- There are 4 sets of contacts for load terminals and face. SmartLockPROGFCIs use a patented bifurcated bridge contact for efficient operation
- The SmartLockPROGFCI with lockout action is designed and patented by Leviton
- Expanded wiring options with nine back-wire holes (two for each line and load connection plus one for ground with an internal clamp)
- Silver alloy contacts
- Versions available with matching TEST and RESET buttons and traditional black and red models
- Compatible with all Decora® devices and wallplates; available in select Decora colors

General

- Trip threshold meets or exceeds UL requirements for tripping time
- Improved immunity to high-frequency noise reduces nuisance tripping
- Impact-resistant thermoplastic cover and body
- Advanced electronics design provides superior resistance to electrical surges and over-voltages

- Hospital Grade and Blank Face Switch-Rated models available
- Packed with coordinating wallplate
- Backed by Leviton's Limited Two-Year Warranty
- Agency Standards & Compliance:
- Meet or exceed all new UL requirements for July 28, 2006
- UL Standard 943 Class A (GFCI) and 498 (Receptacles)
- UL Listed (File # E-48380)
- CSA Certified (File #LR-57811)
- NOM Certified (File #057)

Material Characteristics

Environmental: Flammability UL-94 V2 Rating

Operating Temperature: -35°C to 65°C

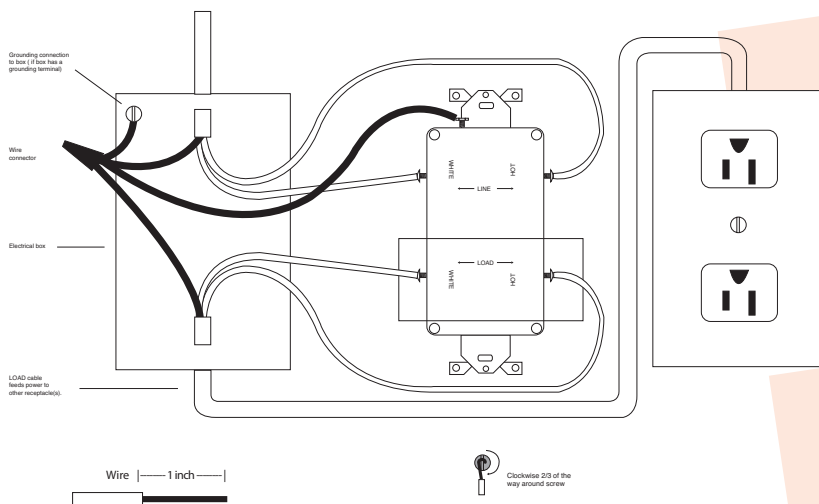
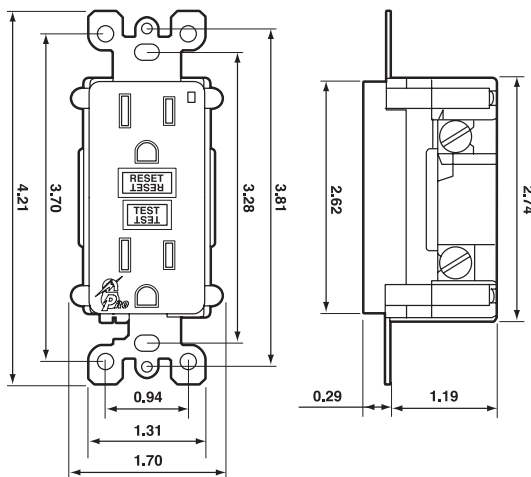

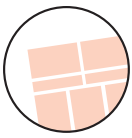

RECEPTACLE COVER

Type: Vertical

Color: Gray

- Heavy Duty Die Cast Metal Construction
- Patented Quick-Fit™ Key Hole Mount for Easy Installation
- Patented Universal-Fit™ Adapter Technology
- Lockable Tab
- Premium Powdercoat Finish
- Spring Hinge Closure
- UL Listed & 2008 NEC Compliant



Diagram: Vertical GFCI Installation

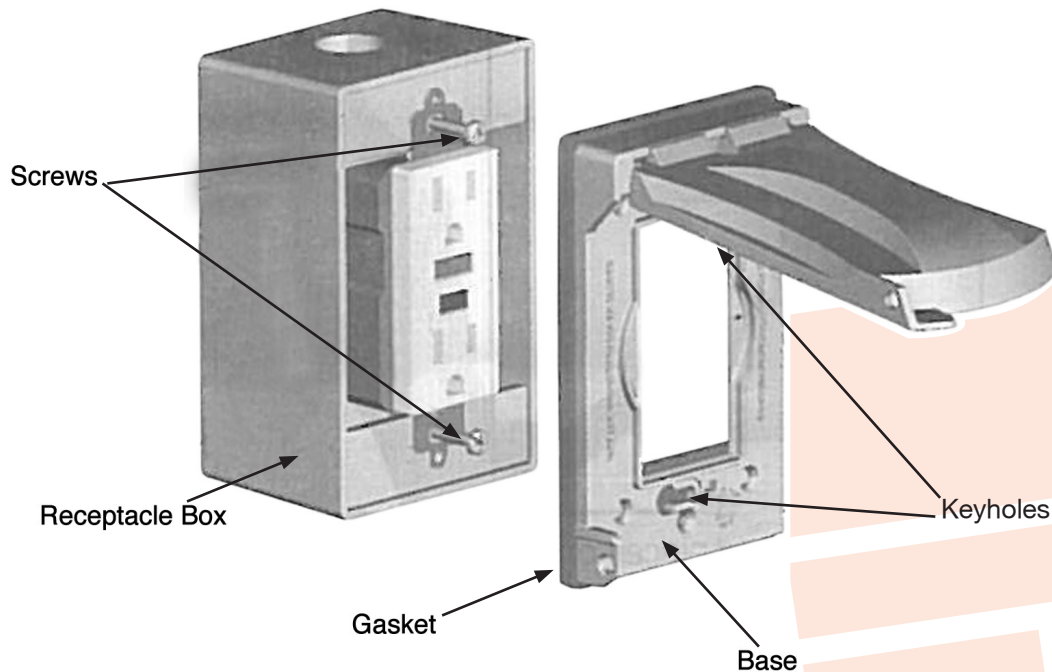

Stainless Steel Equipment Maintenance

MAINTENANCE INSTRUCTIONS

The unit requires regular maintenance and follow the manufactures directions.

DISINFECTING AND CLEANING

Clean all surfaces of the stainless steel with a hard surface disinfectant/cleaner such as Sheila Shine® or SaniZene®. Follow instructions on container.

DISINFECTING, CLEANING COMPONENTS & ACCESSORIES

Hand wash with disinfecting soap and warm water. Rinse well with clear water and dry with a towel. (Clean on a regular basis to prolong work life).

WARNING Improper maintenance can cause injury. Maintain only as prescribed in this manual. Overall, it is very simple to maintain. If you use for its intended purpose, it will provide many years of reliable service.

CARE OF STAINLESS STEEL

Stainless steel products have a directional #4 brushed finish. This finish is produced using a very fine abrasive cloth. Dragging heavy equipment across the stainless steel surfaces will cause noticeable scratching. Pitting/corrosion can occur when carbon steel products are allowed to remain in contact with the stainless steel in the presence of moisture. (Examples- Steel Wool pads left in the bottom of the sink). Stainless steel can be damaged by exposure to acids.

TYPES OF SURFACE CONTAMINANTS

Dirt - Consist of accumulated dust and a variety of contaminants. Warm water with or without a gentle detergent is sufficient. Next in order are mild non-abrasive powders such as typical household cleaners. These can be used with warm water, bristle brushes, sponges, or cleaning cloths. (Do not use carbon steel brushes or steel wool they may leave particles embedded on the surface which can lead to RUSTING.) For more aggressive cleaning, a small amount of vinegar can be added to the scouring powder. When water contains mineral solids, which leave water spots, it is advisable to wipe the surface completely with dry towels.

Fingerprints and Stains - Fingerprints and mild stains resulting from normal use are the most common surface contaminates. This affect the appearance and seldom have an effect on corrosion resistance. They can be removed with a glass cleaner or by gentle rubbing with a paste of soda ash (sodium carbonate) and water applied with a soft rag. Followed by a thorough warm water rinse and towel dry.

Shop Oil and Grease - These soils may be corrosive and may not allow the surface to maintain passivity, and so removal is a necessity. Soap or detergent and water may be used or a combination of detergent and water plus a solvent.

TYPES OF CLEANERS AND METHODS

General Precautions Avoid using abrasive cleaners unless absolutely necessary. A "soft abrasive," such as pumice, should be used. Many cleaners contain corrosive ingredients, rinse with clean water.

Clean Water and Wipe - A soft cloth and clean warm water should always be the first choice for mild stains, loose dirt and soils. A final rinse with clean water and a dry wipe will eliminate the possibility of water stains.

Solvent Cleaning - Organic solvents can be used to remove fresh fingerprints, oils and greases that have not

had time to oxidize or decompose. The preferred solvent is one that does not contain chlorine, such as acetone, methyl alcohol, and mineral spirits.

EFFECTIVE CLEANING METHODS

Commercial Cleaners - Many commercial cleaners compounded from phosphates, synthetic detergents, and alkalis are available for the cleaning of severely soiled or stained stainless surfaces. When used with a variety of cleaning methods, these cleaners can safely provide effective cleaning.

SCRATCH REPAIR

Surface scratches can be repaired using the following technique. Depending on the severity of the scratch, it may be possible to completely remove it. Sand the scratch using 120 grit emery cloth or paper and firm pressure. Always sand in the direction of the grain. Avoid the natural tendency to sand in an arc, instead sand in a perfectly straight line. Sand until the scratch is gone. Polish using 3M Scotch Brite pads - Very Fine Grade. Use the same motions as with sanding. Polish until the original finish is restored. Wash and wipe the surface completely with dry towels.

RUST REMOVAL

Rust can be repaired using the following technique. Sand the scratch using 120 grit emery cloth or paper and firm pressure. Always sand in the direction of the grain. Avoid the natural tendency to sand in an arc, instead sand in a perfectly straight line. Sand until the rust is gone. Polish using 3M Scotch Brite pads - Very Fine Grade. Use the same motions as with sanding. Polish until the original finish is restored. Wash and wipe the surface completely with dry towels.

5 Stainless Steel Mistakes NOT to Make When Cleaning

1. Do not use abrasive cleaners that will scratch the surface. Depending on the surface finish of your stainless steel, abrasive cleaners can cause scratching. A dull finish, probably will not show scratching as much as mirror or highly polished finishes. Test the cleaner in a hidden spot. It's also a good idea to work from the least risky type (water) of cleaning to the heavy duty stuff.

2. Do not forget to rinse. Gritty or dirty water can leave a residue on your finish. It can also stain or pit the surface of your stainless steel. Rinse completely. Residue from cleaning solutions left on a stainless steel surface can stain or damage finish.

3. DO NOT USE CLEANERS CONTAINING CHLORINE.

While it may be second nature to bleach everything, stainless steel and chlorine do not mix. Stay away from the bleach when you clean stainless steel. Be aware that bleach can be included in different types of cleaners. If you accidentally get a cleaner on your stainless steel you'll need to rinse it off and quickly.

4. DO NOT USE STEEL WOOL OR STAINLESS BRUSH

These products leave little particles in the surface of the steel and inevitably these particles begin rusting and staining the surface of the steel. They also can excessively scratch the surface of your stainless steel. *Stay completely away from steel wool and steel brushes.*

5. Do not assume it's the cleaner. If you do have some spotting or staining, and you've followed all of the rules, it may not be the stainless steel cleaner. Water, especially hard water, can leave spotting and staining on stainless steel surfaces. Towel dry after rinsing can end the problem. Sometimes, even water is an enemy to stainless steel.

[illegible]

[illegible]

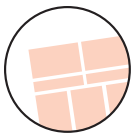

Warranty

WARRANTY

Mortech Manufacturing, Inc. warrants all fabrications to be free of defects due to its own workmanship and materials.

CONTINENTAL UNITED STATES:

Repair and/or replacement of materials furnished that may develop such defects, will be warranted for a period of one year from the date of shipment. Items not manufactured by Mortech Manufacturing, Inc. will receive the manufacturer's warranty.

INTERNATIONAL:

(For validation of warranty, installation location (physical address) required) Replacement of parts furnished that may develop such defects, will be warranted for a period of (18) months from the date of shipment. Shipping and Labor is not warranted. Items not manufactured by Mortech Manufacturing, Inc. will receive the manufacturer's warranty.

PARTS AND SERVICE

Customer relations and product support are important aspects of Mortech Manufacturing, Inc.

For assistance with this or any of our fine products please contact us below:

Mortech Manufacturing, Inc.

411 North Aerojet Avenue

Azusa, CA 91702

TEL (626) 334-1471

FAX (626) 334-1704

www.mortechmfg.com

info@mortechmfg.com

© COPYRIGHT MORTECH MANUFACTURING, INC.,
ALL RIGHTS RESERVED.

CAUTION

**Inspect unit and all components
for any loosening that may have
occurred during shipping**

ATTENTION

All images and Drawing in this manual
may not represent your model.
Refer to your particular project for
exact specifications

DISCLAIMER

This manual contains general instructions for the use, operation, and care of this product. The instructions are not all inclusive. Safe and proper use of this product is solely at the discretion of the user. Safety information is included as a service to the user. All other safety measures taken by the user should be within and under consideration of applicable regulations. It is recommended that training on the proper use of this product be provided before using this product in and actual situation.

Retain this manual for future reference. Include it with the product in the event of transfer to new users. Additional free copies are available upon request from Customer Relations.

Mortech Manufacturing, Inc. has made every effort to ensure that this Manual is accurate; Mortech Manufacturing, Inc. abdicate liability for any inaccuracies or omissions that may have occurred.

Information in this Manual is subject to change without notice and does not represent a commitment on the part of Mortech Manufacturing, Inc. Mortech Manufacturing, Inc. assumes no responsibility for any inaccuracies that may be contained in this Manual. Mortech Manufacturing, Inc. makes no commitment to update or keep current the information in this Manual, and reserves the right to make improvements to this Manual and/or to the products described in this Manual, at any time without notice.

If you find information in this manual that is incorrect, misleading, or incomplete, we would appreciate your comments and suggestions.

PROPRIETARY NOTICE

The information in this manual is the property of Mortech Manufacturing, Inc. Mortech Manufacturing, Inc. reserves all patent rights, proprietary design rights, manufacturing rights, reproductions rights, and sales use rights thereto, and to any article disclosed therein except to the extent those rights are expressly granted to others or where not applicable to vendor proprietary parts.

