



MODEL 1036-2
WALL MOUNTED
SERVICE STATION

CAUTION

- Inspect unit and all components for any loosening that may have occurred during shipping •

ATTENTION

Review entire manual before starting assembly

ATTENTION

All images and Drawing in this manual may not represent your model. Refer to your particular project for exact specifications

CAUTION

- DO NOT USE CLEANERS CONTAINING CHLORINE WHEN CLEANING STAINLESS STEEL •

WARNING

Biohazard Label is place on the equipment signifying the potentially infectiousness due to the samples or reagents





It is important that the information provided in this manual is observed. These instructions should be read carefully and observed fully before installation and initial operation.

WARNING

It is crucial that any work performed on Mortech Mfg. Inc. manufactured items are carried out exclusively by skilled professionals who have the respective training. Improper use, maintenance, parts and service, or modification to the equipment may cause injury and/or damage. Use and maintain the equipment only for the purpose described in this manual. Use only prescribed approved parts and service. Use the equipment only as designed by Mortech mfg. Inc.

BLOODBORNE DISEASE NOTICE

To reduce the risk of exposure to bloodborne diseases such as HIV-1 and hepatitis when using the equipment, follow the disinfecting and cleaning instructions in this manual.

OPERATING SKILLS AND TRAINING SKILLS

Operators using the equipment needs

- ☐ A working knowledge of necessary procedures.
- ☐ The ability to carry out necessary service procedures.
- ☐ A complete understanding of the procedures described in this manual.

TRAINING

- ☐ Be trained on the use of the equipment.
- ☐ Read the manual
- ☐ Practice with the equipment before using it in regular service.
- ☐ Be tested on their understanding of the equipment operation.
- ☐ Record their training.

BEFORE USING THE UNIT

Personnel working with this unit needs to read this manual. Assemble of the unit following instructions, and perform any pre-service checks to confirm the units operates properly.

INSPECTING THE UNIT BEFORE USE

Please take time to inspect all shipment prior to signing delivery ticket. If concealed damage is discovered, save the carton and immediately contact carrier agent to initiate claim of damage.

BE SURE TO CHECK

- Are all components present?
- Do the moving parts operate smoothly?
- Is unit draining properly?
- Are all nuts, bolts, and pins secured in place?
If unit has an issue contact customer relations.

INSTRUCTION FOR HANDLING

Adhere to state and/or local certification and regulations for operation of forklift and/or pallet jack. Cargo is extremely heavy, be sure to have the necessary manpower as well as equipment to successfully unload shipment from truck. We recommend a forklift and/or pallet jack with the capacity to lift up to 2000 lbs. to remove cargo from truck.

The forklift can be used to unload receiving products safely by placing the load on the floor, maneuvering the forklift into position, tilting the mast forward to vertical position so the load will be level, lowering the load, and smoothly backing away without dragging. Once cargo is unloaded, positioning unit for installation will once again require a forklift. Read all manual and note on installation of the unit before installing.

The pallet jack can be used (with a loading dock and maneuverability on and off the transport vehicle) to unload receiving products safely. Maneuvering the pallet jack into position (in the appropriate position within the pallet), lifting the pallet then driving the pallet jack off the truck and safely into the place of installation.

Range of Environmental Condition

Mortech Mfg. Inc. equipment shall be placed in a controlled environment (housing or housed unit) hindering the weathering effects on the installed units. The units will have minimal corrosive and eroding factors that can break down the stability and operation of Mortech's equipment. The impact on the unit by the operator utilizing water or corrosives in the medical procedures can be controlled and responsibility for the cleaning and maintenance placed upon that person. The effects of anthropogenic (man-made) gasses on the environment, such as carbon dioxide (CO₂) that will be omitted from the unit should be minimal.

Due to continuous innovation and product development this installation guide is subject to change without notice.

Please save these instructions for later use.

MOUNTING INSTRUCTIONS

Step 1. Verify all utility rough-ins have been supplied in the proper location and per the project specifications. Drawings from Mortech for utilities are provided with the submittal packet information. Utilities can include: water lines, electrical, drain etc.

Step 2. Mount Z-Clip to support structure and .Before mounting to finished wall, a bead of caulking can be utilized for sealing the unit.

Step 3. Use mounting anchors appropriate for support structure. Mounting holes can be access through front access panel

If predrilled, line holes and mount to wall.

Mount to strong and sturdy studs or wall supports.

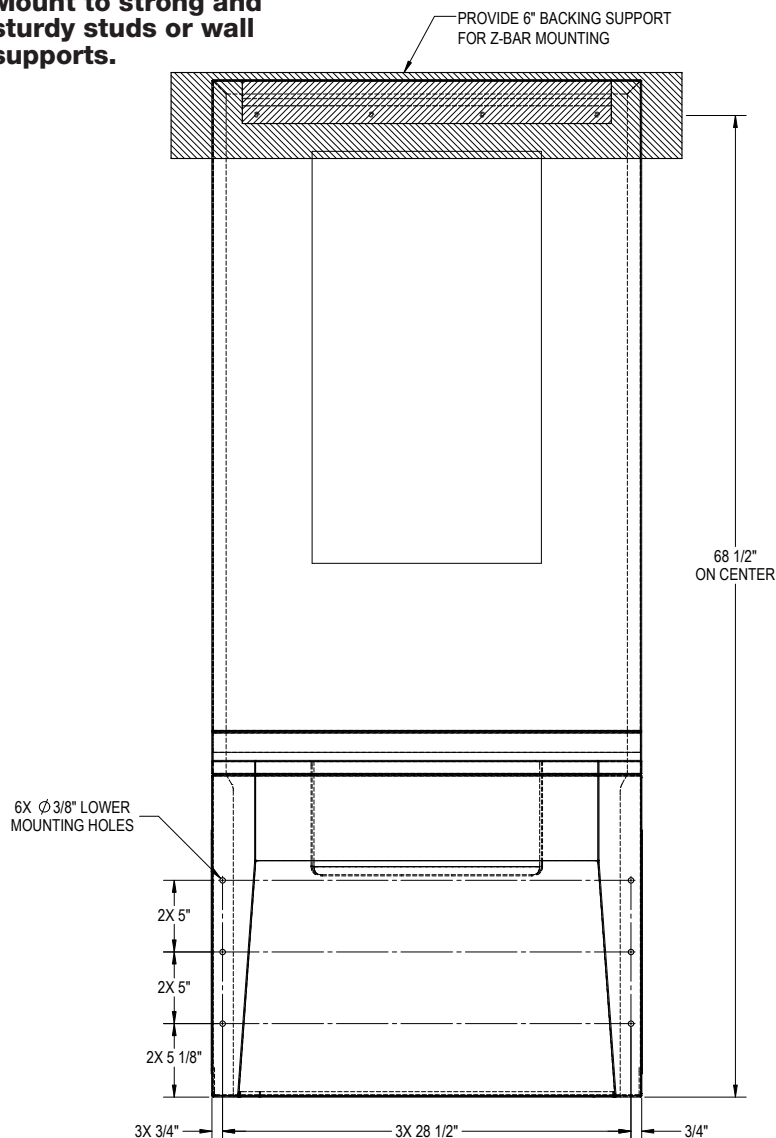

MOUNTING HOLES

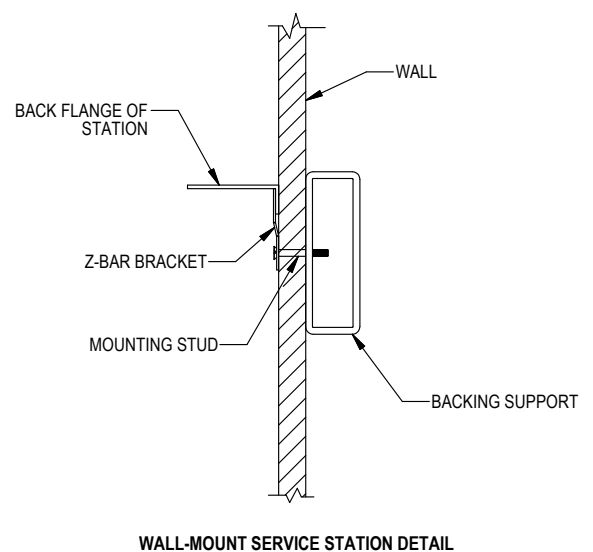

WALL-MOUNT SERVICE STATION DETAIL



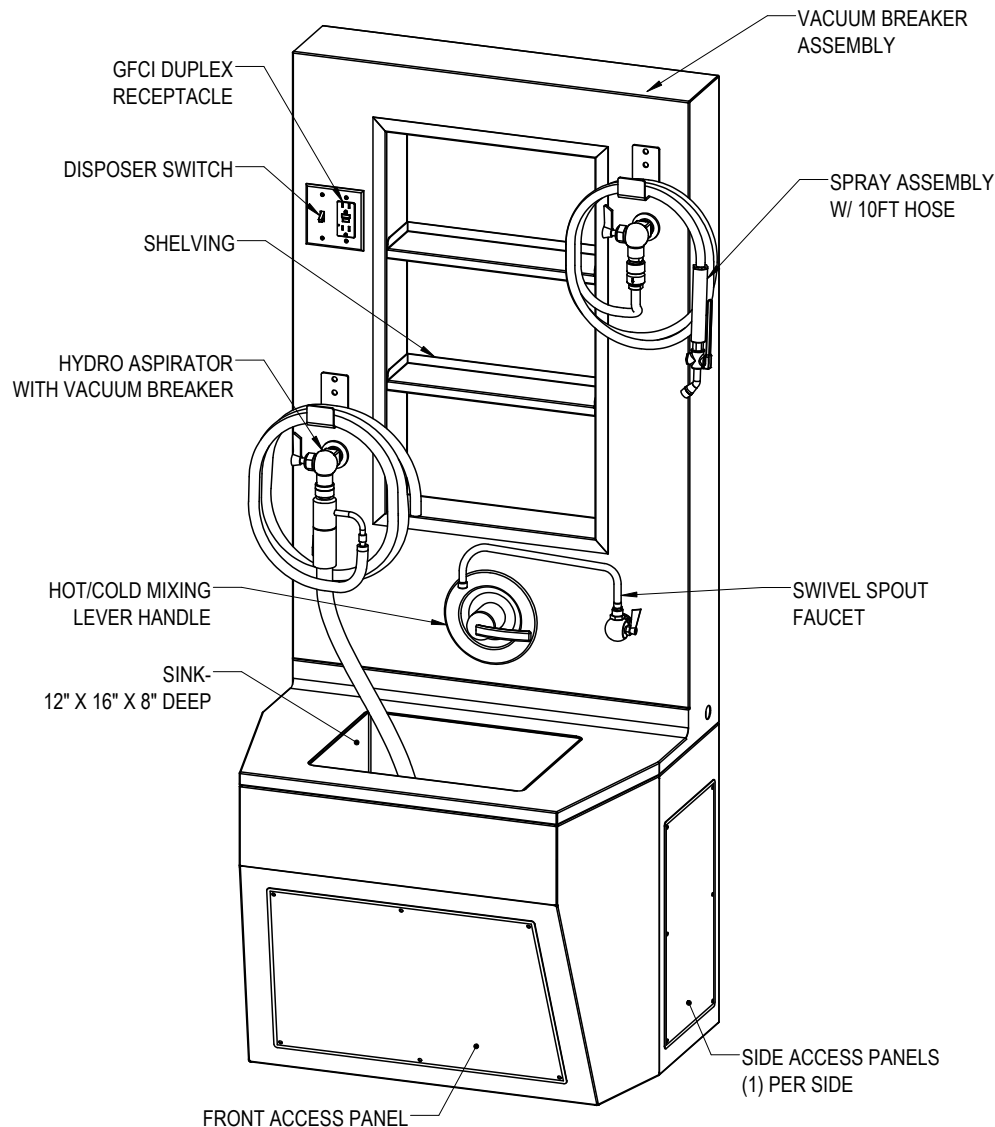

Standard Design Features:

- Stainless Steel Sink
- Electric Waste Disposal Unit
- Hot and Cold Water Tempering unit with Lever Handle
- Central Lever self closing pre-rinse valve with 10 ft. flexible vinyl hose
- Utility Faucet with Elbow Handle and Swivel Spout
- Electrical outlet
- Deluxe Aspirator with reverse flow for additional waste removal: "reverse flow" feature instantly relieves suction clogging by providing a reverse pressure of water.
- Open Stainless Steel Shelving designed for storage of chemical bottles.

- 1036-2SE includes Emergency Shower and Eyewash Assemblies

The Wall Mounted Service Station is fabricated of stainless steel with all plumbing and electrical hook-ups designed for easy installation. The unit is completely equipped with all the best quality chrome and stainless steel fixtures and accessories to improve efficiency and reduce operating cost.

Specifications:

Height: 71 in.
Length: 30 in.
Depth: 23.5 in.

PLUMBING CONNECTION INSTRUCTIONS

STEP 1: (Refer to Figure-G) Flush out all water lines prior to connection. Debris may be in the lines from construction process. Install shut off valves on each water line. Lines are clearly marked RED for hot and BLUE for cold.

The station is provided with a single point connection for hot and cold water. A typical flex line can be used for connection.

Step 2: Connect drain line to sink basin or disposal unit, depending on the option provided. (Refer to Figure-H) See Disposal manufacturers manual.

Figure-G

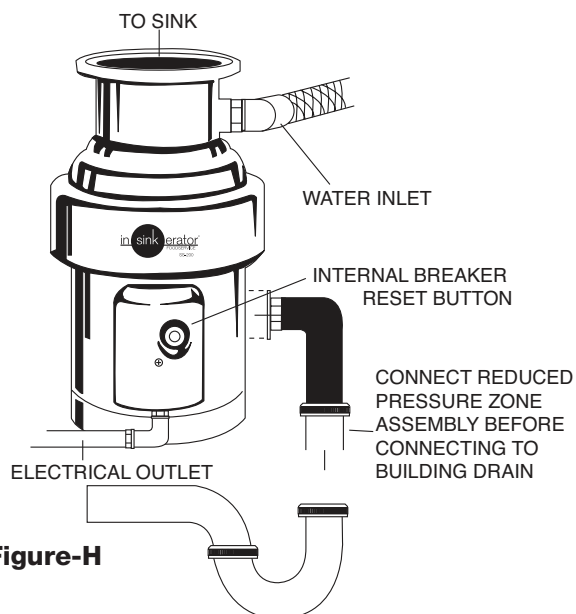
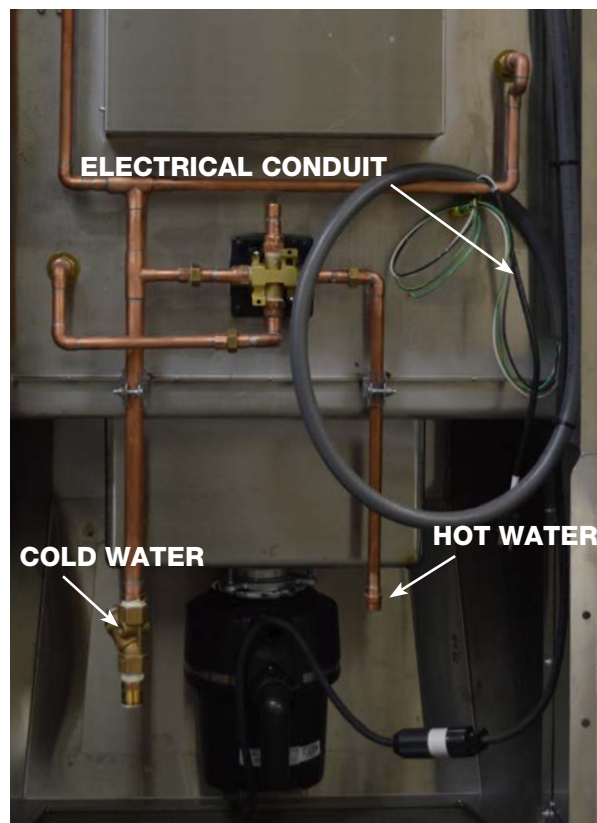
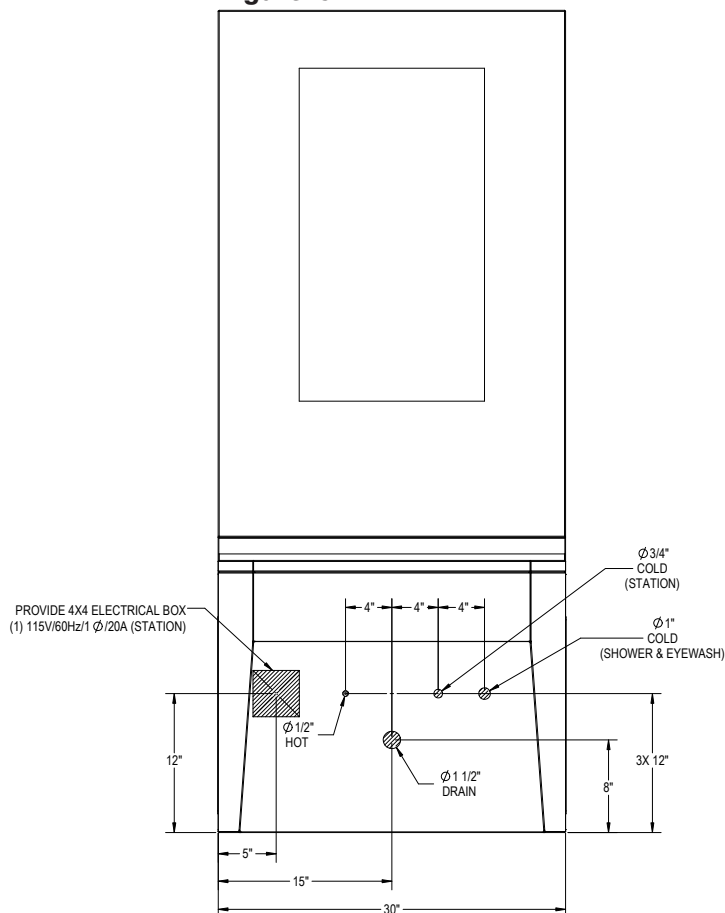

Figure-H



Removable Shelf

Stainless removable shelf to access plumbing for adjustments and maintenance



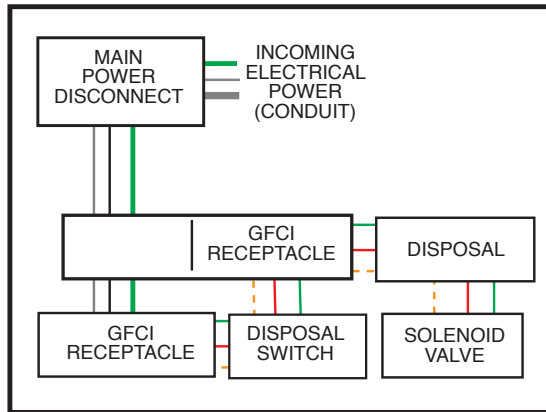

General contractor is recommended to provide:

- Waterproof load center with 1 circuit breaker disconnect with a 20 amps fuse (Circuit One) and 15 amps fuse (Circuit Two) and a point of contact for the unit to be installed.

Circuit One
Disposal units
.5 hp, 8.4A
.75 hp, 10.0A
1 hp, 11.6A
2 hp, 17.4A
(2) GFCI 20A

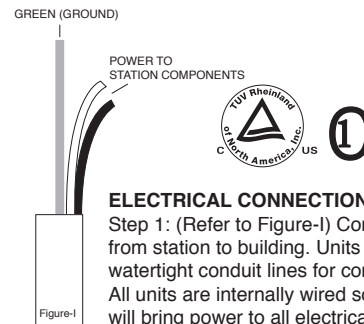

ELECTRICAL CONNECTION INSTRUCTIONS

Step 1: (Refer to Figure-1) Connect electrical lines from station to building. Units are provided with watertight conduit lines for connection.

All units are internally wired so connecting these lines will bring power to all electrical items on the station.

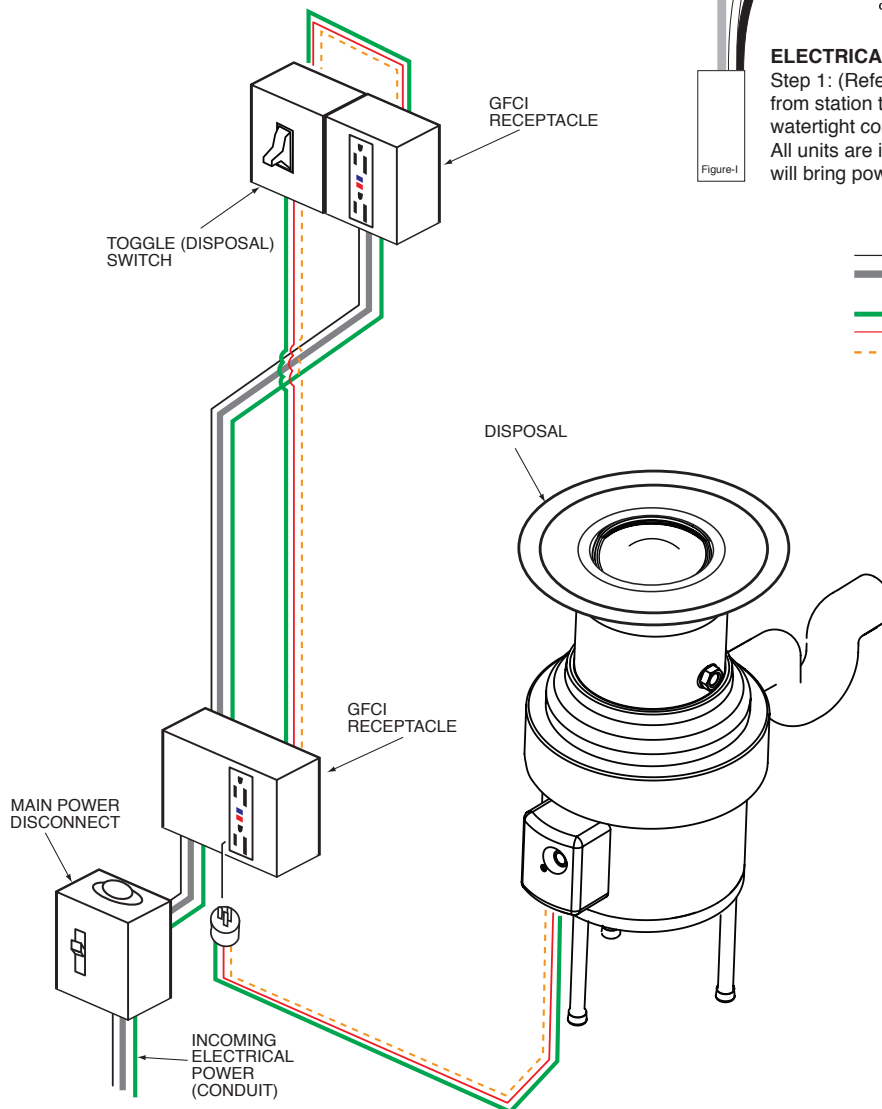

LC-50 LIGHT DUTY DISPOSER

IDEAL FOR LIGHT DUTY APPLICATIONS

- Coffee shops
- Convenience stores
- Quick service restaurants
- Assisted living or nursing stations
- Business & industry

PRODUCT OVERVIEW

- Foodservice design with the ease and flexibility of a household unit
- Disposer mounting included with unit fits standard 3-1/2" to 4" (88.9 mm to 101.6 mm) sink opening — no welding required!
- Standard wall switch operates the disposer
- Automatic reversing motor for longer life and trouble-free operation
- Stainless steel grind chamber
- Cast nickel chrome cutting element
- 35 lb. (15.9 kg) shipping weight
- 1/2 HP continuous-duty commercial motor
- 1725 RPM
- Single Phase

Disposal Switch
(shown right) allows you
to activate the Solenoid
(shown below) injecting
the flow of water to
the disposal.



ELECTRICAL SPECIFICATIONS

- ☐ LC50-11 – 120V, 60 Hz, 5.8 amps, **CUL**
- ☐ LC50-12 – 230V, 50/60 Hz, 375 watts
- ☐ LC50-13 – 220-240V, 50 Hz, 375 watts, **BEAB**, supplied with shuko plug
- ☐ LC50-14 – 120V, 60 Hz, 5.8 amps, **NOM**

IMPORTANT: The model LC-50 is designed specifically for **light duty** foodservice use. Use of this disposer in applications other than those named above may void your warranty. If you are unsure of a potential application, call the factory at 1-800-845-8345.

DIMENSIONS

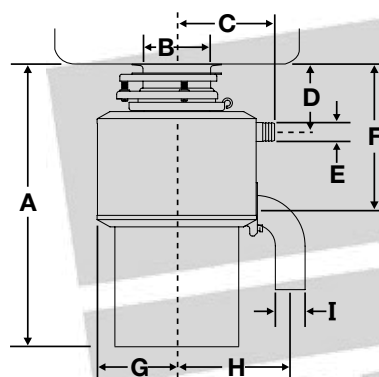

A	14-1/4"	361.9 mm
B	3-5/16" min. ID	85.1 mm
C	4-15/16"	125.2 mm
D	3-7/16"	86.8 mm
E	15/16" DIA	24.3 mm
F	7-3/8"	187.1 mm
G	4"	101.6 mm
H	5-3/4"	145.2 mm
I	15/16" ID	23.8 mm

NOTE: Plumb 1-1/2" (38.1 mm) waste line to prevent standing water in disposer motor housing.



SWITCH

20A, 120/277V, Grounding, Premium Single Pole Toggle Switch, UL, Federal Specification, CSA, Tested To 25000 On/Off Cycles, Screw Pressure Plate Back & Side Wire Termination Accepts #14 Through #10 Awg Stranded & Solid Copper Wire, High Impact Resistant Thermoplastic Constructions, Commercial/Specification Grade, Window Box.

Product Features:

Ground:	Grounding
Amperage:	20 Amp
Voltage:	120/277 Volt
HP Rating:	1HP-120V 2HP-240V-277V
Max Amp:	16 Amp
Termination:	Side
Actuator Material:	Thermoplastic
Body Material:	Thermoplastic
Strap Material:	Steel
Standards and Certifications:	UL/CSA

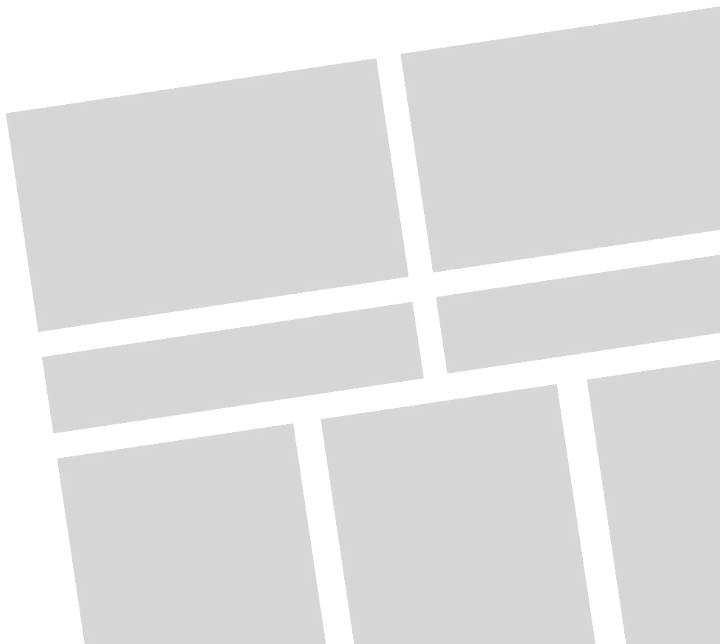
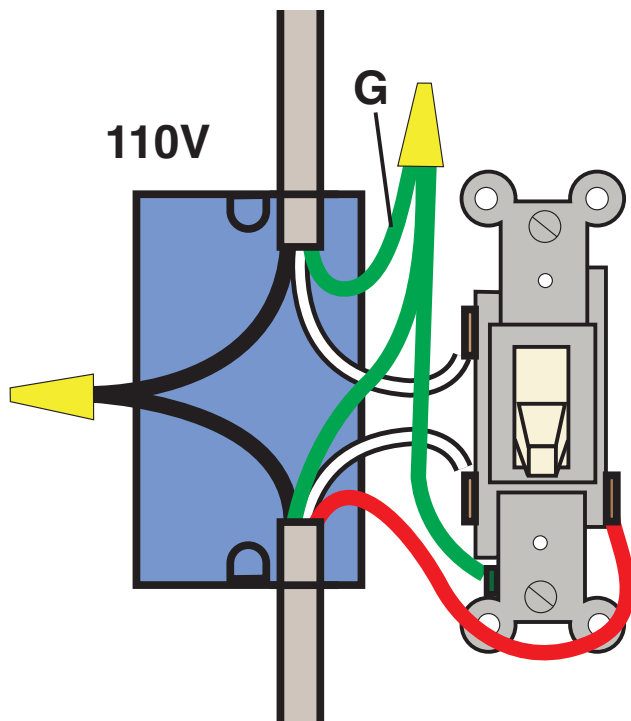

Features and Benefits:

Lockout Action

- Automatically tests every time the RESET button is pushed.
- The trip latching mechanism in SmartLockPROGFCIs is a one-piece "T" design for efficient operation
- There are 4 sets of contacts for load terminals and face. SmartLockPROGFCIs use a patented bifurcated bridge contact for efficient operation
- The SmartLockPROGFCI with lockout action is designed and patented by Leviton

General

- Trip threshold meets or exceeds UL requirements for tripping time
- Improved immunity to high-frequency noise reduces nuisance tripping
- Impact-resistant thermoplastic cover and body

- Advanced electronics design provides superior resistance to electrical surges and over-voltages
 - Expanded wiring options with nine back-wire holes (two for each line and load connection plus one for ground with an internal clamp)
 - Silver alloy contacts
 - Versions available with matching TEST and RESET buttons and traditional black and red models
 - Compatible with all Decora® devices and wallplates; available in select Decora colors
 - Hospital Grade and Blank Face Switch-Rated models available
 - Packed with coordinating wallplate
 - Backed by Leviton's Limited Two-Year Warranty
- Agency Standards & Compliance:
- Meet or exceed all new UL requirements for July 28, 2006
 - UL Standard 943 Class A (GFCI) and 498 (Receptacles)
 - UL Listed (File # E-48380)
 - CSA Certified (File #LR-57811)
 - NOM Certified (File #057)

Material Characteristics

Environmental: Flammability UL-94 V2 Rating

Operating Temperature: -35°C to 65°C

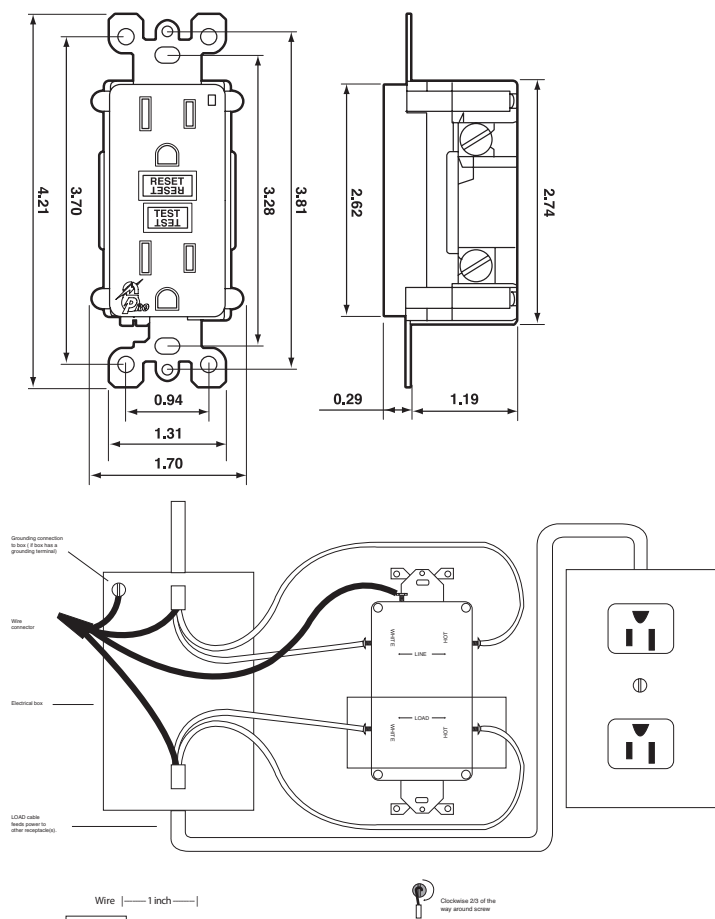

Technical Specifications

LIQUID-TUFF™

UL Liquidtight Flexible Non-Metallic Conduit
(Type LFNC-B)

Scope

This specification covers AFC Cable Systems, Inc. UL LIQUID-TUFF™ Integral Liquidtight Flexible Non-Metallic Conduit, Type LFNC-B designed for use in wet, dry or oily locations as a flame resistant, non-metallic raceway for power, control and communications cables in compliance with Article 356 of the National Electrical Code. The product is UL Listed for 80°C (176°F) in a dry location, 60°C (140°F) in a wet location and 70°C (158°F) in an oily location. It is also UL Listed through 2-inch trade sizes for direct burial, outdoor use and sunlight resistance. In addition the product is CSA certified for use at 75°C (167°F) in dry and oily locations and for minus 18°C (0°F) low temperature applications. This Liquidtight Flexible Non-Metallic Conduit is manufactured and tested in accordance with Underwriters Laboratories Inc. Standard UL 1660 and CSA International Standard CSA C22.2 Number 227.2. The product carries the UL Listing Mark and the CSA Certification Mark.

Construction

Liquidtight Flexible Non-Metallic Conduit, Type LFNC-B is a raceway of circular cross section with a smooth polyvinyl chloride (PVC) inner surface and an integral reinforcing member within the conduit wall. The wall thicknesses and dimensions of the integral conduit shall comply with Table 6.4 of UL 1660 and Table 1B of CSA C22.2 No. 227.2 which are summarized in Table 1.

Grounding

A separate Grounding conductor is required by both the National Electrical Code and the Canadian Electrical Code for all trade sizes.

Markings

The outer surface of the conduit shall be clearly marked with a legible print legend in accordance with UL 1660 and CSA C22.2 No. 227.2.



Performance Tests

The completed UL LIQUID-TUFF™ Liquidtight Flexible Non-Metallic Conduit, Type LFNC-B shall meet all of the performance requirements contained in UL 1660 and CSA C22.2 No. 227.2 and outlined in Appendix A.

- Package lengths in excess of 100' contain splices; these splices must be cut out before use.

Reference Standards

UL 1660	Standard for Liquidtight Flexible Non-Metallic Conduit
CSA C22.2 No. 227.2	Standard for Flexible Liquidtight Non-Metallic Conduit
UL File References	UL E123464; CSA 69271
NEC®Articles:	356, 390.15, 501.10(B)(2), 502.10(A)(2), 503.10(A)(2), 511.7(A)(1), 620.21, 645.5(D)(2), 680.21, 680.23, 680.25, 680.27, 680.42, 695.6(E) and 695.14(E)



Mortech™ Manufacturing Inc.

411 North Aerojet Avenue, Azusa, CA 91702
(626) 334-1471 www.mortechmfg.com



THIS VALVE MEETS OR EXCEEDS THE FOLLOWING STANDARDS: ANSI A112.18.1 and ASSE 1016.

CAUTION: This system/device must be set by the installer to ensure safe, maximum temperature. Any change in the setting may raise the discharge temperature above the limit considered safe and may lead to hot water burns.

NOTICE TO INSTALLER: CAUTION! – This valve does not automatically adjust for inlet temperature changes, therefore, someone must make the necessary Rotational Limit Stop adjustments at the time of installation and further adjustments may be necessary due to seasonal water temperature change. YOU MUST inform the owner/ user of this requirement by following the instructions below.

WARNING: It may not provide protection from hot water burns when there is a failure of other temperature controlling devices elsewhere in the plumbing system, if the rotational limit stop is not properly set or if the hot water temperature is changed after the rotational limit stop is set or if the water inlet changes due to seasonal changes.

CLEANING AND CARE

Care should be given to the cleaning of this product. Although its finish is extremely durable, it can be damaged by harsh abrasives or polish. To clean, simply wipe gently with a damp cloth and blot dry with a soft towel.

WARNING:

SCRUBBING BUBBLES® BATHROOM CLEANER and LYSOL® BASIN TUB AND TILE CLEANER must not be used on the clear knob handles and levers. Use of these cleaners can result in cracked or severely damaged handles. If over spray gets onto the handles, immediately wipe them dry with a soft cotton cloth.

INSTALLATION INSTRUCTIONS

1. SHUT OFF WATER SUPPLIES.

2. INSTALL VALVE so that arrows on bracket point upward. If you are making a shower installation only, plug bottom outlet of valve with pipe plug or copper plug.

3. CONNECT HOT AND COLD SUPPLY LINES to left and right inlets of valve body. Left is hot and right is cold. Sweat connections are 1/2" copper tube size (CTS). Remove the valve cartridge prior to soldering.

4. FOR SHOWERHEAD INSTALLATION connect top outlet to shower arm with proper fittings. To prevent damage to finish on shower arm, insert wall end of shower arm into shower flange before screwing arm into riser connection.

WARNING: Failure to follow these instructions could prevent the valve from functioning properly.

5. FLUSH YOUR SYSTEM This will remove any debris from the lines which can damage internal parts of the faucet and create leaks. After flushing, shut off water at faucet. Remove handle and attach escutcheon using screws. Attach showerhead.

6. ADJUSTING THE ROTATIONAL LIMIT STOP:

- Turn on water so that cold water is as cold as it will get and hot water is as hot as it will get. Place handle back on stem and rotate fully counterclockwise to the hottest position.
- Place a thermometer in a plastic tumbler and hold in the water stream. If the water temperature is above 120°F, the Rotational Limit Stop must be rotated counterclockwise to decrease temperature. In that case, remove the Rotational Limit Stop and replace it one tooth counterclockwise for every 6°F (approximate) reduction in temperature that must be made. Repeat as necessary.

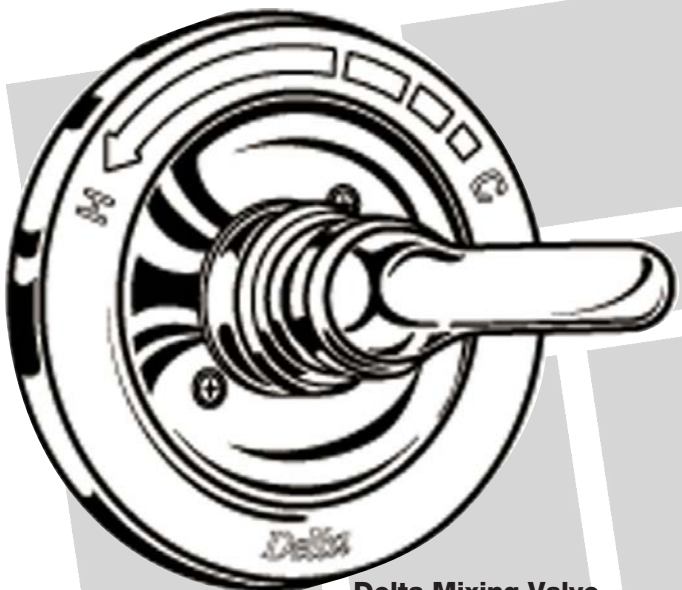

Delta Mixing Valve



Components Data

MAINTENANCE

Helpful Hints:

1. Before removing valve cartridge assembly for any maintenance, be sure to note the position of the stop on the cap. The valve cartridge assembly must always be put back in the same position. For normal installations, the stop on the cap will face the left. BE SAFE! After you have finished the installation, turn on valve to make sure COLD WATER FLOWS FIRST.

2. To remove valve cartridge from body, shut off water supplies and remove handle and bonnet nut. Do not pry the valve cartridge out of the body with a screwdriver. Place handle on stem and rotate counterclockwise approximately 1/4 turn after the stop has been contacted. Lift valve cartridge out of body.

3. To remove seats and springs, remove valve cartridge. Separate cap assembly from the housing assembly by rotating the cap assembly counterclockwise 90° (degrees). Separate cap and housing assemblies. Remove seats and springs and replace. Place the largest diameter of the spring into the seat pocket first and then press the tapered end of the seal over the spring. Reassemble valve cartridge and replace in body following instructions given in 1 above.

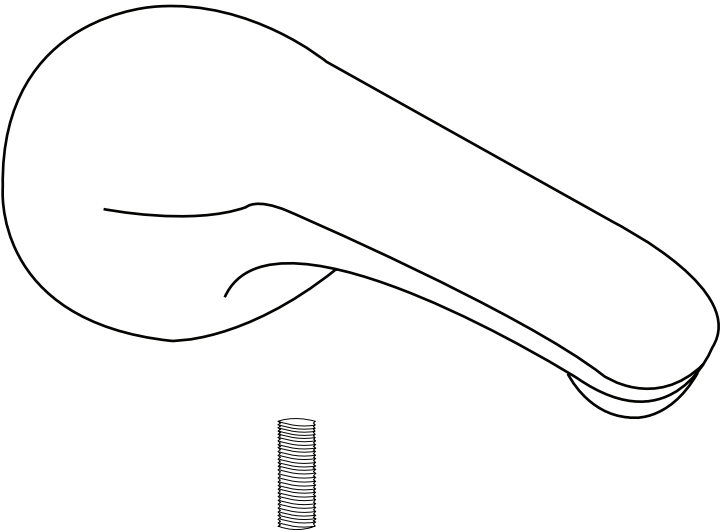

4. If the water in your area has lime, rust, sand or other contaminants in it, your pressure balance valve will require periodic inspection. The frequency of the inspection will depend on the amount of contaminants in the water. To inspect valve cartridge remove it and follow the steps in note 1 above. Turn the valve to the full mix position and shake the cartridge vigorously. If there is a rattling sound, the unit is functional and can be reinstalled following instructions given in note 1 above. If there is no rattle, replace the housing assembly (RP19805).

▲Specify Finish

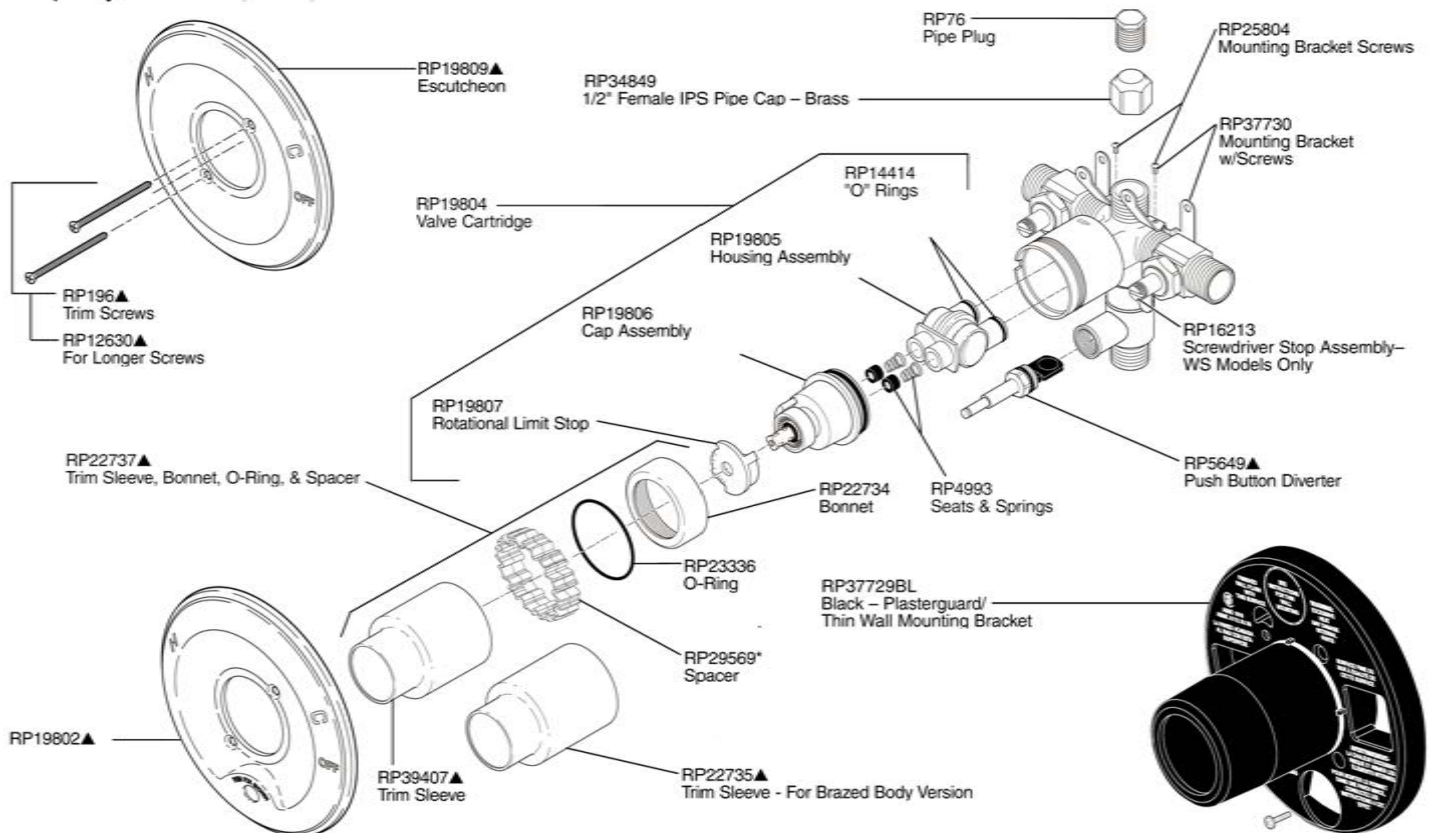

*See Handle Kit Instructions

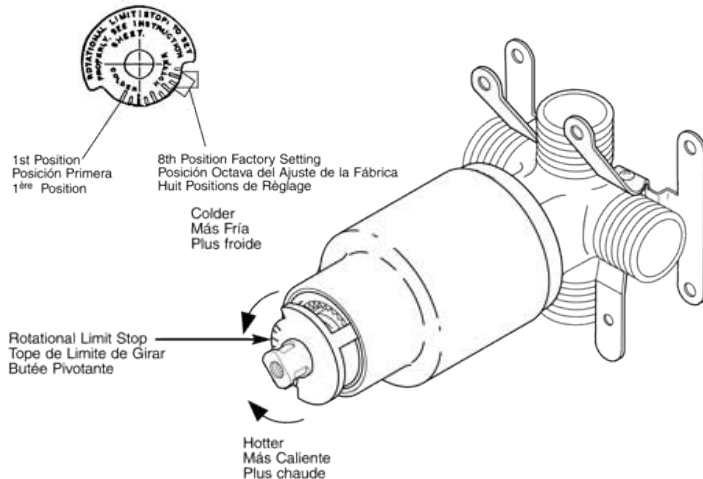

LIFETIME FAUCET AND FINISH LIMITED WARRANTY

All parts and finishes of the Delta® faucet are warranted to the original consumer purchaser to be free from defects in material & workmanship for as long as the original consumer purchaser owns their home. Delta Faucet Company recommends using a professional plumber for all installation & repair.

Delta will replace, **FREE OF CHARGE**, during the warranty period, any part or finish that proves defective in material and/or workmanship under normal installation, use & service. Replacement parts may be obtained by calling 1-800-345-DELTA (in the U.S. and Canada) or by writing to:

In the United States:
Delta Faucet Company
Product Service
55 E.111th Street
Indianapolis, IN 46280

In Canada:
Delta Faucet Canada
Technical Service Centre
420 Burbrook Place
London, ON N6A 4L6

This warranty is extensive in that it covers replacement of all defective parts and even finish, but these are the only two things that are covered. **LABOR CHARGES AND/OR DAMAGE INCURRED IN INSTALLATION, REPAIR, OR REPLACEMENT AS WELL AS ANY OTHER KIND OF LOSS OR DAMAGES ARE EXCLUDED.** Proof of purchase (original sales receipt) from the original consumer purchaser must be made available to Delta for all warranty claims. **THIS IS THE EXCLUSIVE WARRANTY BY DELTA FAUCET COMPANY, WHICH DOES NOT MAKE ANY OTHER WARRANTY OF ANY KIND, INCLUDING THE IMPLIED WARRANTY OF MERCHANTABILITY.**

This warranty excludes all industrial, commercial & business usage, whose purchasers are hereby extended a five year limited warranty from the date of purchase, with all other terms of this warranty applying except the duration of the warranty. This warranty is applicable to Delta® faucets manufactured after January 1, 1995.

Some states/provinces do not allow the exclusion or limitation of incidental or consequential damages, so the above limitation or exclusion may not apply to you. Any damage to this faucet as a result of misuse, abuse, or neglect, or any use of other than genuine Delta® replacement parts **WILL VOID THE WARRANTY.**

This warranty gives you specific legal rights, and you may also have other rights which vary from state/province to state/province. It applies only for Delta® faucets installed in the United States of America, Canada, and Mexico. UL Listed to US and Canadian Safety Standards 21PL @ CSA B125 ASME A112.18.1
©2002 Masco Corporation of Indiana

MAINTENANCE-TROUBLESHOOTING	
CONDITION	REMEDY
Faucet leaks from tub spout/showerhead. SHUT OFF WATER SUPPLIES.	Replace seats and springs—Repair Kit RP4993. Check condition of lower O-rings and replace if necessary RP14414. See Helpful Hints 1,2,& 3.
If leak persists— SHUT OFF WATER SUPPLIES.	Replace cap assembly RP19806 or valve cartridge RP19804. See Helpful Hints 1,2,& 3.
Unable to maintain constant water temperature...	Replace housing assembly with RP19805 or follow instructions in helpful hints 1,2,& 3.

12" SWING SPOUT Model #3963

SINGLE WALL CONTROL VALVE w/ SWIVEL OUTLET Model #3700

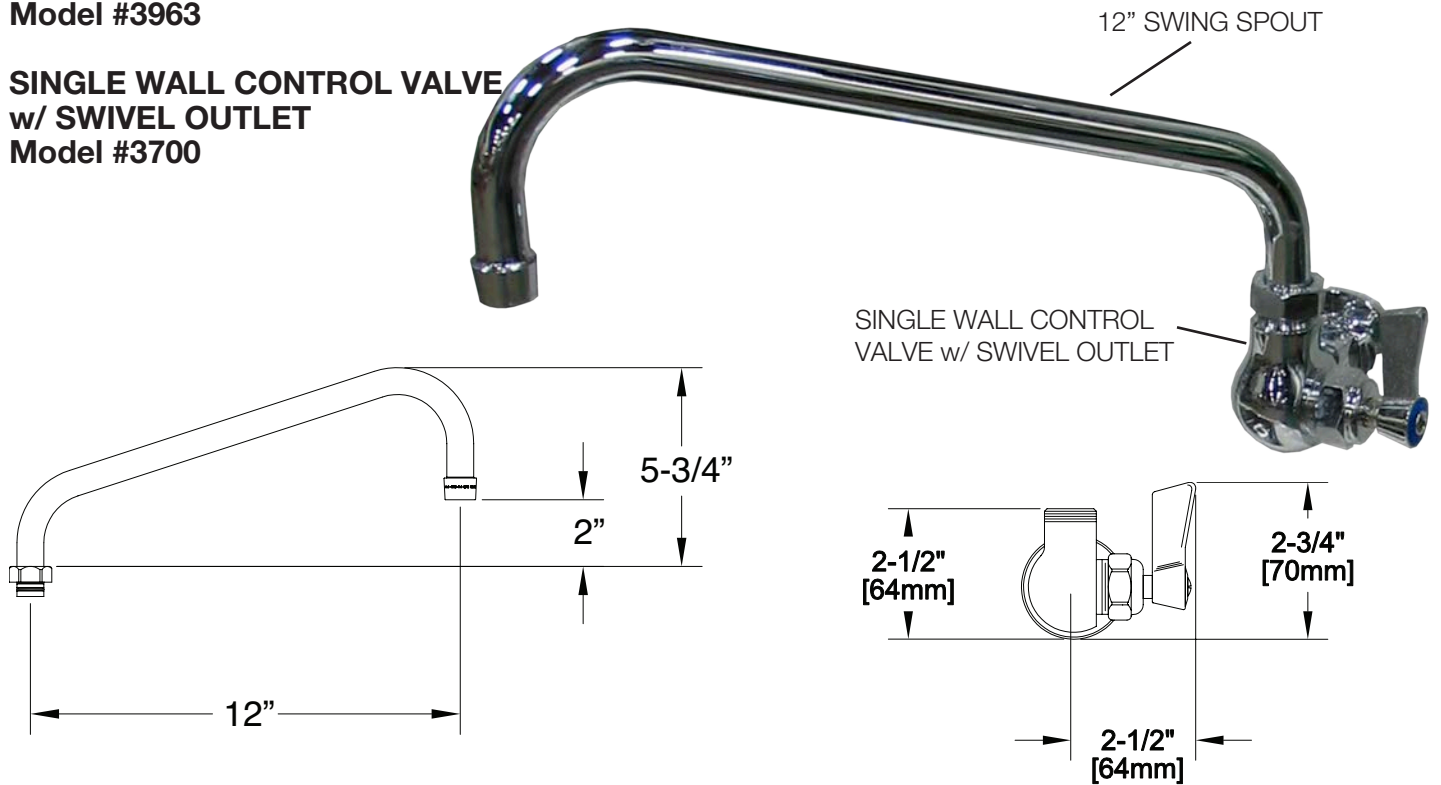



ROUGH-IN:

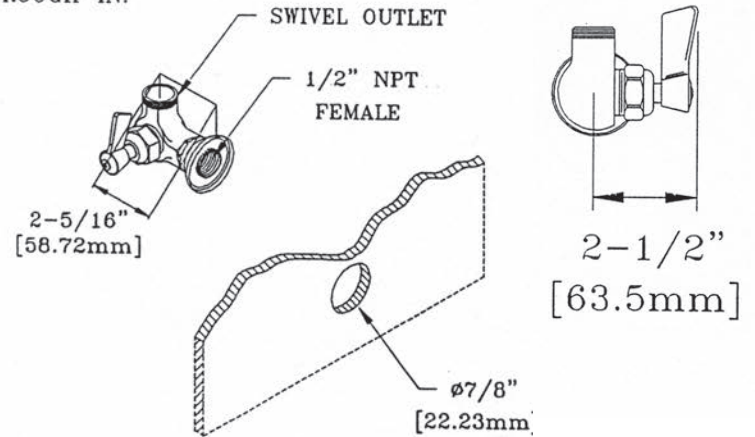

- A - VACUUM 3/4-11.5 FAUCET THREAD
B - 1.500-28 THREAD
C - 1/8-27 NPS PIPE THREAD
D - 3/4-32 THREAD

OVERALL ASSEMBLY LENGTH = 5.750 INCHES

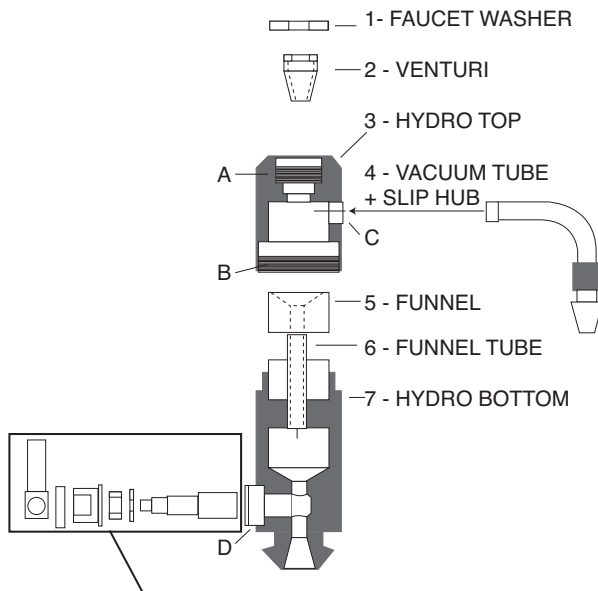

- 8 - HANDLE + 8-32 SET SCREW
9 - LOCKING RING
10 - GLAND NUT
11 - GRAPHITE PACKING
12 - O-RING

13 - VALVE

Mortech Manufacturing Inc.
11 North Aerojet Avenue, Azusa, CA 91702
(26) 334-1471 www.mortechmfg.com

HYDRO-ASPIRATOR

Mandatory operation requirements

- Minimum 1/2" supply line
- Minimum 60 lbs of water pressure
- Minimum 4 gallons per minute of water flow through unit

Vacuum up to 26 inches can be maintained at these pressures. Trocar or aspiration line is attached to the aspiration tube. Diverter handle at lower end must be parallel to length of body of aspirator. To back flush the trocar/aspiration line, turn the diverter handle perpendicular to the length of the aspirator. Tubing can be added to the outlet bottom of the aspirator to direct the flow of water into the sink drain.

Reorder No. LW480



SPRAY HOSE ASSEMBLY

SINGLE WALL CONTROL VALVE

Model #2700

SPRAY HEAD

Model #10820

SPRAY HANDLE

Model #2913

SPRAY HOSE

Mortech Model #SH10



ROUGH-IN:

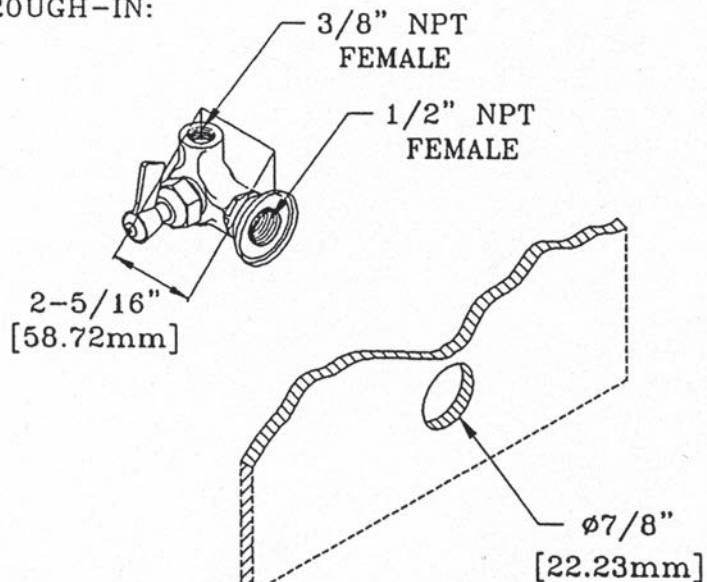

Feature:

- Single wall
- Stem - right hand
- Swiveling seat disk
- Hot & cold index buttons
- Stainless steel seats
- Stainless steel seat screws
- Stainless steel handle screws

Recommended Settings

- 110°F at 80 psi
- System limits
- Temp: 40°F min. to 140°F max.
- Pressure 200 psi max. static
- Shipping weight
- 11.5 lbs

SPRAY HANDLE

Model #2913



SPRAY HEAD

Model #10820

Mortech™ Manufacturing Inc.

411 North Aerojet Avenue, Azusa, CA 91702

(626) 334-1471 www.mortechmfg.com

MAINTENANCE INSTRUCTIONS

The unit requires regular maintenance and follow the manufactures directions.

DISINFECTING AND CLEANING

Clean all surfaces of the stainless steel with a hard surface disinfectant/cleaner such as Sheila Shine® or SaniZene®. Follow instructions on container.

DISINFECTING, CLEANING COMPONENTS & ACCESSORIES

Hand wash with disinfecting soap and warm water. Rinse well with clear water and dry with a towel. (Clean on a regular basis to prolong work life).

WARNING

Improper maintenance can cause injury. Maintain only as prescribed in this manual. Overall, it is very simple to maintain. If you use for its intended purpose, it will provide many years of reliable service.

CARE OF STAINLESS STEEL

Stainless steel products have a directional #4 brushed finish. This finish is produced using a very fine abrasive cloth. Dragging heavy equipment across the stainless steel surfaces will cause noticeable scratching. Pitting/corrosion can occur when carbon steel products are allowed to remain in contact with the stainless steel in the presence of moisture. (Examples- Steel Wool pads left in the bottom of the sink). Stainless steel can be damaged by exposure to acids.

TYPES OF SURFACE CONTAMINANTS

- **Dirt** - Consist of accumulated dust and a variety of contaminates. Warm water with or without a gentle detergent is sufficient. Next in order are mild non-abrasive powders such as typical household cleaners. These can be used with warm water, bristle brushes, sponges, or cleaning cloths. (Do not use carbon steel brushes or steel wool they may leave particles embedded on the surface which can lead to RUSTING.) For more aggressive cleaning, a small amount of vinegar can be added to the scouring powder. When water contains mineral solids, which leave water spots, it is advisable to wipe the surface completely with dry towels.
- **Fingerprints and Stains** - Fingerprints and mild stains resulting from normal use are the most common surface contaminates. This affect the appearance and seldom have an effect on corrosion resistance. They can be removed with a glass cleaner or by gentle rubbing with a paste of soda ash (sodium carbonate) and water applied with a soft rag. Followed by a thorough warm water rinse and towel dry.
- **Shop Oil and Grease** - These soils may be corrosive and may not allow the surface to maintain passivity, and so removal is a necessity. Soap or detergent and water may be used or a combination of detergent and water plus a solvent.

TYPES OF CLEANERS AND METHODS**• General Precautions**

Avoid using abrasive cleaners unless absolutely necessary. A "soft abrasive," such as pumice, should be used. Many cleaners contain corrosive ingredients, rinse with clean water.

• **Clean Water and Wipe** - A soft cloth and clean warm water should always be the first choice for mild stains, loose dirt and soils. A final rinse with clean water and a dry wipe will eliminate the possibility of water stains.

• **Solvent Cleaning** - Organic solvents can be used to remove fresh fingerprints, oils and greases that have not had time to oxidize or decompose. The preferred solvent is one that does not contain chlorine, such as acetone, methyl alcohol, and mineral spirits.

EFFECTIVE CLEANING METHODS

Commercial Cleaners - Many commercial cleaners compounded from phosphates, synthetic detergents, and alkalis are available for the cleaning of severely soiled or stained stainless surfaces. When used with a variety of cleaning methods, these cleaners can safely provide effective cleaning.

SCRATCH REPAIR

Surface scratches can be repaired using the following technique. Depending on the severity of the scratch, it may be possible to completely remove it. Sand the scratch using 120 grit emery cloth or paper and firm pressure. Always sand in the direction of the grain. Avoid the natural tendency to sand in an arc, instead sand in a perfectly straight line. Sand until the scratch is gone.

Polish using 3M Scotch Brite pads - Very Fine Grade. Use the same motions as with sanding. Polish until the original finish is restored. Wash and wipe the surface completely with dry towels.

RUST REMOVAL

Rust can be repaired using the following technique. Sand the scratch using 120 grit emery cloth or paper and firm pressure. Always sand in the direction of the grain. Avoid the natural tendency to sand in an arc, instead sand in a perfectly straight line. Sand until the rust is gone. Polish using 3M Scotch Brite pads - Very Fine Grade. Use the same motions as with sanding. Polish until the original finish is restored. Wash and wipe the surface completely with dry towels.

5 Stainless Steel Mistakes NOT to Make When Cleaning**1. Do not use abrasive cleaners that will scratch the surface.**

Depending on the surface finish of your stainless steel, abrasive cleaners can cause scratching. A dull finish, probably will not show scratching as much as mirror or highly polished finishes. Test the cleaner in a hidden spot. It's also a good idea to work from the least risky type (water) of cleaning to the heavy duty stuff.

2. Do not forget to rinse. Gritty or dirty water can leave a residue on your finish. It can also stain or pit the surface of your stainless steel. Rinse completely. Residue from cleaning solutions left on a stainless steel surface can stain or damage finish.

3. DO NOT USE CLEANERS CONTAINING CHLORINE.

While it may be second nature to bleach everything, stainless steel and chlorine do not mix. Stay away from the bleach when you clean stainless steel. Be aware that bleach can be included in different types of cleaners. If you accidentally get a cleaner on your stainless steel you'll need to rinse it off and quickly.

4. DO NOT USE STEEL WOOL OR STAINLESS BRUSH

These products leave little particles in the surface of the steel and inevitably these particles begin rusting and staining the surface of the steel. They also can excessively scratch the surface of your stainless steel. *Stay completely away from steel wool and steel brushes.*

5. Do not assume it's the cleaner. If you do have some spotting or staining, and you've followed all of the rules, it may not be the stainless steel cleaner. Water, especially hard water, can leave spotting and staining on stainless steel surfaces. Towel dry after rinsing can end the problem. Sometimes, even water is an enemy to stainless steel.



[illegible]



Warranty

1036-2 Wall Mounted Service Station

WARRANTY

Mortech Manufacturing, Inc. warrants all fabrications to be free of defects due to its own workmanship and materials.

CONTINENTAL UNITED STATES:

Repair and/or replacement of parts furnished that may develop such defects, will be warranted for a period of one year parts replacement and 90 days labor from the date of shipment. Items not manufactured by Mortech Manufacturing will receive the manufacturer's warranty.

INTERNATIONAL:

(For validation of warranty, installation location (physical address) required) Replacement of parts furnished that may develop such defects, will be warranted for a period of (18) months from the date of shipment. Shipping and Labor is not warranted. Items not manufactured by Mortech Manufacturing, Inc. will receive the manufacturer's warranty.

PARTS AND SERVICE

Customer relations and product support are important aspects of Mortech Manufacturing, Inc.

For assistance with this or any of our fine products please contact us below:

Mortech Manufacturing, Inc.

411 North Aerojet Avenue

Azusa, CA 91702

TEL (626) 334-1471

FAX (626) 334-1704

www.mortechmfg.com

info@mortechmfg.com

© COPYRIGHT MORTECH MANUFACTURING, INC.,
ALL RIGHTS RESERVED.

CAUTION

- Inspect unit and all components for any loosening that may have occurred during shipping •

ATTENTION

All images and Drawing in this manual may not represent your model. Refer to your particular project for exact specifications

DISCLAIMER

This manual contains general instructions for the use, operation, and care of this product. The instructions are not all inclusive. Safe and proper use of this product is solely at the discretion of the user. Safety information is included as a service to the user. All other safety measures taken by the user should be within and under consideration of applicable regulations. It is recommended that training on the proper use of this product be provided before using this product in and actual situation.

Retain this manual for future reference. Include it with the product in the event of transfer to new users. Additional free copies are available upon request from Customer Relations.

Mortech Manufacturing, Inc. has made every effort to ensure that this Manual is accurate; Mortech Manufacturing, Inc. abdicate liability for any inaccuracies or omissions that may have occurred.

Information in this Manual is subject to change without notice and does not represent a commitment on the part of Mortech Manufacturing, Inc. Mortech Manufacturing, Inc. assumes no responsibility for any inaccuracies that may be contained in this Manual. Mortech Manufacturing, Inc. makes no commitment to update or keep current the information in this Manual, and reserves the right to make improvements to this Manual and/or to the products described in this Manual, at any time without notice.

If you find information in this manual that is incorrect, misleading, or incomplete, we would appreciate your comments and suggestions.

PROPRIETARY NOTICE

The information in this manual is the property of Mortech Manufacturing, Inc. Mortech Manufacturing, Inc. reserves all patent rights, proprietary design rights, manufacturing rights, reproductions rights, and sales use rights thereto, and to any article disclosed therein except to the extent those rights are expressly granted to others or where not applicable to vendor proprietary parts.

