



**MODEL 1036-24**  
**STANDARD**  
**AUTOPSY TABLE**

**CAUTION**

- Inspect unit and all components for any loosening that may have occurred during shipping •

**ATTENTION**

- Review entire manual before starting assembly

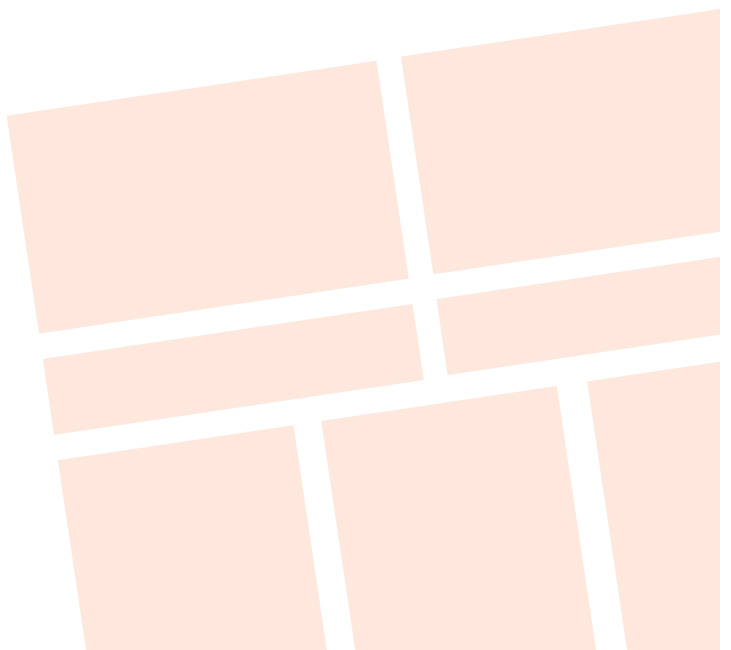

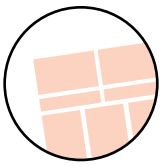

**It is important that the information provided in this manual is observed. These instructions should be read carefully and observed fully before installation and initial operation.**

## WARNING

It is crucial that any work performed on Mortech Mfg. Inc. manufactured items are carried out exclusively by skilled professionals who have the respective training. Improper use, maintenance, parts and service, or modification to the equipment may cause injury and/or damage. Use and maintain the equipment only for the purpose described in this manual. Use only prescribed approved parts and service. Use the equipment only as designed by Mortech mfg. Inc.

## BLOODBORNE DISEASE NOTICE

To reduce the risk of exposure to bloodborne diseases such as HIV-1 and hepatitis when using the equipment, follow the disinfecting and cleaning instructions in this manual.

## OPERATING SKILLS AND TRAINING SKILLS

Operators using the equipment needs

- A working knowledge of necessary procedures.
- The ability to carry out necessary service procedures.
- A complete understanding of the procedures described in this manual.

## TRAINING

- Be trained on the use of the equipment.
- Read the manual
- Practice with the equipment before using it in regular service.
- Be tested on their understanding of the equipment operation.
- Record their training.

## BEFORE USING THE UNIT

Personnel working with this unit needs to read this manual. Assemble of the unit following instructions, and perform any pre-service checks to confirm the units operates properly.

## INSPECTING THE UNIT BEFORE USE

Please take time to inspect all shipment prior to signing delivery ticket. If concealed damage is discovered, save the carton and immediately contact carrier agent to initiate claim of damage.

## BE SURE TO CHECK

- Are all components present?
- Do the moving parts operate smoothly?
- Is unit draining properly?
- Are all nuts, bolts, and pins secured in place?  
If unit has an issue contact customer relations.

## INSTRUCTION FOR HANDLING

Adhere to state and/or local certification and regulations for operation of forklift and/or pallet jack. Cargo is extremely heavy, be sure to have the necessary manpower as well as equipment to successfully unload shipment from truck. We recommend a forklift and/or pallet jack with the capacity to lift up to 2000 lbs. to remove cargo from truck.

The forklift can be used to unload receiving products safely by placing the load on the floor, maneuvering the forklift into position, tilting the mast forward to vertical position so the load will be level, lowering the load, and smoothly backing away without dragging. Once cargo is unloaded, positioning unit for installation will once again require a forklift. Read all manual and note on installation of the unit before installing.

The pallet jack can be used (with a loading dock and maneuverability on and off the transport vehicle) to unload receiving products safely. Maneuvering the pallet jack into position (in the appropriate position within the pallet), lifting the pallet then driving the pallet jack off the truck and safely into the place of installation.

## Range of Environmental Condition

Mortech Mfg. Inc. equipment shall be placed in a controlled environment (housing or housed unit) hindering the weathering effects on the installed units. The units will have minimal corrosive and eroding factors that can break down the stability and operation of Mortech's equipment. The impact on the unit by the operator utilizing water or corrosives in the medical procedures can be controlled and responsibility for the cleaning and maintenance placed upon that person. The effects of anthropogenic (man-made) gasses on the environment, such as carbon dioxide (CO<sub>2</sub>) that will be omitted from the unit should be minimal.

**Due to continuous innovation and product development this installation guide is subject to change without notice.**

**Please save these instructions for later use.**

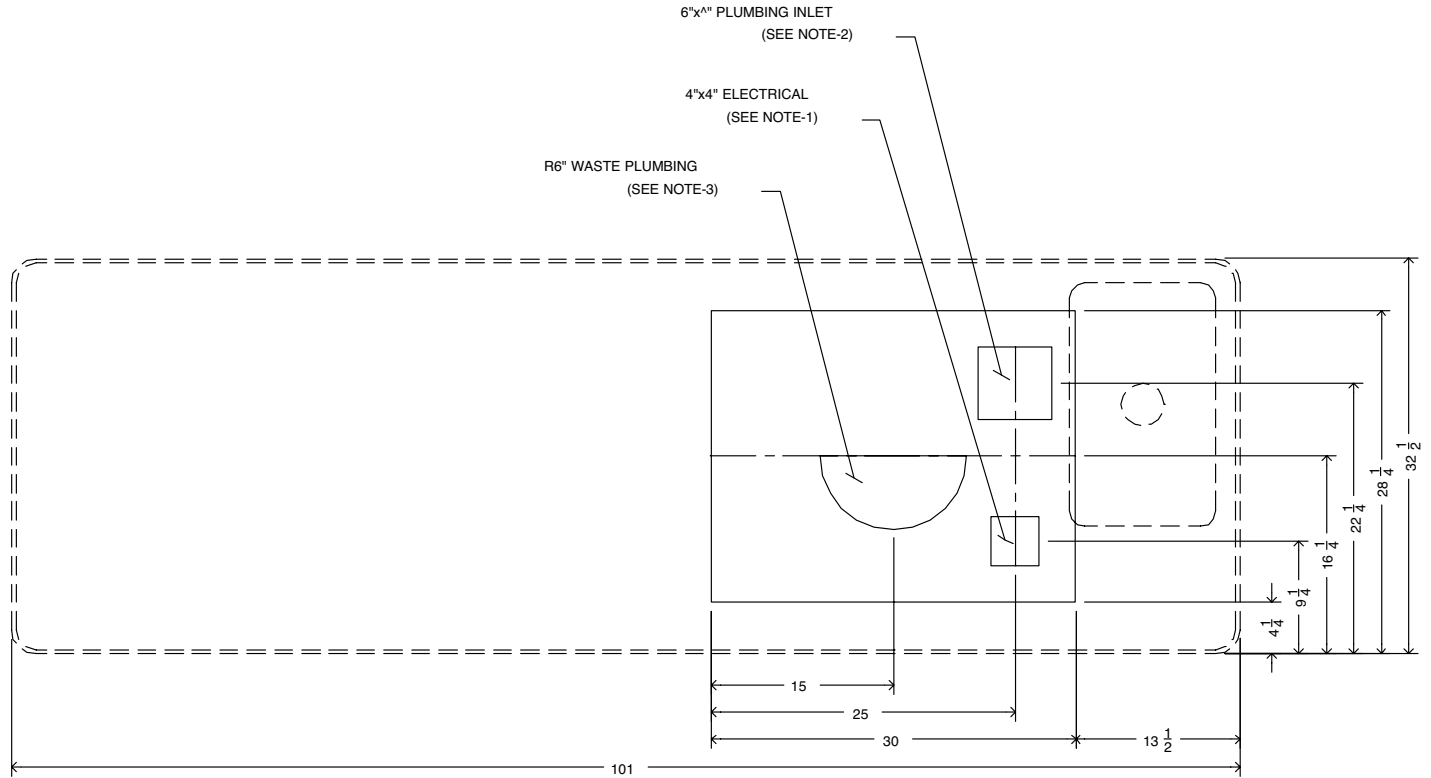

**UTILITY REQUIREMENT NOTES:**

- 1: FLUSH LINES CLEAR BEFORE CONNECTING TO STATION.
- 2: PLUMBER TO PROVIDE SHUT OFF VALVES FOR WATER CONNECTIONS AND P-TRAP FOR DRAIN.
- 3: PROVIDE 60-65 lb. WATER PRESSURE AND 4 GALLONS PER MINUTE OF FLOW FOR PROPER
- 4: ELECTRICIAN TO PROVIDE LIQUID TIGHT JUNCTION BOX AND CONDUIT CONNECTIONS PER LOCAL CODES.

**NOTES:**

- 1) PROVIDE ONE (1) 115V/1 Ø /60hz 20A CIRCUIT.
- 2) PROVIDE INLET PLUMBING TO INCLUDE:
  - (1) ONE Ø 3/4" O.D. COPPER COLD WATER SUPPLY STUBBED OUT 6"
  - (1) ONE Ø 1/2" O.D. COPPER HOT WATER SUPPLY STUBBED OUT 6"
- 3) PROVIDE WASTE PLUMBING TO INCLUDE:
  - (1) ONE Ø 1-1/2" STANDARD COPPER WASTE LINE STUBBED OUT 6"

**PLUMBING CONNECTION INSTRUCTIONS**

**STEP 1:** (Refer to Figure-G) Flush out all water lines prior to connection. Debris may be in the lines from construction process. Install shut off valves on each water line. Lines are clearly marked RED for hot and BLUE for cold. The station is provided with a single point connection for hot and cold water. A typical flex line can be used for connection.

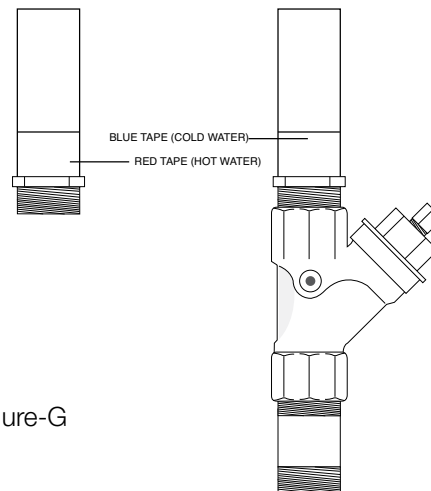
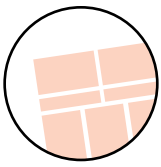
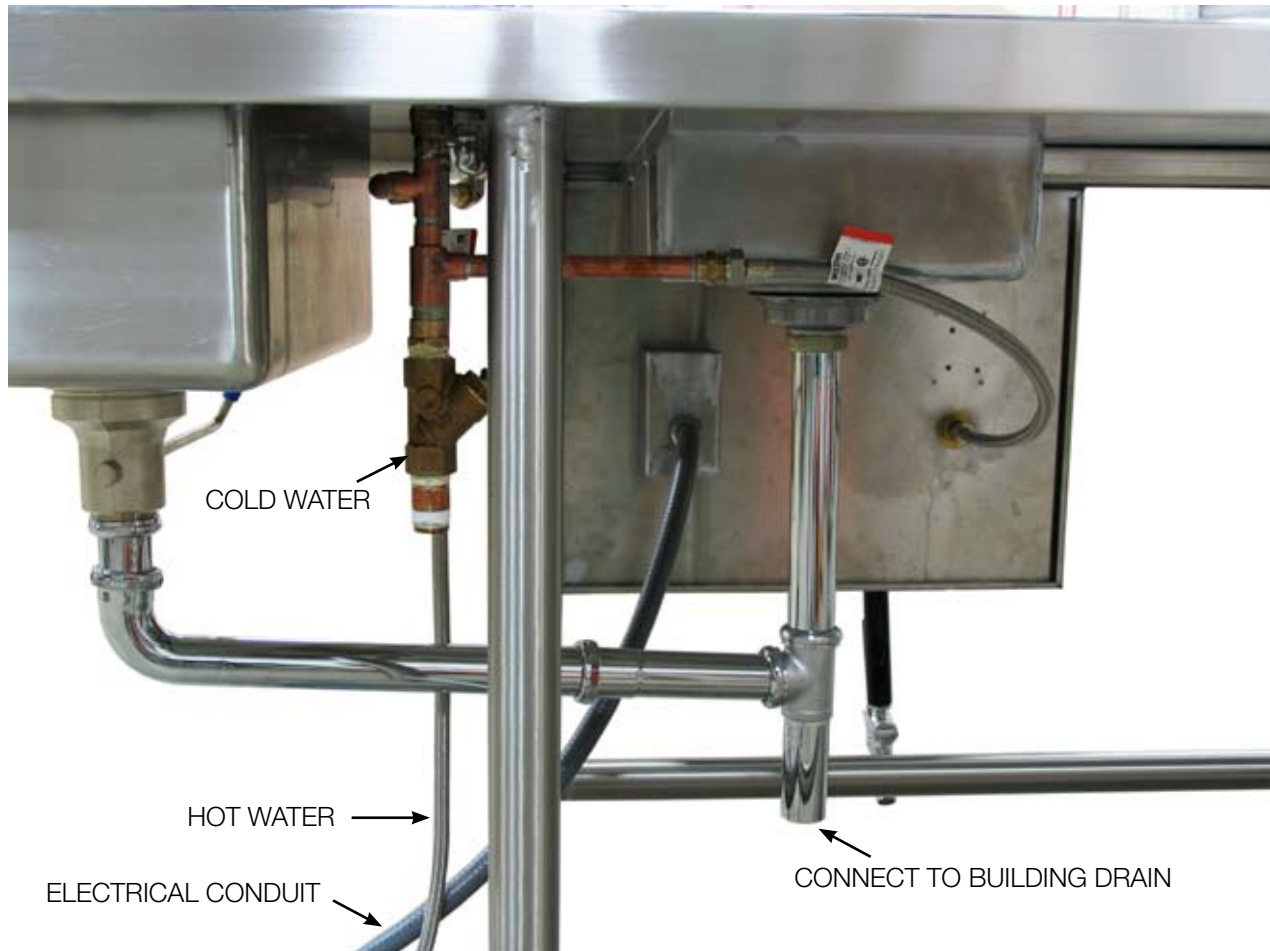

Figure-G





**PLUMBING CONNECTION**



**ELECTRICAL CONNECTION INSTRUCTIONS**

**Step 1:** (Refer to Figure-I) Connect electrical lines from station to building. Units are provided with watertight conduit lines for connection. All units are internally wired so connecting these lines will bring power to all electrical items on the station.

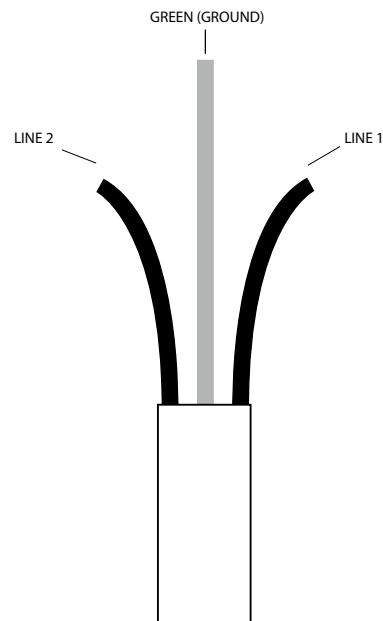
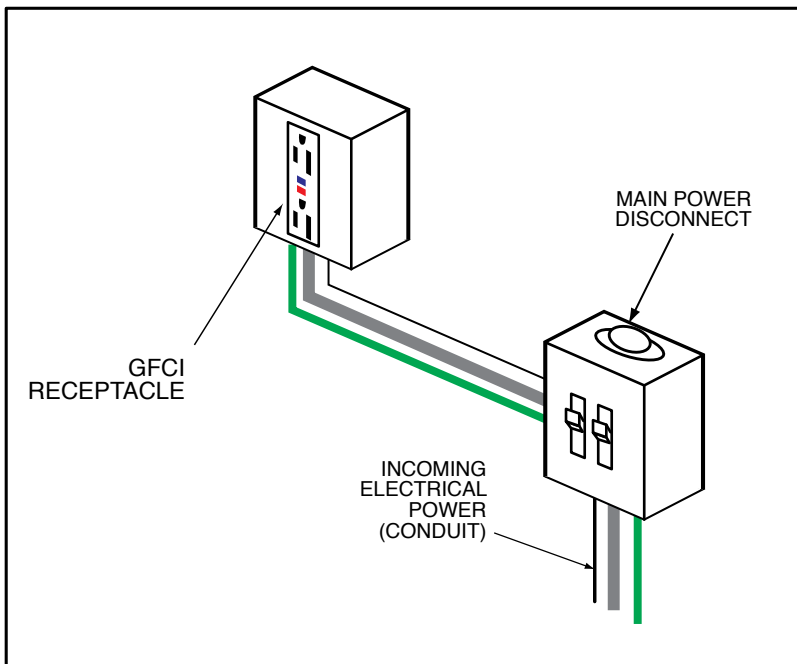
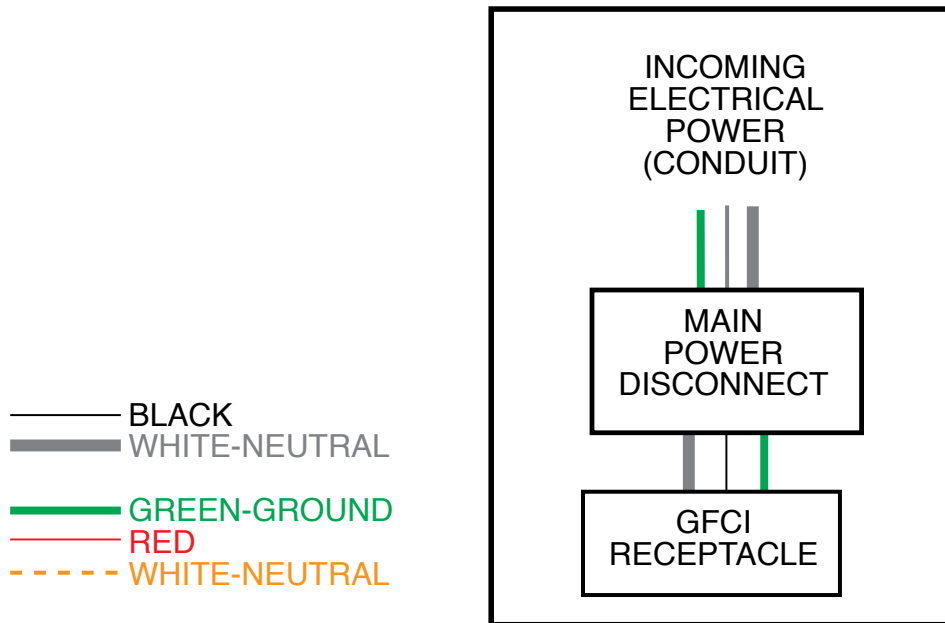
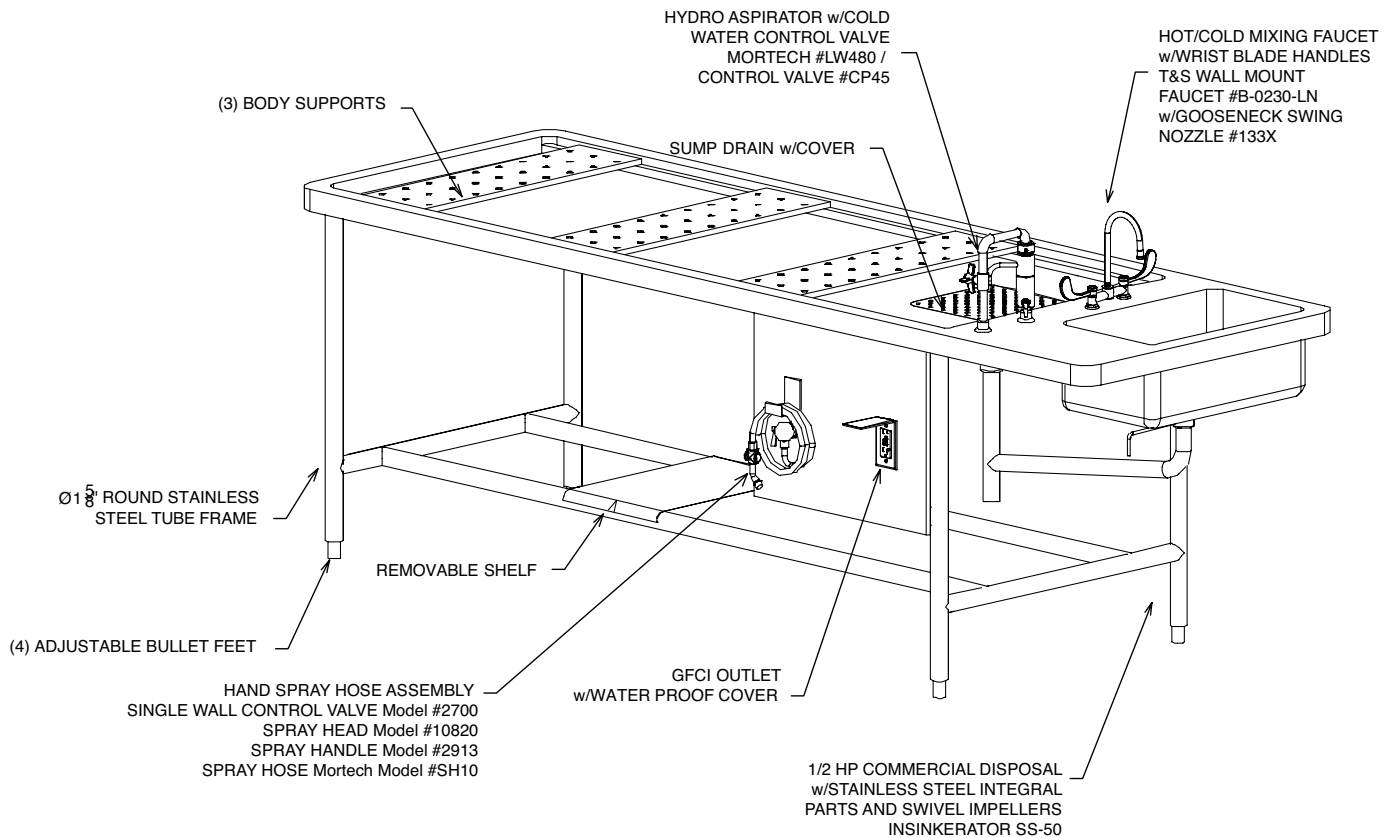
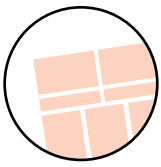

Figure-I





## TROUBLESHOOTING

### Mixing faucet leaking

- Contact plumber to diagnose problem
- Replace faucet gasket seals

### Sink not draining

- Check for debris in sink area
- Contact plumber to diagnose and clear drain if problem persists

### Rust developing

- Check for standing water in rust area  
remove standing water
- Check for non stainless metals left on rust area
- Follow rust removal instructions

### Aspirator not functioning

- Check for adequate water pressure min. -60 lbs. psi
- Check for proper water flow through the unit  
4 gallons per minute
- If above two are adequate, disassemble unit and check for debris causing a clog in the unit.
- Call Mortech customer service if problem persists

### Disposal not functioning

- See troubleshooting in Manufacturer Literature provided

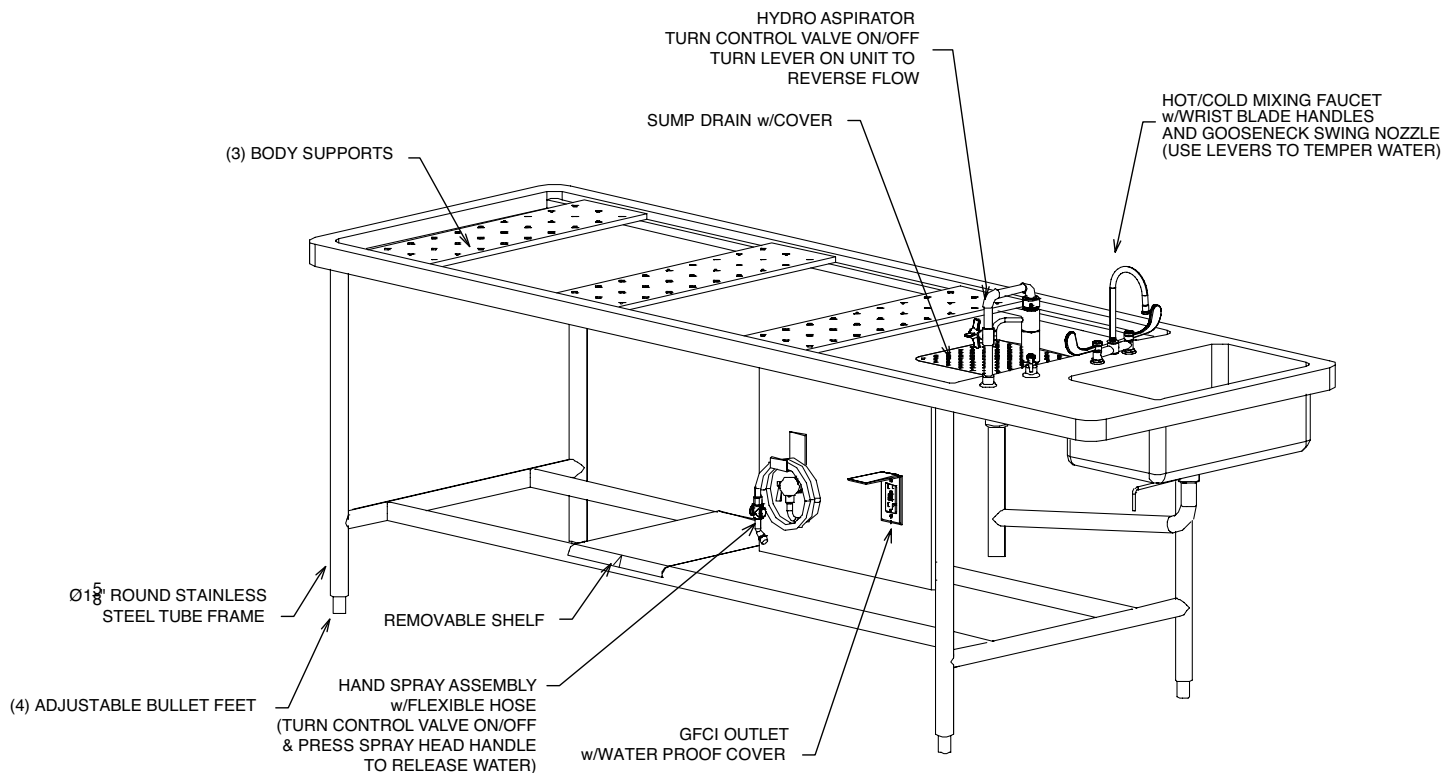

## MODEL 1036-24

The Model 1036-24 is an economical and practical table which provides all necessary features to perform routine autopsy or dissection procedures. It is mounted on four stainless steel legs with adjustable feet

### STANDARD DESIGN FEATURES:

- Size: 33 inches wide x 101 inches long x 34 inches high
- Hand Spray Hose Assembly with Cold Water Control Valve, Nozzle, 10 feet of hose
- Waterproof Electrical Outlet – GFCI
- Deluxe Hydro-Aspirator with Reverse Flow, Cold Water Control Valve and 10 feet of hose
- Large Sink Basin with Lever Handle Drain
- Plumbing and Electrical Lines are factory installed
- All Stainless Steel Construction

### Optional Accessories:

- Heavy Duty Commercial Disposal (1/2, 3/4 or 1hp)
- Postmortem Scale with Scale Pole
- Table End Rinse with cold water control valve and backflow protection
- Gas / Air / Vacuum / Oxygen Cocks
- Aspirator Bottle Collection System
- Emergency Eye Wash
- Full Length Stainless Steel Body Supports
- Centimeter or Inch markings
- Over-the-body Dissecting Tray
- Headrest



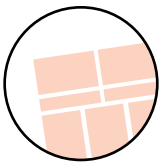

**ADJUSTING THE LEVELING FEET ON THE 1036-24**

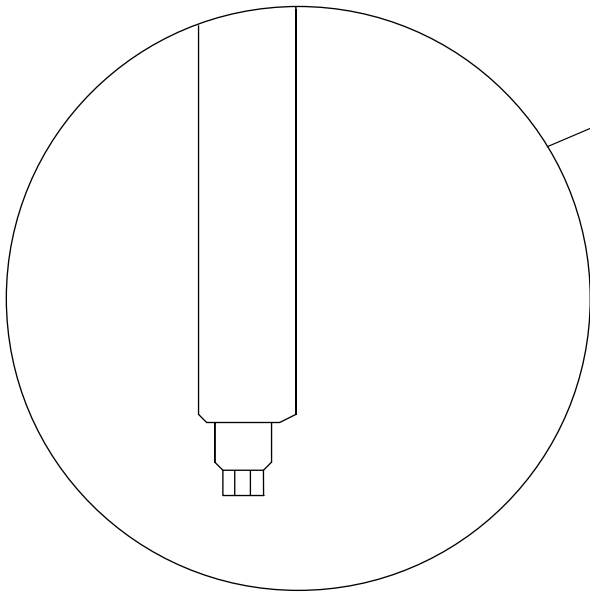
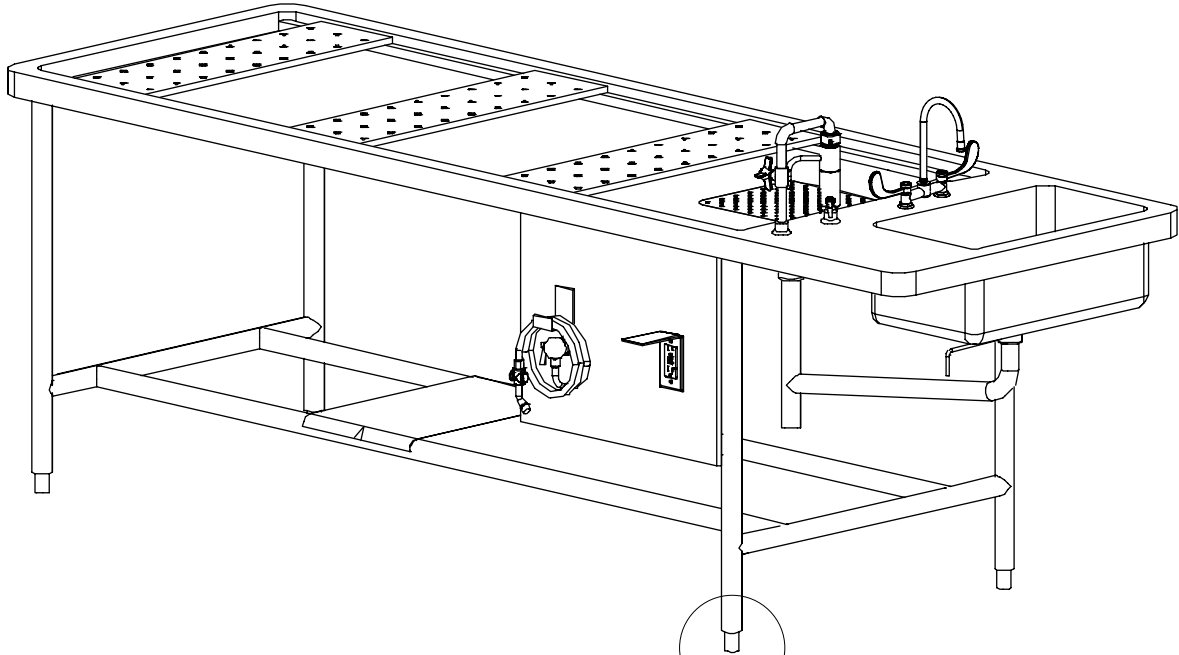

TO EXTEND TURN IN A COUNTER CLOCKWISE MOTION. TO RECEED TURN IN A CLOCKWISE MOTION.

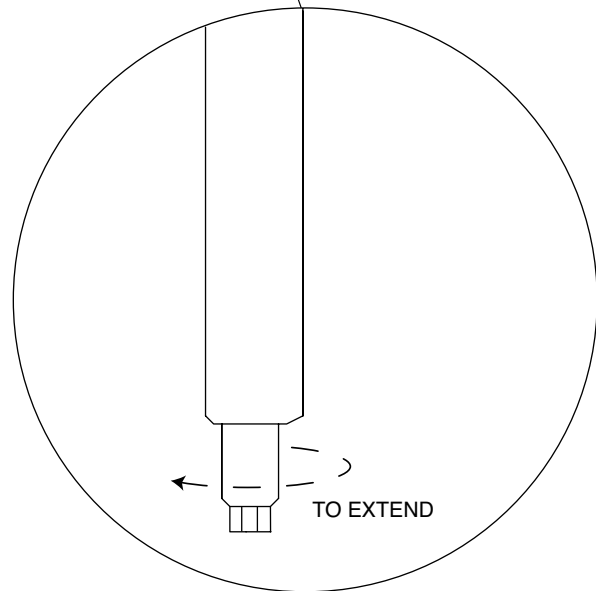

**REMOVABLE PERFORATED GRID PLATE**

Lift to remove for cleaning and maintenance of sink basin.



### Features and Benefits:

#### Lockout Action

- Automatically tests every time the RESET button is pushed.
- The trip latching mechanism in SmartLockPROGFCIs is a one-piece "T" design for efficient operation
- There are 4 sets of contacts for load terminals and face. SmartLockPROGFCIs use a patented bifurcated bridge contact for efficient operation
- The SmartLockPROGFCI with lockout action is designed and patented by Leviton

#### General

- Trip threshold meets or exceeds UL requirements for tripping time
- Improved immunity to high-frequency noise reduces nuisance tripping
- Impact-resistant thermoplastic cover and body

- Advanced electronics design provides superior resistance to electrical surges and over-voltages
  - Expanded wiring options with nine back-wire holes (two for each line and load connection plus one for ground with an internal clamp)
  - Silver alloy contacts
  - Versions available with matching TEST and RESET buttons and traditional black and red models
  - Compatible with all Decora® devices and wallplates; available in select Decora colors
  - Hospital Grade and Blank Face Switch-Rated models available
  - Packed with coordinating wallplate
  - Backed by Leviton's Limited Two-Year Warranty
- Agency Standards & Compliance:**
- Meet or exceed all new UL requirements for July 28, 2006
  - UL Standard 943 Class A (GFCI) and 498 (Receptacles)
  - UL Listed (File # E-48380)
  - CSA Certified (File #LR-57811)
  - NOM Certified (File #057)

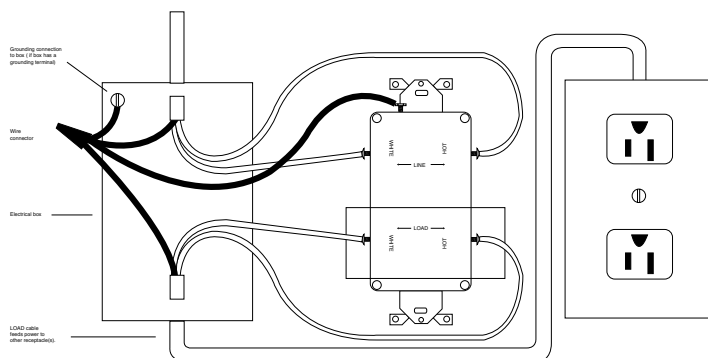
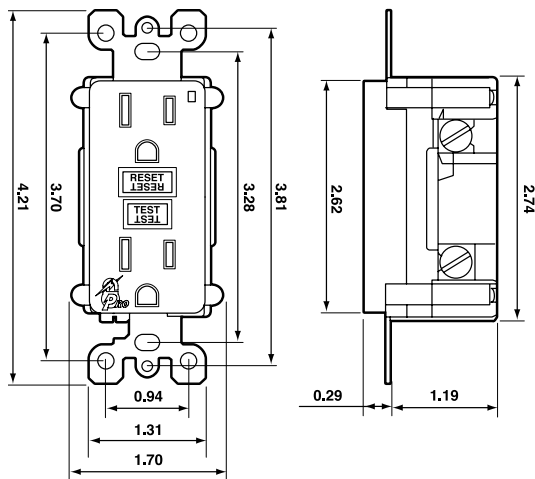

#### Material Characteristics

Environmental: Flammability UL-94 V2 Rating  
 Operating Temperature: -35°C to 65°C

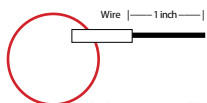

### RECEPTACLE COVER

Type: Vertical

Color: Gray

- Heavy Duty Die Cast Metal Construction
- Patented Quick-Fit™ Key Hole Mount for Easy Installation
- Patented Universal-Fit™ Adapter Technology
- Lockable Tab
- Premium Powdercoat Finish
- Spring Hinge Closure
- UL Listed & 2008 NEC Compliant

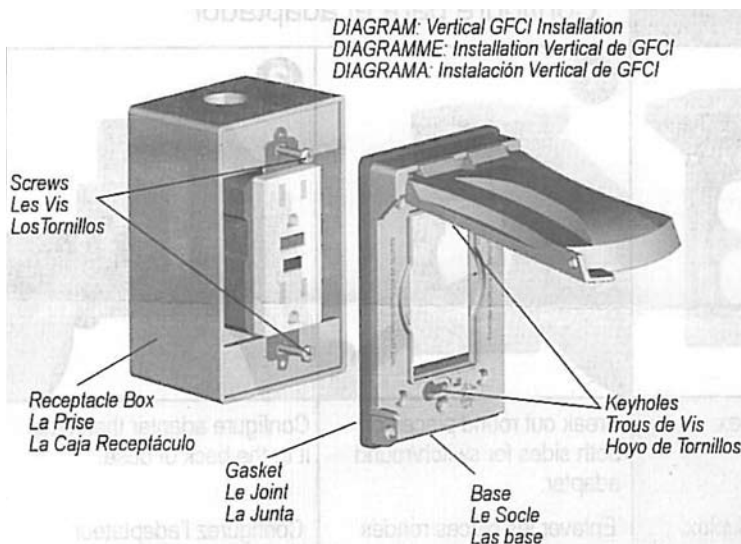

### Technical Specifications

#### LIQUID-TUFF™

UL Liquidtight Flexible Non-Metallic Conduit  
(Type LFNC-B)

#### Scope

This specification covers AFC Cable Systems, Inc. UL LIQUID-TUFF™ Integral Liquidtight Flexible Non-Metallic Conduit, Type LFNC-B designed for use in wet, dry or oily locations as a flame resistant, non-metallic raceway for power, control and communications cables in compliance with Article 356 of the National Electrical Code. The product is UL Listed for 80°C (176°F) in a dry location, 60°C (140°F) in a wet location and 70°C (158°F) in an oily location. It is also UL Listed through 2-inch trade sizes for direct burial, outdoor use and sunlight resistance. In addition the product is CSA certified for use at 75°C (167°F) in dry and oily locations and for minus 18°C (0°F) low temperature applications. This Liquidtight Flexible Non-Metallic Conduit is manufactured and tested in accordance with Underwriters Laboratories Inc. Standard UL 1660 and CSA International Standard CSA C22.2 Number 227.2. The product carries the UL Listing Mark and the CSA Certification Mark.

#### Construction

Liquidtight Flexible Non-Metallic Conduit, Type LFNC-B is a raceway of circular cross section with a smooth polyvinyl chloride (PVC) inner surface and an integral reinforcing member within the conduit wall. The wall thicknesses and dimensions of the integral conduit shall comply with Table 6.4 of UL 1660 and Table 1B of CSA C22.2 No. 227.2 which are summarized in Table 1.

#### Grounding

A separate Grounding conductor is required by both the National Electrical Code and the Canadian Electrical Code for all trade sizes.

#### Markings

The outer surface of the conduit shall be clearly marked with a legible print legend in accordance with UL 1660 and CSA C22.2 No. 227.2.



#### Performance Tests

The completed UL LIQUID-TUFF™ Liquidtight Flexible Non-Metallic Conduit, Type LFNC-B shall meet all of the performance requirements contained in UL 1660 and CSA C22.2 No. 227.2 and outlined in Appendix A.

- Package lengths in excess of 100' contain splices; these splices must be cut out before use.

#### Reference Standards

UL 1660	Standard for Liquidtight Flexible Non-Metallic Conduit
CSA C22.2 No. 227.2	Standard for Flexible Liquidtight Non-Metallic Conduit
UL File References NEC@Articles:	UL E123464; CSA 69271 356, 390.15, 501.10(B)(2), 502.10(A)(2), 503.10(A)(2), 511.7(A)(1), 620.21, 645.5(D)(2), 680.21, 680.23, 680.25, 680.27, 680.42, 695.6(E) and 695.14(E)

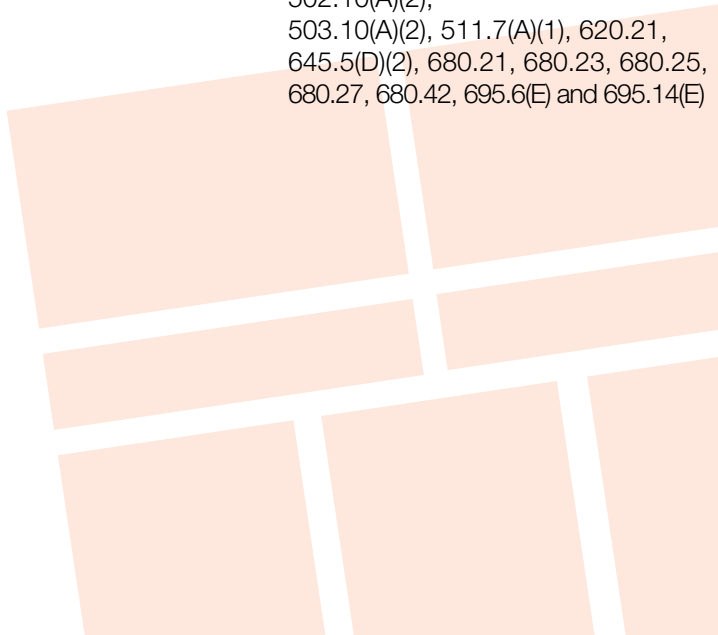

**T&S B-0225-LN  
WALL MOUNT FAUCET  
HOT/COLD MIXING FAUCET**

**T&S DECK MOUNT FAUCET  
w/GOOSENECK NOZZLE**

Model #B-0225-LN

**T&S**

Model #B-0413

**T&S SWIVEL  
GOOSENECK SPIGOT**

Model #133X



**T&S**  
Model #B-0413

**T&S DECK  
MOUNT FAUCET  
w/WRIST BLADES**  
Model #B-0225-LN

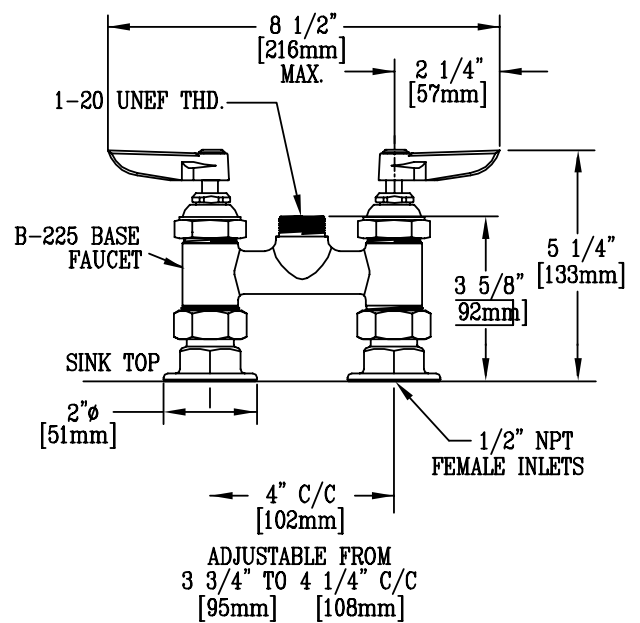
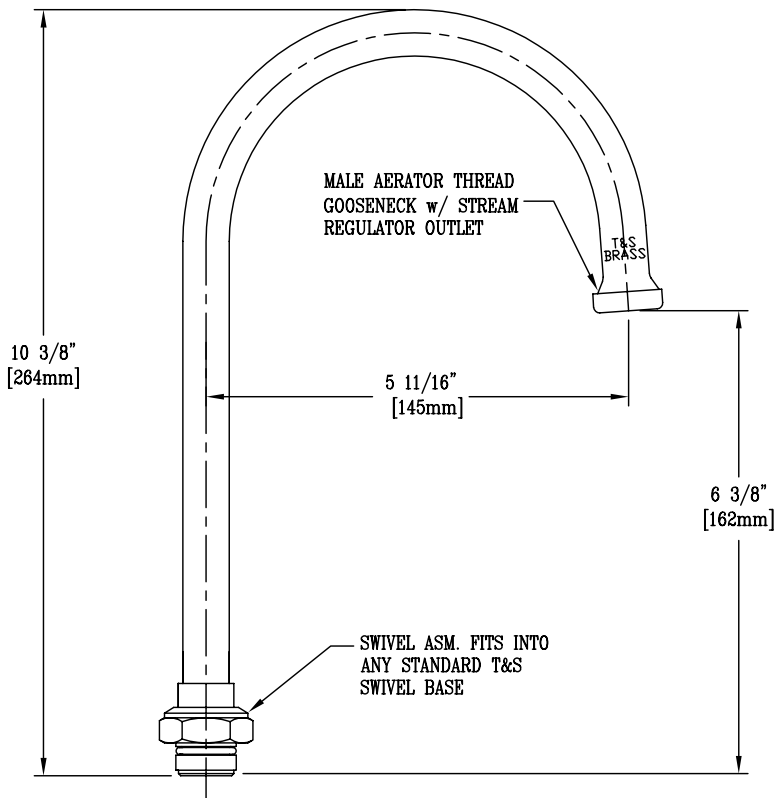

### SPRAY HOSE ASSEMBLY

#### SINGLE WALL CONTROL VALVE

Model #2700

#### SPRAY HEAD

Model #10820

#### SPRAY HANDLE

Model #2913

#### SPRAY HOSE

Mortech Model #SH10

ROUGH-IN:

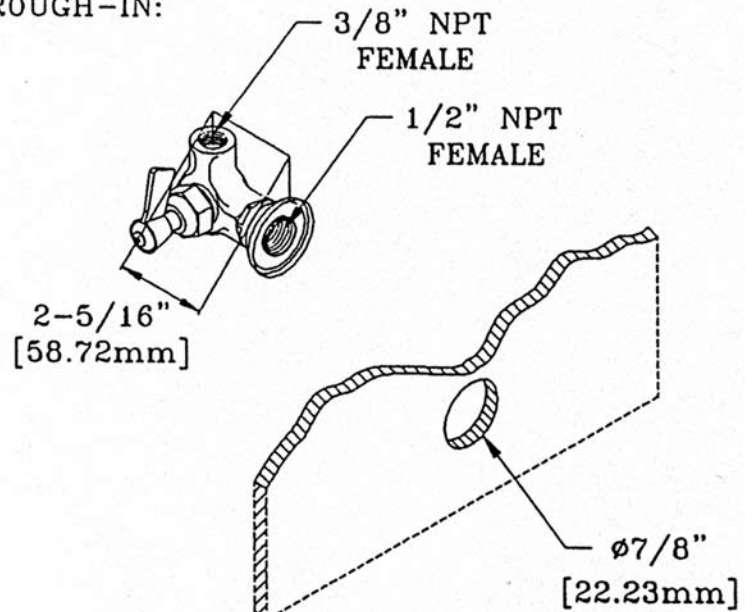

**FISHER SINGLE WALL CONTROL VALVE**  
MODEL # 2700



**SPRAY HOSE**  
Mortech Model #SH10

#### SPRAY HANDLE

Model #2913



#### SPRAY HEAD

Model #10820



#### Feature:

- Single wall
- Stem - right hand
- Swiveling seat disk
- Hot & cold index buttons
- Stainless steel seats
- Stainless steel seat screws
- Stainless steel handle screws

#### Recommended Settings

- 110°F at 80 psi
- System limits
- Temp: 40°F min. to 140°F max.
- Pressure 200 psi max. static
- Shipping weight
- 11.5 lbs

#### Fisher Manufacturing Co.

1900 South "O" Street  
Tulare, California 93274  
800-421-6162  
800-832-8236 FAX

Mailing Address:  
P.O.Box 60  
Tulare, California 93275

### HYDRO-ASPIRATOR

Mandatory operation requirements

- Minimum 1/2" supply line
- Minimum 60 lbs of water pressure
- Minimum 4 gallons per minute of water flow through unit

Vacuum up to 26 inches can be maintained at these pressures. Trocar or aspiration line is attached to the aspiration tube. Diverter handle at lower end must be parallel to length of body of aspirator. To back flush the trocar/aspiration line, turn the diverter handle perpendicular to the length of the aspirator. Tubing can be added to the outlet bottom of the aspirator to direct the flow of water into the sink drain.

Reorder No. LW480

- A - VACUUM 3/4-11.5 FAUCET THREAD
- B - 1.500-28 THREAD
- C - 1/8-27 NPS PIPE THREAD
- D - 3/4-32 THREAD

OVERALL ASSEMBLY LENGTH = 5.750 INCHES

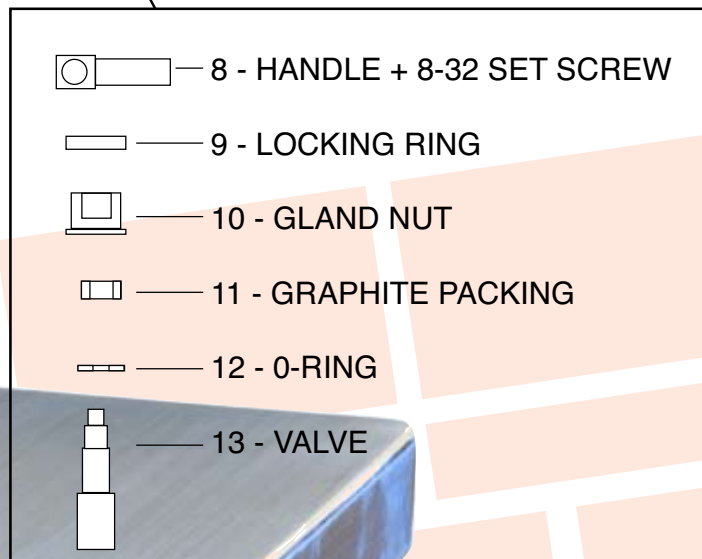
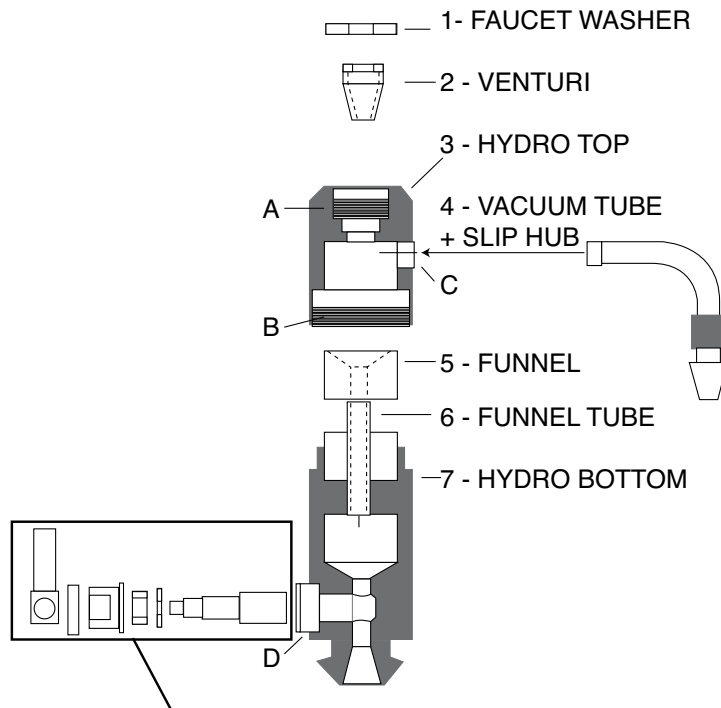
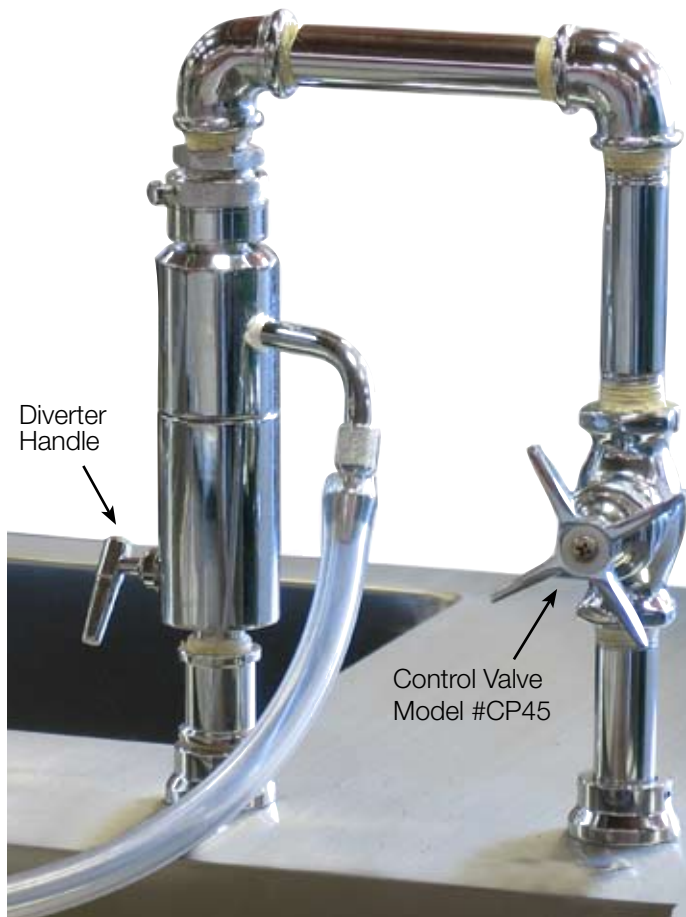

### CHICAGO MODEL 45-CP

Installation should be in accordance with local plumbing codes. Flush all pipes thoroughly before installation. After installation, remove spout outlet or flow control and flush faucet thoroughly to clear any debris. Care should be taken when cleaning this product. Do not use abrasive cleaners, chemicals or solvents as they can result in surface damage. Use mild soap and warm water for cleaning and protecting the life of faucet products.

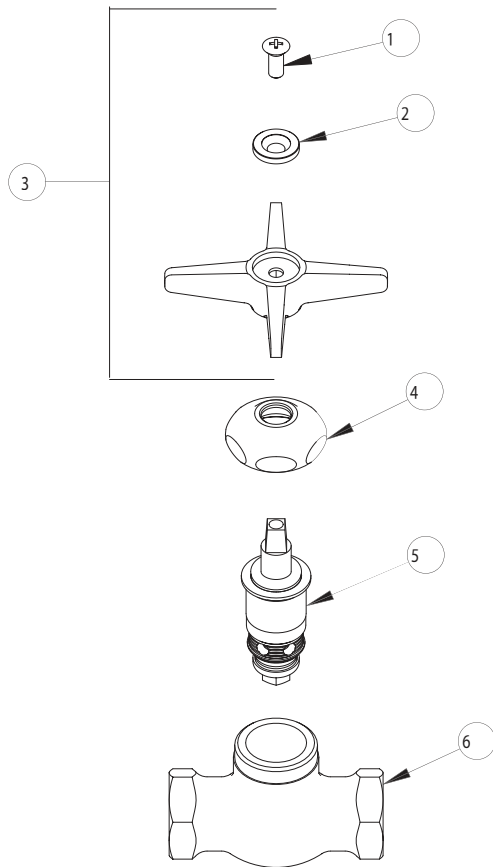

ITEM NO.	PART NO.	DESCRIPTION
1	420-010	SCREW
2	633-223	INDEX BUTTON (WHITE)
3	633PL	4-ARM PLAIN HANDLE ASSEMBLY
4	1-214	CAP
5	217XTLH	SLO-COMPRESSION UNIT (LH)
6	-----	VALVE BODY (NOT SOLD SEPARATELY)

### WARRANTY

- Lifetime Limited Faucet Warranty
- 5-Year Limited Cartridge Warranty
- 1-Year Limited Finish Warranty

### FEATURES & SPECIFICATIONS

- Polished chrome plated finish
- Solid brass body construction
- 3" diameter metal cross handle with color coded index button, catalog #633
- Slow compression renewable cartridge that closes with water pressure with tapered square broach to facilitate handle removal, catalog #217-XTLH
- 1/2" NPT inlet and outlet

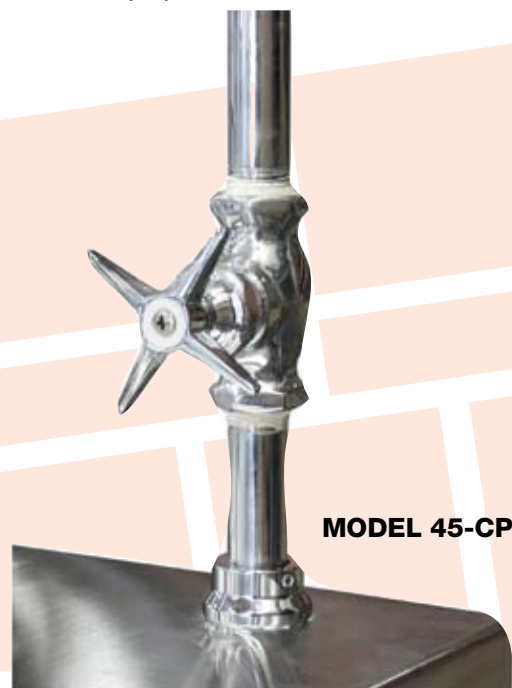
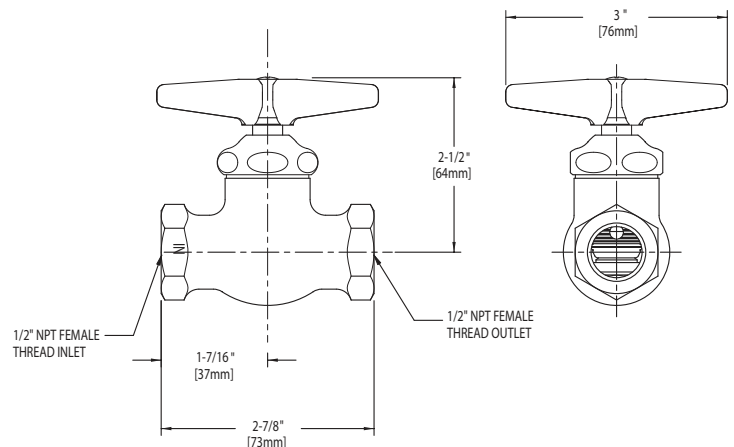

**MODEL 45-CP**

### Vacuum Breaker

Size: 3/4" (20mm) thread

Vacuum Breaker is a line of unique vacuum breakers specially made to

permit the attachment of portable hoses to hose thread faucets. Designed to prevent the flow of contaminated water back into the potable water supply, these devices require no plumbing changes, and screw directly onto a sill cock.

#### Features

- Stainless steel working parts for longevity
- Durable rubber diaphragm and disc for consistent positive seating

Use only with approved hose bibbs or hose fittings having four or more full American National Hose (NH) threads.

### Capacity

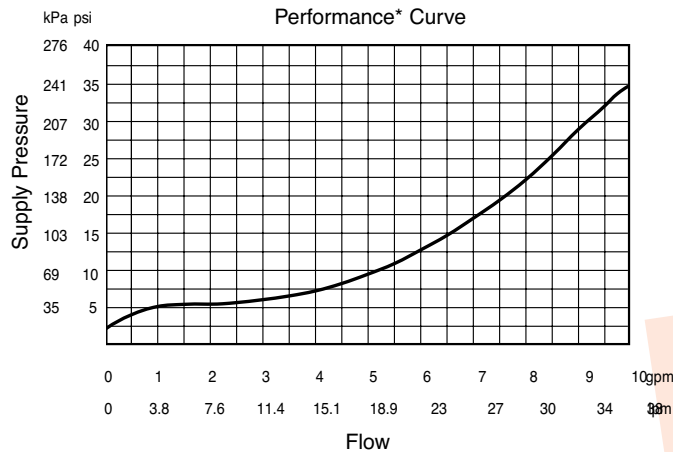

### Dimensions – Weights

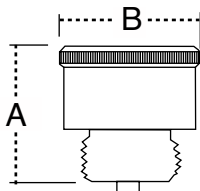

MODE	SIZE (DN)		DIMENSION				WEIGHT	
	In.	mm	A		B		oz.	gm.
8B	3/4HT	20	1/2	38	1 3/8	35	4.0	113.4

### INSTALLATION

Thread Vacuum Breaker onto Aspirator, tighten. Vacuum Breaker is secured by tightening the set screw.

### TO DRAIN

Vacuum Breaker can be drained to prevent freezing by removing and pulling down gently on the stem.

### IMPORTANT

Do not use with continuous pressure or use where discharge of water could cause damage.



### Wye-Pattern, Bronze Strainers

Sizes: 3/4" – (19mm)

Wye-Pattern, Bronze Strainers are designed to protect plumbing system components from dirt, rust and other damaging debris. This series features a tapped retainer cap and closure plug.

#### Features

- Bronze body
- Wye-pattern
- Tapped retainer cap
- Closure plug
- Special flared screen opening on upstream end to provide unrestricted flow through the strainer

#### Specifications

A wye-pattern, bronze strainer to be installed as indicated on the plans. The strainer must have a tapped retainer cap and closure plug. Strainer shall be rated to 400psi (27.6 bar) WOG; 125psi (8.6 bar) WSP for sizes 3/8"-2" (10-50mm) and 300psi (20.7 bar) @ 210oF (99oC); 125psi (8.6 bar) WSP @ 353oF (178oC) for sizes 2 1/2"-3" (65-80mm). Strainer shall be a Watts Regulator Company Series 777SI (threaded ends) or S777SI (solder ends).

#### Materials

Body: ..... Bronze  
 Retainer Cap: ..... Brass  
 Plug: ..... Bronze  
 Gasket: ..... NBR  
 Standard Screen: ..... #20 mesh, 304 stainless steel D

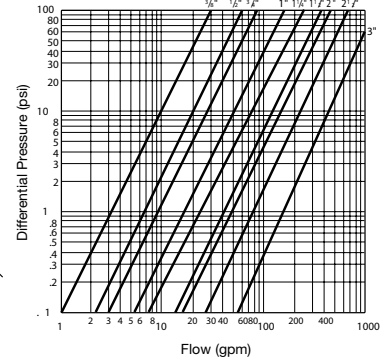
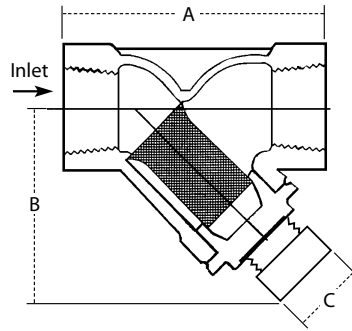

Flow curves show (gpm) and pressure drop (psig) through Watts Series using standard 20 mesh screen.

#### Dimensions 777SI

SIZE (DN)		DIMENSIONS				WEIGHT			
in.	mm	A in.	A mm	B in.	B mm	C in.	C mm	lbs.	kg.
3/4	20	3 3/16	81	1 5/8	42	1/4	6	0.6	0.27

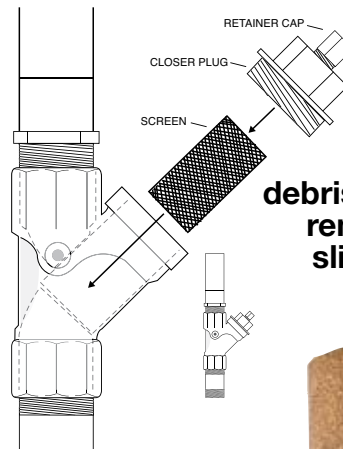

**Check periodically for debris. To access the screen remove the filter plug and slide screen out. Remove debris and rinse clean**

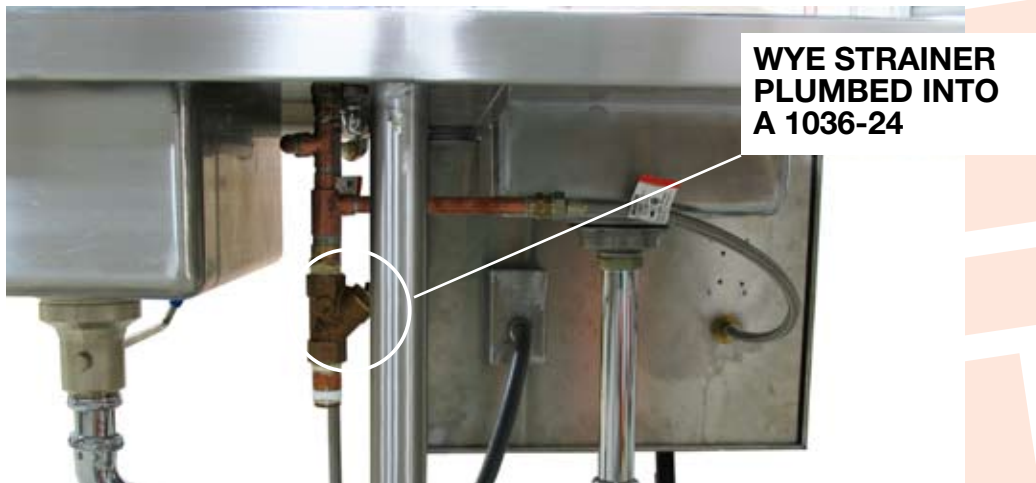

#### IMPORTANT

**Before Service and Maintenance: Shut water off before checking and cleaning the Wye Strainer fitting screen located inside the fitting.**



### PREMIER 119126 Twist Blade Waste Assembly

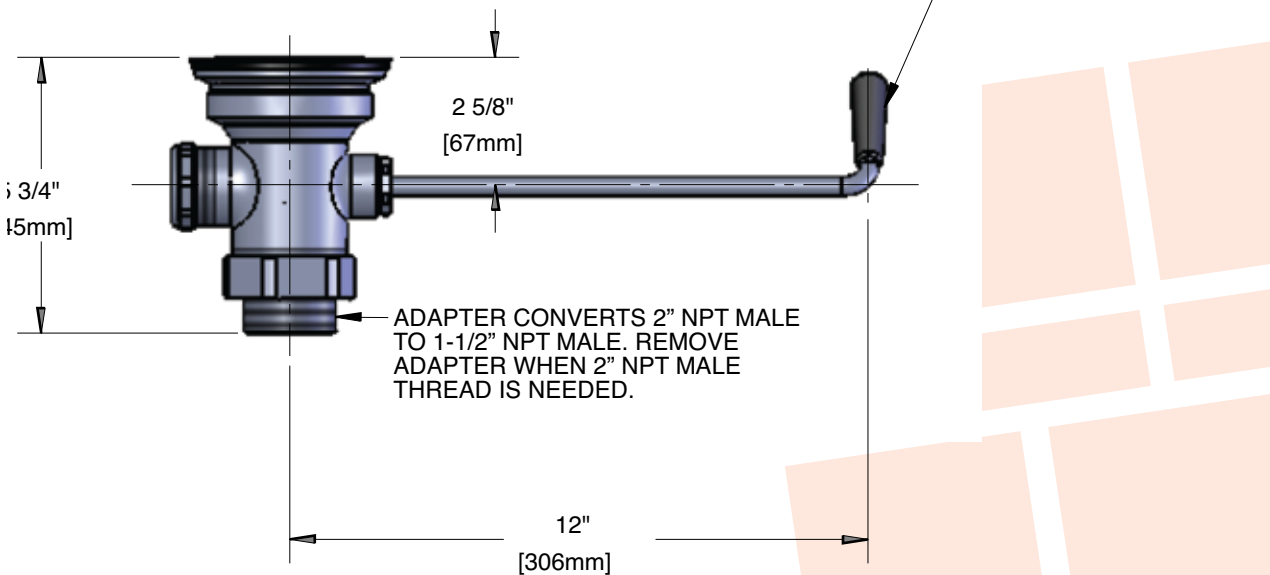
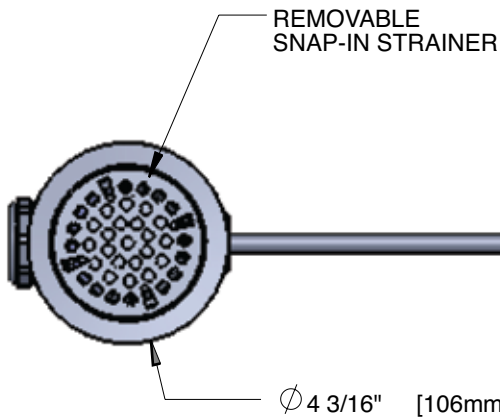
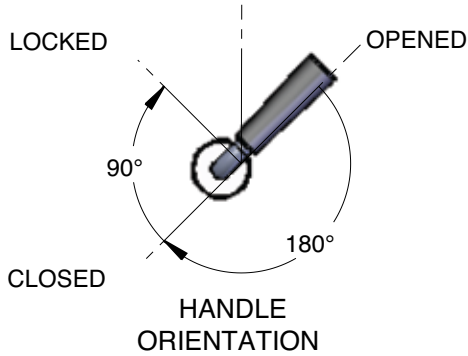

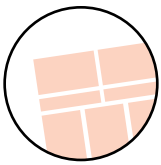

**Digital Scale**

The Ohaus Compact Scale is ideal when cost matters and dependable results are a must. This uniquely designed scale is useful in a wide variety of applications, more than any other scale in its class. Easy operation, long battery life, and great performance make this product a truly remarkable value.



**Removable Measuring Ruler**

Anyone who works with metal will appreciate the simplicity and practicality of these flexible magnetic rulers. They simplify the jobs, but you'll reach for them often as you discover new uses! They're "hands free" when used on steel bodies or sheet metal, allowing you to make the most accurate measurements quickly.



**Scale Pole and Mounting Bracket**

Stainless steel scale pole with mounting bracket for use with standard hanging autopsy scales. Pole can swivel left to right and includes locking knob to keep in desired position. Can be positioned to left, right or center of station depending on your preference.



**Head Rest**

LW390  
Molded from chemical resistant plastic. Adjustable up to six positions. Reusable and easily cleaned with soap and water. Wider base legs allow for more table contact for added stability and less slippage.



**Raised Dissecting Platform**

Model LW380  
Size in Inches 24 x 17 x 14  
Fabricated entirely of polished stainless steel. Heavy gauge material provides a very stable work surface. Tray creased toward center drain. Drain has hose attachment to route flow to desired location. Height and width suitable for over the body placement.



**Commercial Grade Waste Disposal Units**

Units come standard with 1/2 hp disposal units. Facilities can upgrade to 3/4 hp, 1 or 2 disposal units. Units have all internal stainless steel components and swivel impellers.



**Dissecting Boards**

Dissecting Boards are manufactured from high density polyethylene which provides an excellent cutting surface. All top edges are chamfered and all bottom corners have a non-skid rubber bumper attached. Color is opaque white.

**Evidence Screen**

Model LW485  
The screen is designed to prevent evidence from being accidentally washed down the drain. It is fabricated entirely from perforated stainless steel with a stainless steel pull handle. It is designed for use in 3.5 inch diameter drains.



**Size in Inches**

**Order No.**

- 24 x 18 x 0.75 thick      LW385
- 18 x 12 x 0.75 thick      LW386
- 20 x 15 x 0.75 thick      LW387
- 20 x 15 x 0.50 thick      LW389
- Photo Blue Board



**IMPORTANT**  
**SOME ACCESSORIES CAN ONLY**  
**BE PROVIDED AT THE TIME OF**  
**ORIGINAL ORDER.**

**MAINTENANCE INSTRUCTIONS****MAINTENANCE SCHEDULE**

The unit requires regular maintenance and follow the manufactures directions.

**DISINFECTING AND CLEANING**

Clean all surfaces of the stainless steel with a hard surface disinfectant/cleaner such as Sheila Shine® or SaniZene®. Follow instructions on container.

**DISINFECTING AND CLEANING COMPONENTS AND ACCESSORIES**

Hand wash with disinfecting soap and warm water. Rinse well with clear water and dry with a towel. (Clean on a regular basis to prolong work life).

**WARNING**

Improper maintenance can cause injury. Maintain only as prescribed in this manual.

Overall, it is very simple to maintain. If you use for its intended purpose, it will provide many years of reliable service.

**CARE OF STAINLESS STEEL**

Stainless steel products have a directional #4 brushed finish. This finish is produced using a very fine abrasive cloth. Dragging heavy equipment across the stainless steel surfaces will cause noticeable scratching. Pitting/corrosion can occur when carbon steel products are allowed to remain in contact with the stainless steel in the presence of moisture. (Examples- Steel Wool pads left in the bottom of the sink). Stainless steel can be damaged by exposure to acids.

**TYPES OF SURFACE CONTAMINANTS**

**Dirt** - Consist of accumulated dust and a variety of contaminates. Warm water with or without a gentle detergent is sufficient. Next in order are mild non-abrasive powders such as typical household cleaners. These can be used with warm water, bristle brushes, sponges, or cleaning cloths. (Do not use carbon steel brushes or steel wool they may leave particles embedded on the surface which can lead to RUSTING.) For more aggressive cleaning, a small amount of vinegar can be added to the scouring powder. When water contains mineral solids, which leave water spots, it is advisable to wipe the surface completely with dry towels.

**Fingerprints and Stains** - Fingerprints and mild stains resulting from normal use are the most common surface contaminates. This affect the appearance and seldom have an effect on corrosion resistance. They can be removed with a glass cleaner or by gentle rubbing with a paste of soda ash (sodium carbonate) and water applied with a soft rag. Followed by a thorough warm water rinse and towel dry.

**Shop Oil and Grease** - These soils may be corrosive and may not allow the surface to maintain passivity, and so removal is a necessity. Soap or detergent and water may be used or a combination of detergent and water plus a solvent.

**TYPES OF CLEANERS AND METHODS****General Precautions**

Avoid using abrasive cleaners unless absolutely necessary. A "soft abrasive," such as pumice, should be used. Many cleaners contain corrosive ingredients, rinse with clean water.

**Clean Water and Wipe** - A soft cloth and clean warm water should always be the first choice for mild stains, loose dirt and soils. A final rinse with clean water and a dry wipe will eliminate the possibility of water stains.

**Solvent Cleaning** - Organic solvents can be used to remove fresh fingerprints, oils and greases that have not had time to oxidize or decompose. The preferred solvent is one that does not contain chlorine, such as acetone, methyl alcohol, and mineral spirits.

**EFFECTIVE CLEANING METHODS**

**Commercial Cleaners** - Many commercial cleaners compounded from phosphates, synthetic detergents, and alkalis are available for the cleaning of severely soiled or stained stainless surfaces. When used with a variety of cleaning methods, these cleaners can safely provide effective cleaning.

**SCRATCH REPAIR**

Surface scratches can be repaired using the following technique. Depending on the severity of the scratch, it may be possible to completely remove it. Sand the scratch using 120 grit emery cloth or paper and firm pressure. Always sand in the direction of the grain. Avoid the natural tendency to sand in an arc, instead sand in a perfectly straight line. Sand until the scratch is gone.

Polish using 3M Scotch Brite pads - Very Fine Grade. Use the same motions as with sanding. Polish until the original finish is restored. Wash and wipe the surface completely with dry towels.

**RUST REMOVAL**

Rust can be repaired using the following technique. Sand the scratch using 120 grit emery cloth or paper and firm pressure. Always sand in the direction of the grain. Avoid the natural tendency to sand in an arc, instead sand in a perfectly straight line. Sand until the rust is gone.

Polish using 3M Scotch Brite pads - Very Fine Grade. Use the same motions as with sanding. Polish until the original finish is restored. Wash and wipe the surface completely with dry towels.







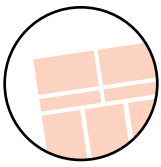

## WARRANTY

Mortech Manufacturing warrants all fabrications to be free of defects due to its own workmanship and materials.

Repair and/or replacement of materials furnished that may develop such defects, will be warranted for a period of one year from the date of shipment.

Items not manufactured by Mortech Manufacturing will receive the manufacturer's warranty.

## PARTS AND SERVICE

Customer relations and product support are important aspects of Mortech Manufacturing. For assistance with this or any of our fine products please contact us below:

Mortech Manufacturing Company  
411 North Aerojet Avenue  
Azusa, CA 91702  
TEL (626) 334-1471  
FAX (626) 334-1704  
www.mortechmfg.com  
info@mortechmfg.com

© COPYRIGHT MORTECH MANUFACTURING INC., ALL RIGHTS RESERVED.

## DISCLAIMER

This manual contains general instructions for the use, operation, and care of this product. The instructions are not all inclusive. Safe and proper use of this product is solely at the discretion of the user. Safety information is included as a service to the user. All other safety measures taken by the user should be within and under consideration of applicable regulations. It is recommended that training on the proper use of this product be provided before using this product in and actual situation.

Retain this manual for future reference. Include it with the product in the event of transfer to new users. Additional free copies are available upon request from Customer Relations.

## PROPRIETARY NOTICE

The information in this manual is the property of Mortech Manufacturing. Mortech Manufacturing reserves all patent rights, proprietary design rights, manufacturing rights, reproductions rights, and sales use rights thereto, and to any article disclosed therein except to the extent those rights are expressly granted to others or where not applicable to vendor proprietary parts.

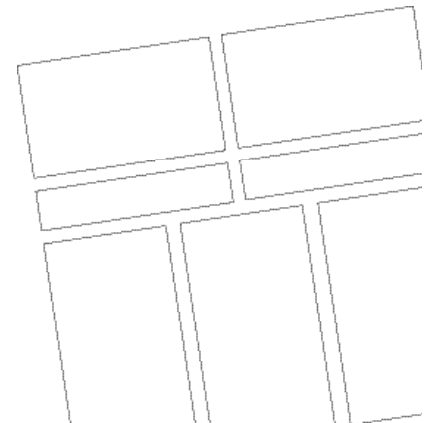

## CAUTION

- Inspect unit and all components for any loosening that may have occurred during shipping •